



CHARLOTTE COUNTY

Subdivision of Burnt Store Lakes

Land Information Section

Vacant Residential
 Residential Development
 Preservation Lands

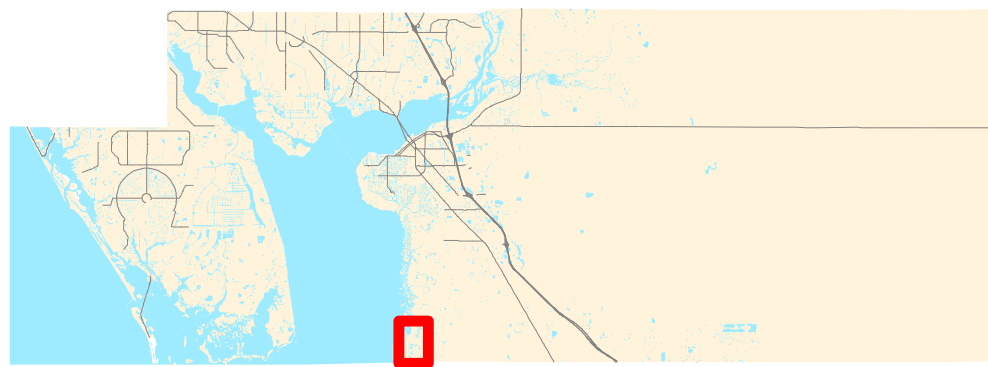

Stateplane Projection
 Datum: NAD83
 Units: Feet

Source: Community Development, Property Appraiser

Metadata available upon request

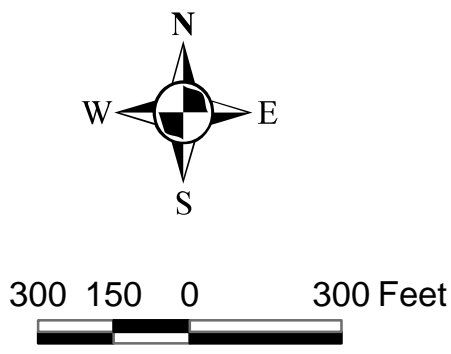
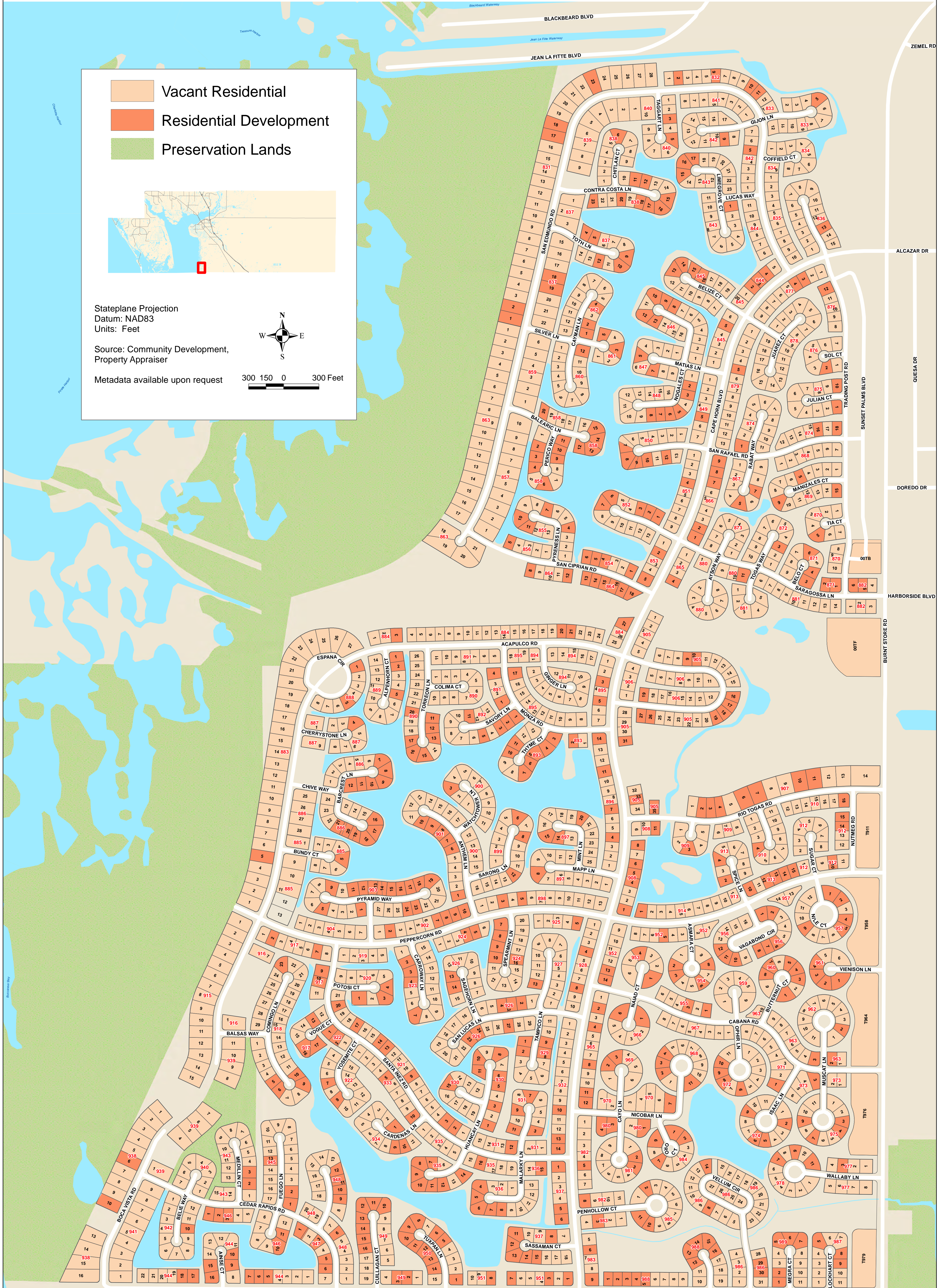
CHARLOTTE CO. BOUNDARY

This map is a representation of compiled public information. It is believed to be an accurate and true depiction for the stated purpose, but Charlotte County and its employees make no guarantees, implied or otherwise, to the accuracy, or completeness. We therefore do not accept any responsibilities as its user. This is not a survey or is to be used for design. Reflected Dimensions are for informational purposes only and may have been rounded to the nearest tenth. For precise dimensions, please refer to recorded plats and related documents.