

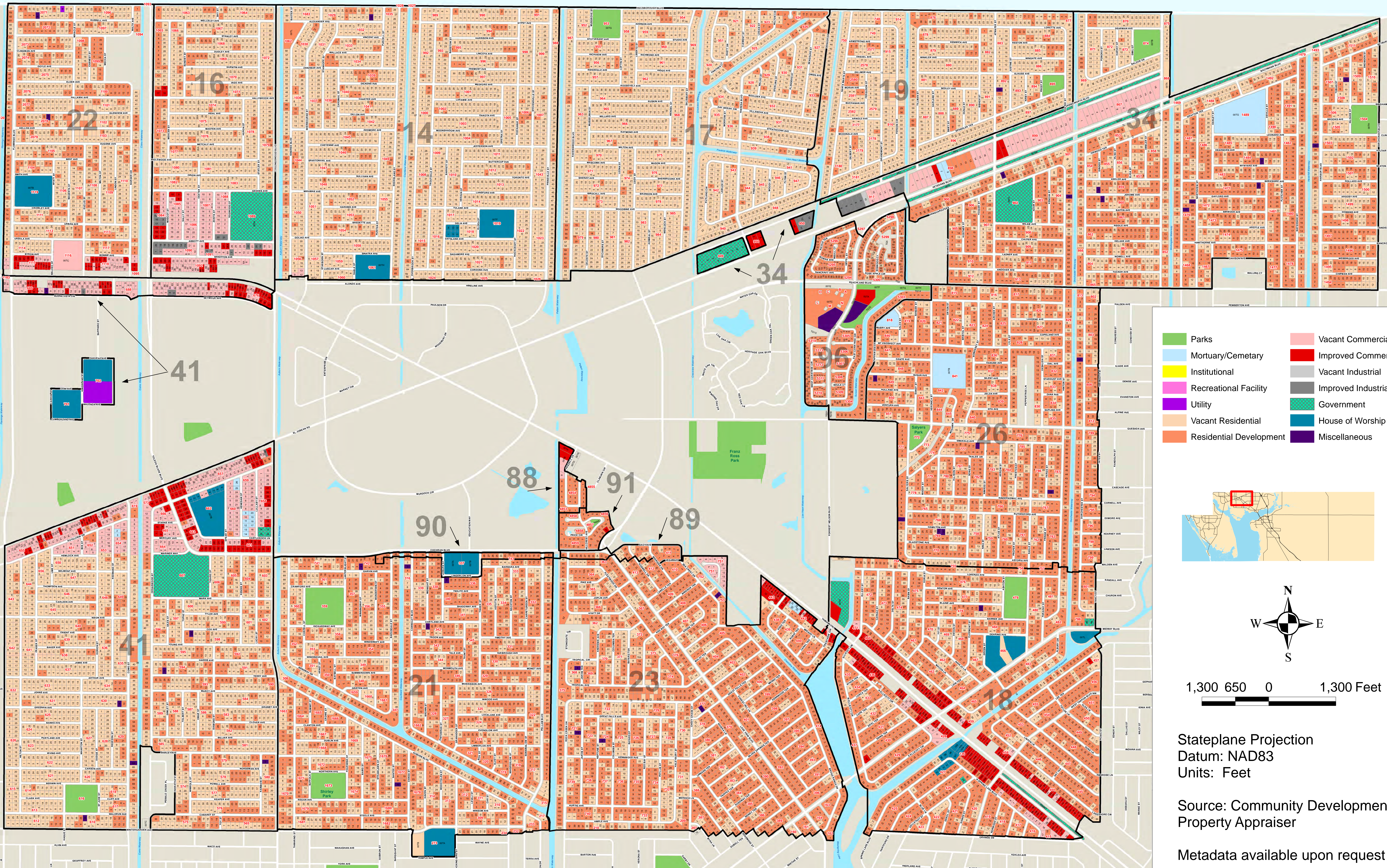

# CHARLOTTE COUNTY

## Port Charlotte Sections 14, 16-19, 21-23, 26, 34, 41, 88-91 and 96

Land Information  
Section



- Parks
- Mortuary/Cemetary
- Institutional
- Recreational Facility
- Utility
- Vacant Residential
- Residential Development
- Vacant Commercial
- Improved Commercial
- Vacant Industrial
- Improved Industrial
- Government
- House of Worship
- Miscellaneous

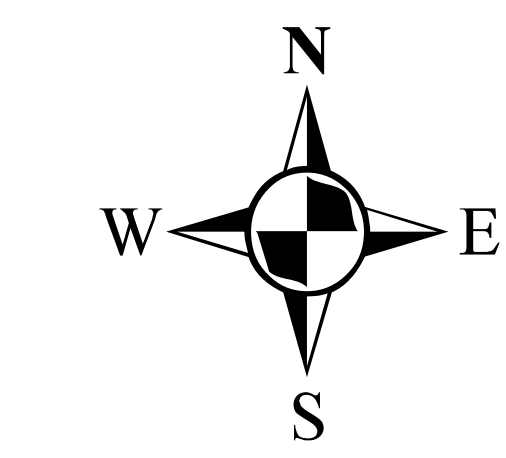
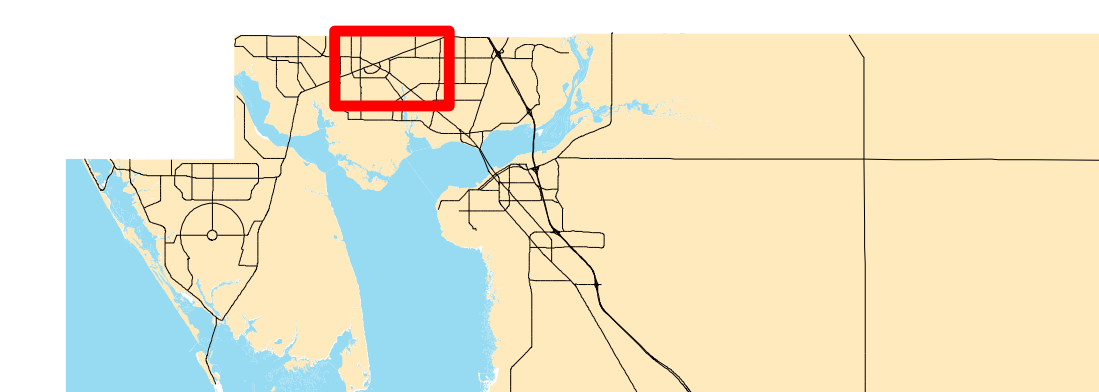

1,300 650 0 1,300 Feet

Stateplane Projection  
 Datum: NAD83  
 Units: Feet

Source: Community Development,  
 Property Appraiser

Metadata available upon request