

4021E05

DOC. #

056798

FLORIDA DEPARTMENT OF NATURAL RESOURCES
CERTIFIED CORNER RECORD

EOS

CORNER DESCRIPTION:

S.W. corner of Section 5,
Twp 40 S., Rge 21 E.,
Tallahassee Base Meridian,
CHARLOTTE County(s), Florida.

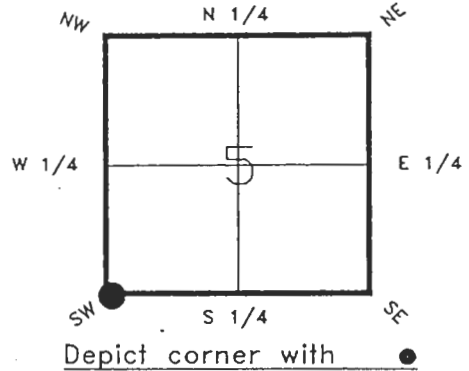

MONUMENTATION DESCRIPTION:

Describe original monument and accessories, or subsequent restoration. Give sources of information. (If no attempt was made to search for the original monument and accessories, this information is not necessary.)
NONE FOUND

Description of corner evidence found:

1" IRON PIPE
SET CHARLOTTE COUNTY MONUMENT & WELL
RESET DISK AND WELL 4/15/96 BY TIES
State method(s) to determine corner location (lost corners only):

HORIZONTAL POSITION INFORMATION (if determined):

Latitude 27°01'06.25716"N Longitude 82°14'16.91757"W
Y(Northing) 297465.537(M) X(Easting) 176379.291(M) Zone FL W
Convergence -0°06'29.279" Scale factor 0.99994806

Coordinate determination (circle one): Field traverse GPS

Horizontal datum (circle one): NAD27 NAD83(1986) NAD83(1990) other (explain)

Order of accuracy as defined in "Standards and Specifications for Geodetic Control Networks" published by the Federal Geodetic Control Committee (circle one):
1st, 2nd, 3rd, class 1, RESET BY TIES ACCURACY 3rd CL. 1 +/-
or Minimum Technical Standards (Chapter 21HH-6, F.A.C.) ratio of closure for field data (example 1:10,000), . This does not specify an order of accuracy.

Control point(s) used for survey:

Comments:

RECEIVED

JUL 9 1995

SURVEY & MAPPING

DNR 53-001(16)
REV: 7/16/92

056798

DOC. #

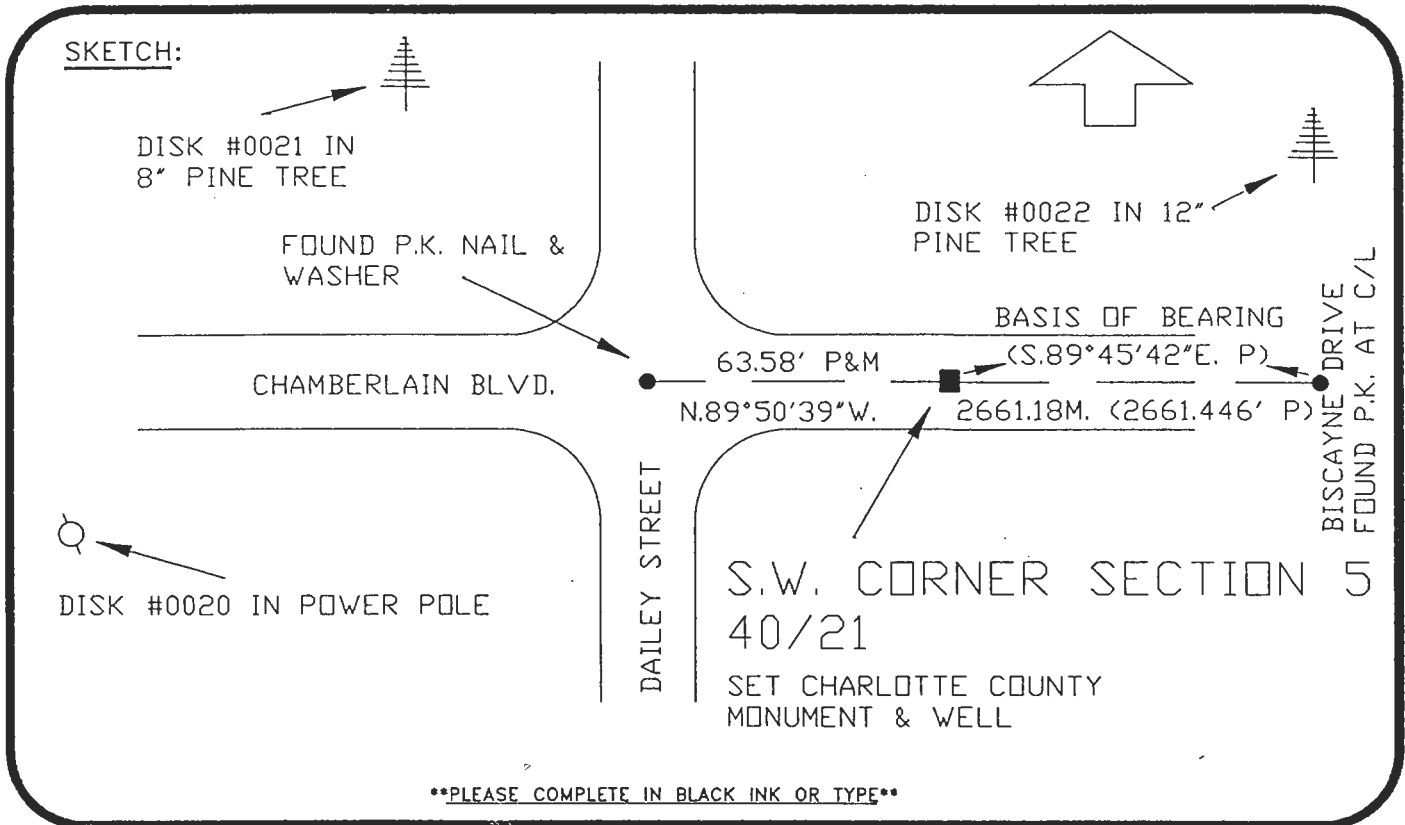

REFER: PORT CHARLOTTE SUBDIVISION, SECTION 38, PLAT BOOK 5 PAGE 42

All bearings and distances must be from the corner to the witness. Indicate whether corner was found, set, or replaced and show north arrow.

BASIS OF BEARING FROM SUBDIVISION PLAT REFER: F.B. 273-31

REFERENCE MEASUREMENTS (at least three vicinity references must be given below even if they appear on the above sketch):

Description	Bearing	Distance
DISK #0020 IN POWER POLE	S.79°53'51"W.	187.10'
DISK #0021 IN 8" PINE TREE	N.63°15'09"W.	128.44'
DISK #0022 IN 12" PINE TREE	N.60°19'08"E.	86.92'

SURVEYORS CERTIFICATE: I certify the monument and accessories indicated above were field located on APRIL 15, 19 96.

[Signature] PLS 4260
SIGNATURE

APRIL 18, 1996
DATE

CHARLOTTE COUNTY SURVEY DEPT.
FIRM OR AGENCY

7000 FLORIDA STREET
ADDRESS

PUNTA GORDA, FLA. 33950
CITY STATE

548

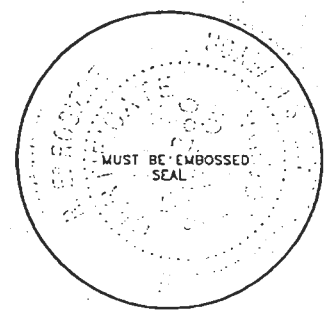

Completeness checked by: *[Signature]*

Accepted and filed: 8-1-96 Date

B.L.M. - I.D. 07060508 D.N.R. USE ONLY

SEND TO:
Department of Natural Resources
Bureau of Survey and Mapping
3900 Commonwealth Boulevard
Mall Station 105
Tallahassee, Florida 32399

DNR 53-001(16)
REV. 7/16/92
PAGE 2 OF 2