

0045924

FLORIDA DEPARTMENT OF NATURAL RESOURCES
CERTIFIED CORNER RECORD

A-21

CORNER DESCRIPTION:

N.W. corner of Section 1
Twp 40 S., Rge 22 E.
Tallahassee Base Meridian,

CHARLOTTE County(s), Florida.

SARASOTA

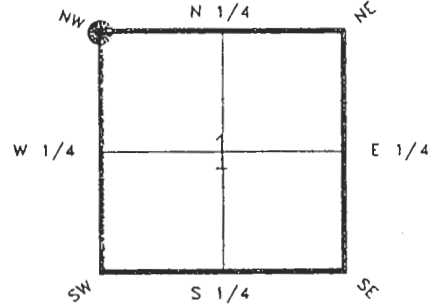

Depict corner with

MONUMENTATION DESCRIPTION:

Describe original monument and accessories, or subsequent restoration. Give sources of information. (If no attempt was made to search for the original monument and accessories, this information is not necessary.)

NONE FOUND

Description of corner evidence found:

P.K. NAIL & DISK (ON SURFACE ASPHALT)-(MONUMENT & MONUMENT WELL SET 7-13-92)

State method(s) to determine corner location (lost corners only):

HORIZONTAL POSITION INFORMATION (if determined):

Latitude 27°01'55.73643"N Longitude 82°04'26.16953"W

Y(Northing) 298968.225(M) X(Easting) 192664.011(M) Zone FL W

Convergence -0°02'00.972" Scale factor 0.99994184

Coordinate determination (circle one): Field traverse GPS

Horizontal datum (circle one): NAD27 NAD83(1986) NAD83(1990) other (explain)

Order of accuracy as defined in "Standards and Specifications for Geodetic Control Networks" published by the Federal Geodetic Control Committee (circle one): 1st, 2nd, 3rd, class 1

or Minimum Technical Standards (Chapter 21HH-6, F.A.C.) ratio of closure for field data (example 1:10,000), . This does not specify an order of accuracy.

Control point(s) used for survey:

Comments:

RECEIVED

AUG 02 1993

DNR 53-061(1)
REV: 7/16/92
PAGE 1 OF 2

SURVEY & MAPPING

0045921

DOC. #

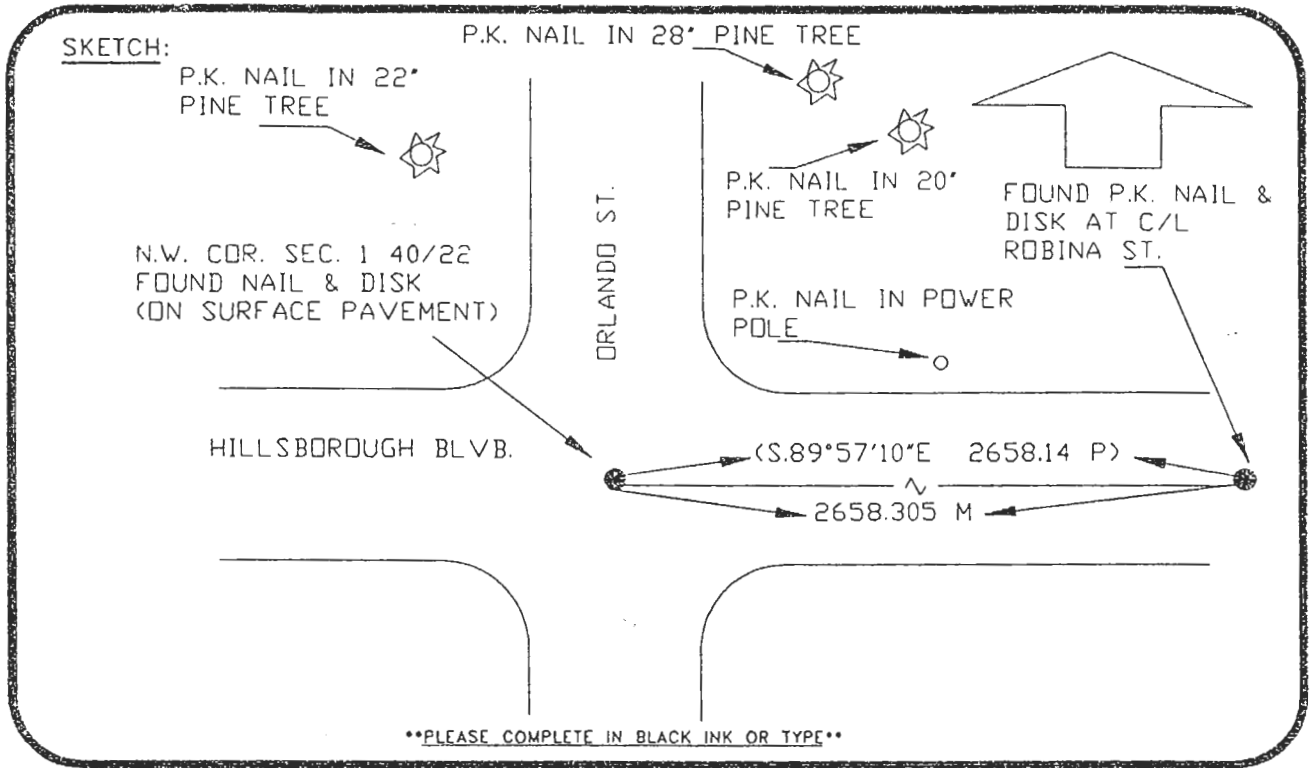

PLEASE COMPLETE IN BLACK INK OR TYPE

(BASIS OF BEARING FROM PLAT-REFER: PORT CHARLOTTE SUBD., SEC. 15, P.B. 5 PG. 4)
 All bearings and distances must be from the corner to the witness. Indicate whether corner was found, set, or replaced and show north arrow.

REFERENCE MEASUREMENTS (at least three vicinity references must be given below even if they appear on the above sketch):

Description	Bearing	Distance
P.K. NAIL IN POWER POLE	N.77°59'15"E.	165.19'
P.K. NAIL IN 20' PINE TREE	N.30°16'03"E.	330.38'
P.K. NAIL IN 28' PINE TREE	N.25°25'35"E.	330.35'
P.K. NAIL IN 22' PINE TREE	N.30°31'17"W.	258.69'

SURVEYORS CERTIFICATE: I certify the monument and accessories indicated above were field located on JUNE 11, 19 91.

[Signature] PLS 4260
 SIGNATURE

July 30, 1993
 DATE

CHARLOTTE COUNTY SURVEY DEPT.
 FIRM OR AGENCY

7000 FLORIDA STREET
 ADDRESS

PUNTA GORDA, FLA. 33950
 CITY STATE

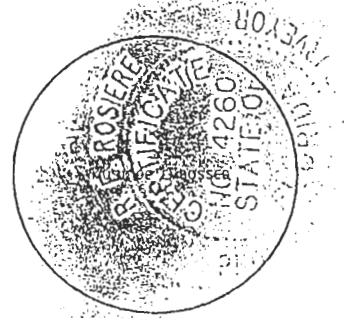

Completeness checked by: [Signature]
 Accepted and filed: 8-9-93 Date
 B.L.M. - I.D. 02000001 D.N.R. USE ONLY

SEND TO:
 Department of Natural Resources
 Bureau of Survey and Mapping
 3900 Commonwealth Boulevard
 Mail Station 105
 Tallahassee, Florida 32399

DNR 53-001(16)
 REV. 7/16/92
 PAGE 2 OF 2