

4022J17.DWG.

DOC. # ~~MM~~ 0045926

FLORIDA DEPARTMENT OF NATURAL RESOURCES  
CERTIFIED CORNER RECORD

J-17

CORNER DESCRIPTION:

S.E. corner of Section 10 ,  
Twp 40 S. , Rge 22 E. ,  
Tallahassee Base Meridian,  
CHARLOTTE County(s), Florida.

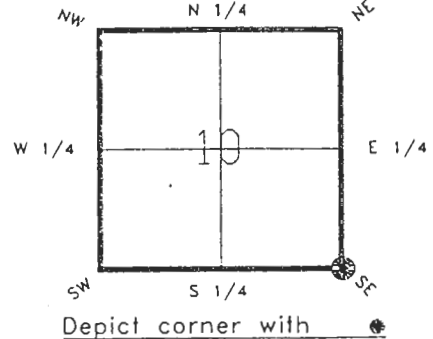

MONUMENTATION DESCRIPTION:

Describe original monument and accessories, or subsequent restoration. Give sources of information. (If no attempt was made to search for the original monument and accessories, this information is not necessary.)  
NONE FOUND

Description of corner evidence found:  
FOUND PINCH PIPE (0.1' BELOW PAVERMENT)

State method(s) to determine corner location (lost corners only):

HORIZONTAL POSITION INFORMATION ( if determined ):

Latitude 27°00'10.81194"N Longitude 82°05'25.84680"W  
Y(Northing) 295740.032(M) X(Easting) 191016.907(M) Zone FL W  
Convergence -0°02'27.947' Scale factor 0.99994217

Coordinate determination (circle one): Field traverse GPS  
Horizontal datum (circle one): NAD27 NAD83(1986) NAD83(1990) other (explain)

Order of accuracy as defined in "Standards and Specifications for Geodetic Control Networks" published by the Federal Geodetic Control Committee (circle one):  
1st 2nd, 3rd, class 1 ,

or Minimum Technical Standards (Chapter 21HH-6, F.A.C.) ratio of closure for field data (example 1:10,000), \_\_\_\_\_ . This does not specify an order of accuracy.

Control point(s) used for survey:

Comments:

0045926

DOC. #

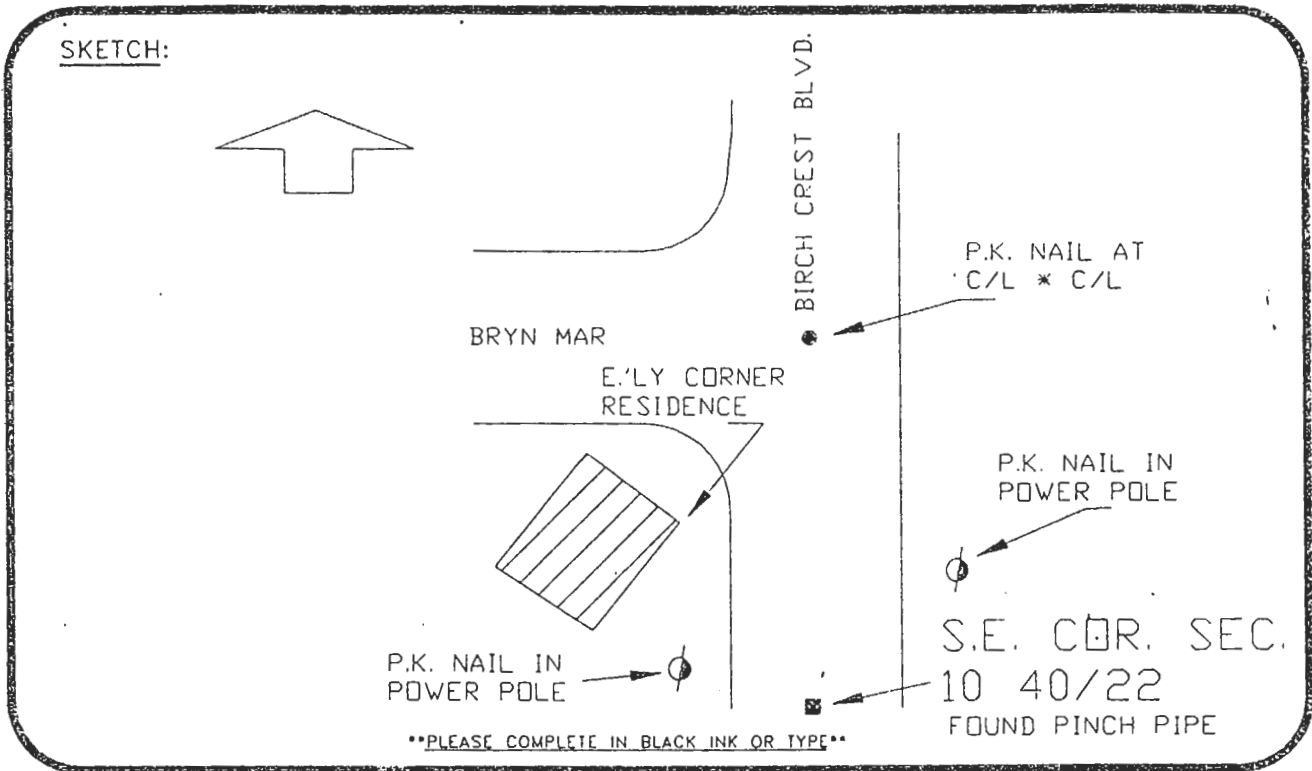

BASIS OF BEARING-SOLAR OBSERVATION

REFER: F.B. 265-24

All bearings and distances must be from the corner to the witness. Indicate whether corner was found, set, or replaced and show north arrow.

REFERENCE MEASUREMENTS ( at least three vicinity references must be given below even if they appear on the above sketch ):

| Description             | Bearing       | Distance         |
|-------------------------|---------------|------------------|
| E.'LY CORNER RESIDENCE  | N.45°49'00"W. | 99.06'           |
| P.K. NAIL IN POWER POLE | N.71°45'13"W. | 30.07'           |
| P.K. NAIL IN POWER POLE | N.47°26'20"E. | 39.07'           |
| P.K. NAIL @ C/L * C/L   | N.00°07'37"E. | 156.75 (156.71P) |

SURVEYORS CERTIFICATE: I certify the monument and accessories indicated above were field located on SEPTEMBER 24, 1991.

[Signature] PLS 4260  
 SIGNATURE  
July 22, 1993  
 DATE  
 CHARLOTTE COUNTY SURVEY DEPT.  
 FIRM OR AGENCY  
 7000 FLORIDA STREET  
 ADDRESS  
 PUNTA GORDA, FLA. 33950  
 CITY STATE

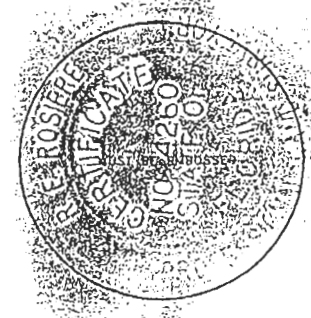

SEND TO:

Department of Natural Resources  
Bureau of Survey and Mapping  
3900 Commonwealth Boulevard  
Mail Station 105  
Tallahassee, Florida 32399

DNR 53-001(16)  
REV. 7/16/92  
PAGE 2 OF 2

Completeness checked by: GR Green  
 Accepted and filed: 8-93  
 Date  
 B.L.M. - I.D. 15101114 D.N.R. USE ONLY