

4022R13.DWG.

FLORIDA DEPARTMENT OF NATURAL RESOURCES  
CERTIFIED CORNER RECORD

R-13

CORNER DESCRIPTION:

S.E. corner of Section 21  
Twp 40 , Rge 22  
Tallahassee Base Meridian,  
CHARLOTTE County(s), Florida.

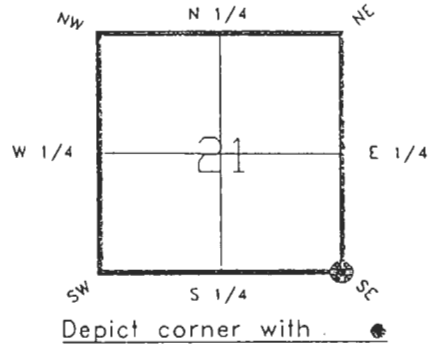

MONUMENTATION DESCRIPTION:

Describe original monument and accessories, or subsequent restoration. Give sources of information. (If no attempt was made to search for the original monument and accessories, this information is not necessary.)

Description of corner evidence found:  
IRON ROD (0.4' BELOW SURFACE)

State method(s) to determine corner location (lost corners only):

HORIZONTAL POSITION INFORMATION ( if determined ):

Latitude 26°58'23.47871"N Longitude 82°06'25.24793"W  
Y(Northing) 292437.927(M) X(Easting) 189376.509(M) Zone FL W  
Convergence -0°02'54.738" Scale factor 0.99994257

Coordinate determination (circle one): Field traverse  GPS   
Horizontal datum (circle one): NAD27 NAD83(1986)  NAD83(1990) other (explain)

Order of accuracy as defined in "Standards and Specifications for Geodetic Control Networks" published by the Federal Geodetic Control Committee (circle one):  
1st,  2nd,  3rd, class 1

or Minimum Technical Standards (Chapter 21HH-6, F.A.C.) ratio of closure for field data (example 1:10,000), \_\_\_\_\_ . This does not specify an order of accuracy.

Control point(s) used for survey:

Comments:

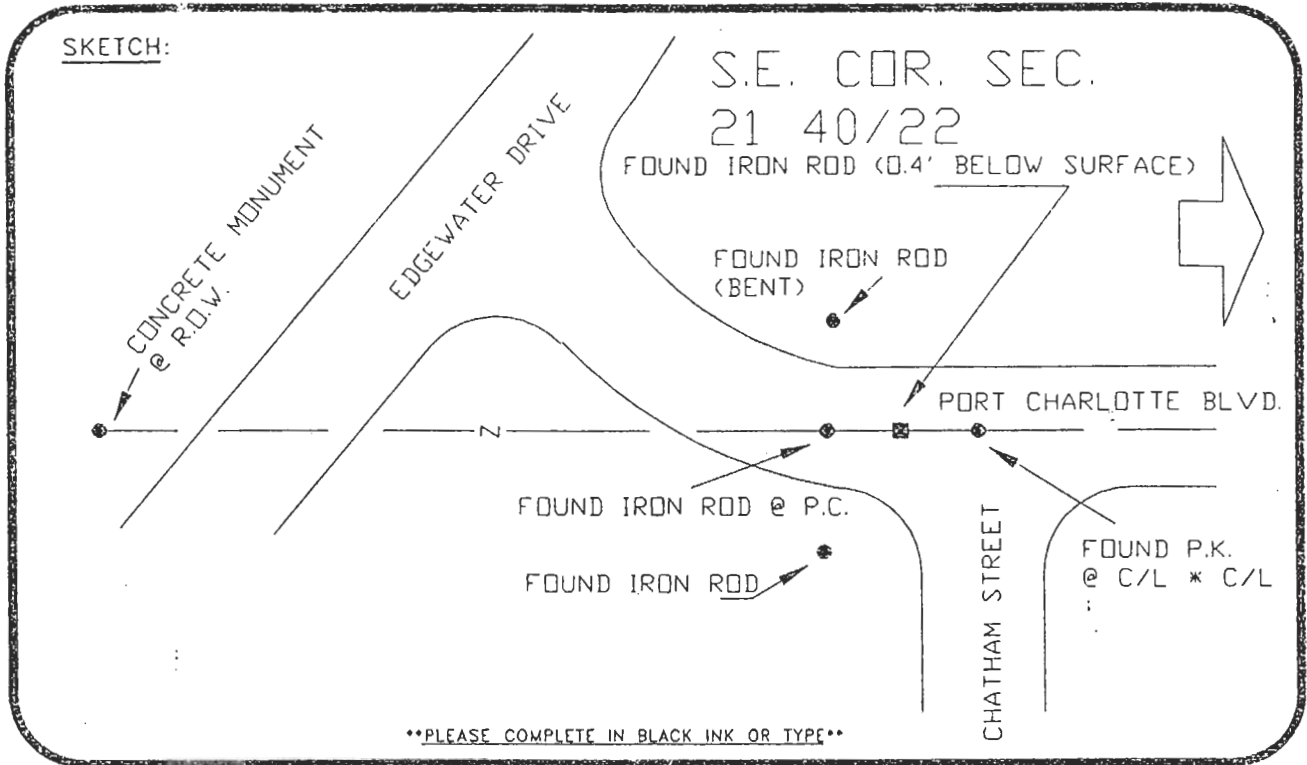

REFER: P.B. 6, PG. 21A&B BASIS OF BEARING-PLAT DATA REFER: F.B. 279-12  
 All bearings and distances must be from the corner to the witness. Indicate whether corner was found, set, or replaced and show north arrow.

REFERENCE MEASUREMENTS ( at least three vicinity references must be given below even if they appear on the above sketch ):

Description	Bearing	Distance
CONCRETE MONUMENT	SOUTH	546.01'
IRON ROD @ P.C.	SOUTH	68.84'
IRON ROD	S.26°59'45"E.	77.20'
IRON ROD (BENT)	S.27°04'45"W.	77.38'
P.K. NAIL @ C/L * C/L	N.00°00'15"E.	21.75'

SURVEYORS CERTIFICATE: I certify the monument and accessories indicated above were field located on JANUARY 27, 19 92.

[Signature] PLS 4260  
 SIGNATURE

July 22, 1993  
 DATE

CHARLOTTE COUNTY SURVEY DEPT.  
 FIRM OR AGENCY

7000 FLORIDA STREET  
 ADDRESS

PUNTA GORDA, FLA. 33950  
 CITY STATE



Completeness checked by: GRG/len  
 Accepted and filed: 8-93  
 B.L.M. - I.D. 28212221 Date 8-93  
 D.N.R. USE ONLY

SEND TO:  
 Department of Natural Resources  
 Bureau of Survey and Mapping  
 3900 Commonwealth Boulevard  
 Mail Station 105  
 Tallahassee, Florida 32399