

4023A05

DOC. # **0045143**

FLORIDA DEPARTMENT OF NATURAL RESOURCES  
CERTIFIED CORNER RECORD

CORNER DESCRIPTION:

N.E. corner of Section 6 ,  
Twp 40 S. , Rge 23 E. ,  
Tallahassee Base Meridian,  
CHARLOTTE County(s), Florida.  
DESDO

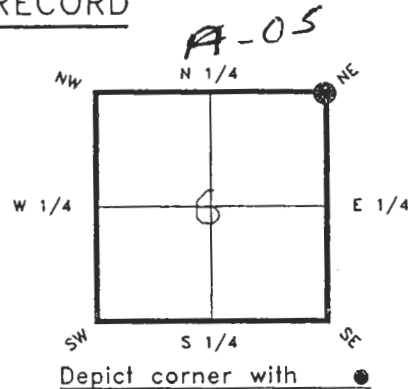

MONUMENTATION DESCRIPTION:

Describe original monument and accessories, or subsequent restoration. Give sources of information. (If no attempt was made to search for the original monument and accessories, this information is not necessary.)  
NONE FOUND

Description of corner evidence found:

CONCRETE MONUMENT WITH ALUMINUM DISK STAMPED WITH 31 | 39  
P.L.S. 2405 (0.3' BELOW SURFACE) 6 | 5

**RECEIVED**

MAR 25 1993

State method(s) to determine corner location (lost corners only)

**SURVEY & MAPPING**

HORIZONTAL POSITION INFORMATION ( if determined ):

Latitude 27°01'55.13358"N Longitude 82°02'28.15111"W  
Y(Northing) 298948.186(M) X(Easting) 195916.751(M) Zone FL W  
Convergence -0°01'07.333" Scale factor 0.99994138

Coordinate determination (circle one): Field traverse  **GPS**

Horizontal datum (circle one): NAD27 NAD83(1986) **NAD83(1990)** other (explain)

Order of accuracy as defined in "Standards and Specifications for Geodetic Control Networks" published by the Federal Geodetic Control Committee (circle one):

1st **2nd**, 3rd, class 1 ,

or Minimum Technical Standards (Chapter 21HH-6, F.A.C.) ratio of closure for field data (example 1:10,000), \_\_\_\_\_ . This does not specify an order of accuracy.

Control point(s) used for survey:

Comments:

**\*\*PLEASE SEND ORIGINAL ONLY\*\***  
**\*\*PLEASE COMPLETE IN BLACK INK OR TYPE\*\***

DNR 53-001(16)  
REV: 7/16/92  
PAGE 1 OF 2

DOC. #

0045143

SKETCH:

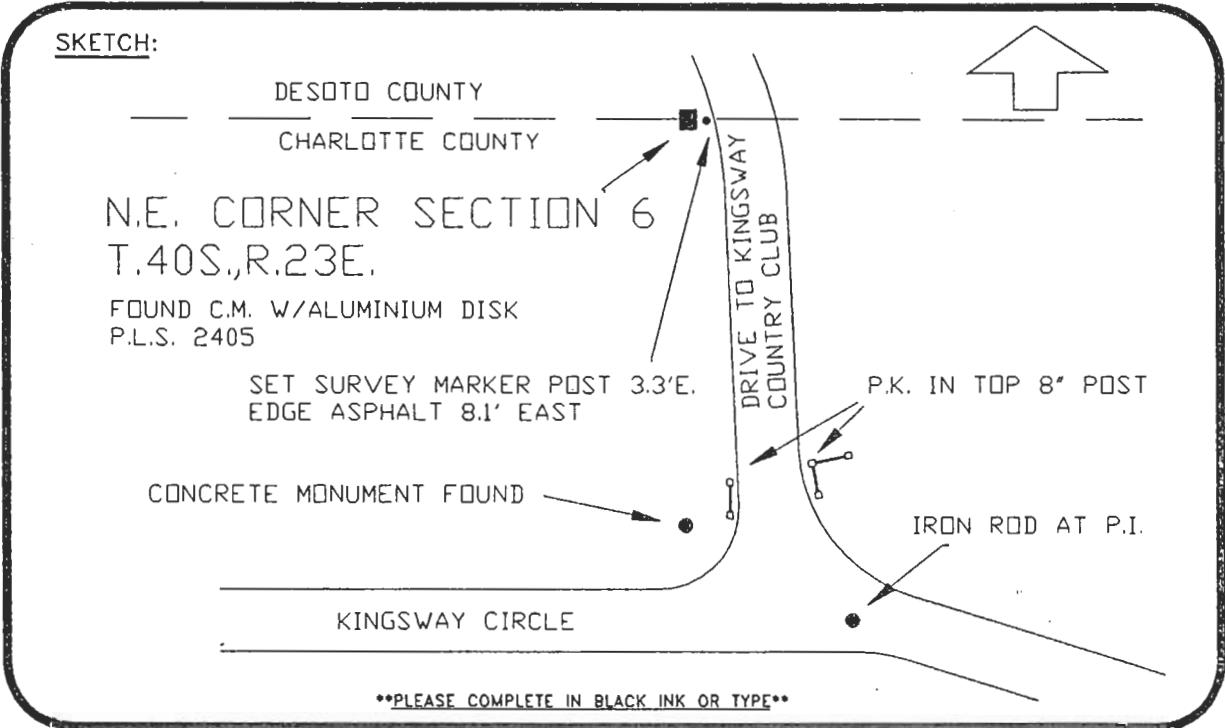

BASIS OF BEARING ASSUMED DATUM REFER:251-05  
All bearings and distances must be from the corner to the witness. Indicate whether corner was found, set, or replaced and show north arrow.

REFERENCE MEASUREMENTS ( at least three vicinity references must be given below even if they appear on the above sketch ):

Description	Bearing	Distance
CONCRETE MONUMENT FOUND	S.00°30'56"W.	130.00'
P.K. NAIL IN 8" POST (E. SIDE)	S.18°55'34"E.	116.56'
P.K. NAIL IN 8" POST (W. SIDE)	S.06°31'29"E.	116.89'
IRON ROD AT P.I.	S.18°15'31"E.	169.05'

SURVEYORS CERTIFICATE: I certify the monument and accessories indicated above were field located on JANUARY 10, 19 91.

*[Signature]* PLS 4260

3-23-92

CHARLOTTE COUNTY SURVEY DEPT.

7000 FLORIDA STREET

PUNTA GORDA, FLA. 33950

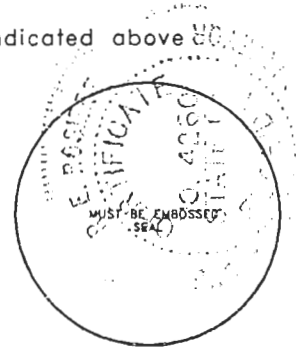

Completeness checked by: *[Signature]*  
Accepted and filed: *[Signature]* Date  
B.L.M. - I.D. 06213205 D.N.R. USE ONLY

SEND TO:  
Department of Natural Resources  
Bureau of Survey and Mapping  
3900 Commonwealth Boulevard  
Mail Station 105  
Tallahassee, Florida 32399  
DNR 53-001(16)  
REV. 7/16/92  
PAGE 2 OF 2