

FLORIDA DEPARTMENT OF NATURAL RESOURCES  
CERTIFIED CORNER RECORD

A 23

CORNER DESCRIPTION:

N. 1/4 corner of Section 1 ,  
Twp 40 S. , Rge 23 E. ,  
Tallahassee Base Meridian,  
CHARLOTTE County(s), Florida.

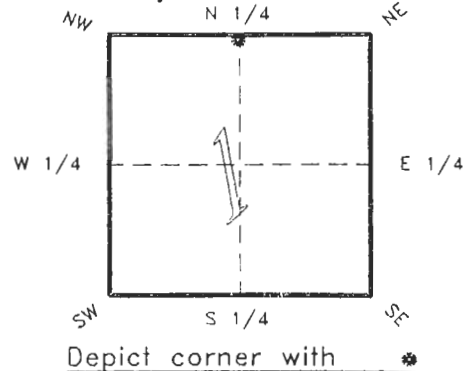

MONUMENTATION DESCRIPTION:

Describe original monument and accessories, or subsequent restoration. Give sources of information. (If no attempt was made to search for the original monument and accessories, this information is not necessary.)

Description of corner evidence found:

RAILROAD RAIL COUPLER, REPLACED WITH CONCRETE MONUMENT.

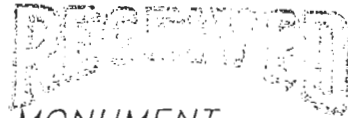

State method(s) to determine corner location (lost corners only):

SURVEY & MAPPING

HORIZONTAL POSITION INFORMATION ( if determined ):

Latitude 27°02'06.40440" N Longitude 81°58'00.52396" W  
Y(Northing) 299294.836 m X(Easting) 203292.833 m Zone FLW  
Convergence 0°00'54.306" Scale factor 0.99994131

Coordinate determination (circle one):

Field traverse GPS

Horizontal datum (circle one):

NAD27 NAD83(1986) NAD83(1990) other (explain)

Order of accuracy as defined in "Standards and Specifications for Geodetic Control Networks" published by the Federal Geodetic Control Committee (circle one):

1st, 2nd, 3rd, class 1

or Minimum Technical Standards (Chapter 21HH-6, F.A.C.) ratio of closure for field data (example 1:10,000), . This does not specify an order of accuracy.

Control point(s) used for survey: CHARLOTTE COUNTY HORIZONTAL CONTROL NETWORK INCLUDES HAVOLINE 2, PLACIDA 2, W260, PUNTAPORT, & FLGPS 58 AS B ORDER STATIONS.

Comments:

4023A23

DOC. #

0046798

SKETCH:

DISK 0475 IN 15" OAK TREE

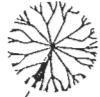

NOT TO SCALE

DESOTO COUNTY

CHARLOTTE COUNTY

N. 1/4 COR. SEC. 1 40/23

FOUND RAILROAD COUPLER REPLACED WITH CONC. MON.

GPS OBSERVED PK NAIL AT CL PT

DISK 0476 IN POWER POLE

BOYCE ROAD

BEARINGS BASED ON SOLAR OBSERVATION REFER FB 251/74

All bearings and distances must be from the corner to the witness. Indicate whether corner was found, set, or replaced and show north arrow.

SET SURVEY MARKER POST 3.0' N'LY

REFERENCE MEASUREMENTS ( at least three vicinity references must be given below even if they appear on the above sketch ):

Description	Bearing	Distance
DISK 0475 IN 15" OAK TREE	N 75°33'37" W	10.23'
DISK 0476 IN POWER POLE	S 02°18'40" W	130.37'
PK NAIL AT PT BOYCE ROAD	S 09°21'03" W	151.81'
	(S 09°20'09" W GRID)	

SURVEYORS CERTIFICATE: I certify the monument and accessories indicated above were field located on MARCH 11, 19 93.

SIGNATURE [Signature] PLS 4260

DATE 9-29-93

FIRM OR AGENCY CHARLOTTE COUNTY SURVEY DEPT.

ADDRESS 7000 FLORIDA STREET

CITY PUNTA GORDA, FLA. 33950

546



Completeness checked by: B. Hinton  
 Accepted and filed: 11-1-93 Date  
 B.L.M. - I.D. 01 CL 0036 D.N.R. USE ONLY

SEND TO:  
 Department of Natural Resources  
 Bureau of Survey and Mapping  
 3900 Commonwealth Boulevard  
 Mail Station 105  
 Tallahassee, Florida 32399

DNR 53-001(16)  
 REV. 7/16/92  
 PAGE 2 OF 2