

4023J13

DOC. #

**0045958**

FLORIDA DEPARTMENT OF NATURAL RESOURCES  
CERTIFIED CORNER RECORD

CORNER DESCRIPTION:

N.E. corner of Section 16 ,  
Twp 40 S. , Rge 23 E. ,  
Tallahassee Base Meridian,  
CHARLOTTE County(s), Florida.

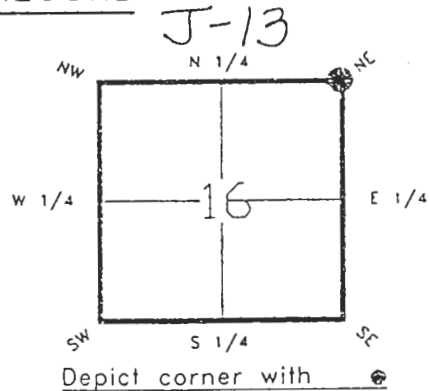

MONUMENTATION DESCRIPTION:

Describe original monument and accessories, or subsequent restoration. Give sources of information. (If no attempt was made to search for the original monument and accessories, this information is not necessary.)

NONE FOUND

Description of corner evidence found:

IRON ROD- REPLACED -WITH CHARLOTTE COUNTY SURVEY DEPARTMENT CONCRETE MONUMENT ON JAN. 8,1992

State method(s) to determine corner location (lost corners only):

HORIZONTAL POSITION INFORMATION ( if determined ):

Latitude 27°00'09.88564"N Longitude 82°00'29.34798"W  
Y(Northing) 295708.328(M) X(Easting) 199190.920(M) Zone FL W  
Convergence -0°00'13.325" Scale factor 0.99994118

Coordinate determination (circle one):

Field traverse

GPS

Horizontal datum (circle one): NAD27 NAD83(1986) NAD83(1990) other (explain)

Order of accuracy as defined in "Standards and Specifications for Geodetic Control Networks" published by the Federal Geodetic Control Committee (circle one):

1st, 2nd, 3rd, class 1 ,

or Minimum Technical Standards (Chapter 21HH-6, F.A.C.) ratio of closure for field data (example 1:10,000), \_\_\_\_\_ . This does not specify an order of accuracy.

Control point(s) used for survey:

Comments:

**RECEIVED**

JUL 26 1993

SURVEY & MAPPING

DNR 53-001(16)

REV. 7/16/92

PAGE

**\*\*PLEASE SEND ORIGINAL ONLY\*\***

**\*\*PLEASE COMPLETE IN BLACK INK OR TYPE\*\***

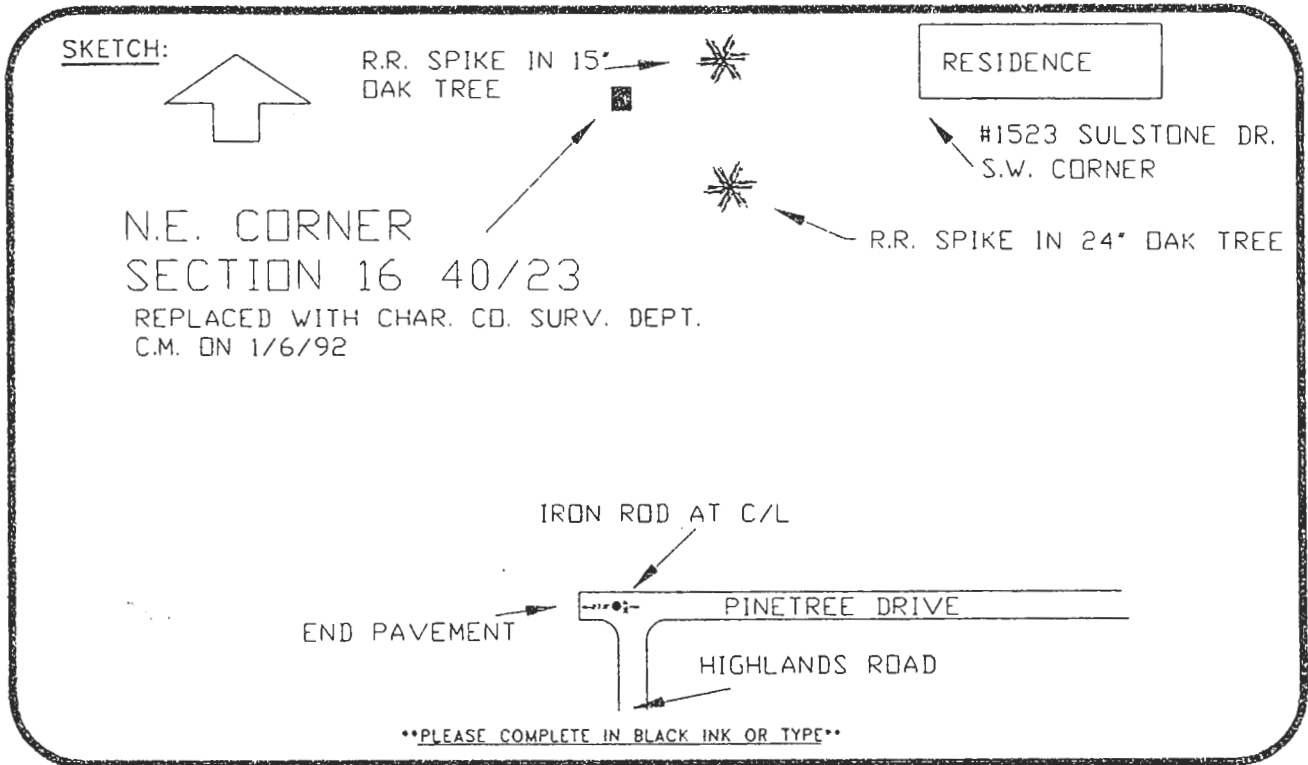

(P=REFER: HARBOR HEIGHTS SUBD., SECTION 10, PLAT BOOK 4 PAGE 42)  
 All bearings and distances must be from the corner to the witness. Indicate whether corner was found, set, or replaced and show north arrow.

SET SURVEY MARKER POST 3.0' S.W.'LY REFER: 276-33  
REFERENCE MEASUREMENTS (at least three vicinity references must be given below even if they appear on the above sketch):

Description	Bearing	Distance
RAILROAD SPIKE IN 15' OAK TREE	N.68°20'05"E.	67.85'
S.W. CORNER RESIDENCE #1523	S.89°30'40"E.	211.08'
RAILROAD SPIKE IN 24' OAK TREE	S.52°47'00"E.	102.25'
IRON ROD C/L PINETREE DRIVE	S.00°54'19"W.	361.95' (361.81'P)

SURVEYORS CERTIFICATE: I certify the monument and accessories indicated above were field located on DECEMBER 18, 1991.

[Signature] PLS 4260  
 SIGNATURE  
July 12, 1993  
 DATE  
 CHARLOTTE COUNTY SURVEY DEPT.  
 FIRM OR AGENCY  
 7000 FLORIDA STREET  
 ADDRESS  
 PUNTA GORDA, FLA. 33950  
 CITY STATE

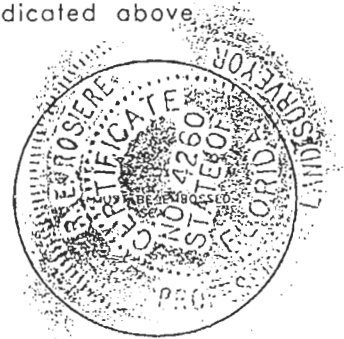

SEND TO:

Department of Natural Resources  
 Bureau of Survey and Mapping  
 3900 Commonwealth Boulevard  
 Mail Station 105  
 Tallahassee, Florida 32399

DNR 53-001(16)  
 REV. 7/16/92  
 PAGE 2 OF 2

Completeness checked by: GRAYLEN  
 Accepted and filed: 8-93  
 B.L.M. - I.D. 16091015 Date  
 D.N.R. USE ONLY