

4023N13

DOC. #

0045962

FLORIDA DEPARTMENT OF NATURAL RESOURCES  
CERTIFIED CORNER RECORD

N-13

CORNER DESCRIPTION:

N.E. corner of Section 21,  
Twp 40 S., Rge 23 E.,  
Tallahassee Base Meridian,  
CHARLOTTE County(s), Florida.

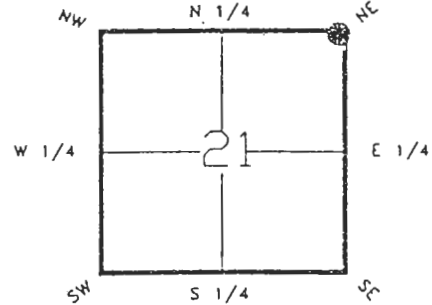

MONUMENTATION DESCRIPTION:

Describe original monument and accessories, or subsequent restoration. Give sources of information. (If no attempt was made to search for the original monument and accessories, this information is not necessary.)

NONE FOUND

Description of corner evidence found:

IRON BAR. REPLACED WITH CHARLOTTE COUNTY SURVEY DEPARTMENT CONCRETE MONUMENT ON 1/09/92

State method(s) to determine corner location (lost corners only):

HORIZONTAL POSITION INFORMATION ( if determined ):

Latitude 26°59'17.47321"N Longitude 82°00'30.29188"W  
Y(Northing) 294095.236(M) X(Easting) 199165.066(M) Zone FL W  
Convergence -0°00'13.742" Scale factor 0.99994119

Coordinate determination (circle one): Field traverse GPS  
Horizontal datum (circle one): NAD27 NAD83(1986) NAD83(1990) other (explain)

Order of accuracy as defined in "Standards and Specifications for Geodetic Control Networks" published by the Federal Geodetic Control Committee (circle one):  
1st, 2nd, 3rd, class 1

or Minimum Technical Standards (Chapter 21HH-6, F.A.C.) ratio of closure for field data (example 1:10,000), \_\_\_\_\_ . This does not specify an order of accuracy.

Control point(s) used for survey:

Comments:

\*\*PLEASE SEND ORIGINAL ONLY\*\*  
\*\*PLEASE COMPLETE IN BLACK INK OR TYPE\*\*

RECEIVED

JUL 26 1993  
DNR 53-001(16)  
REV. 6/1993  
PAGE 1 OF 2

SURVEY & MAPPING

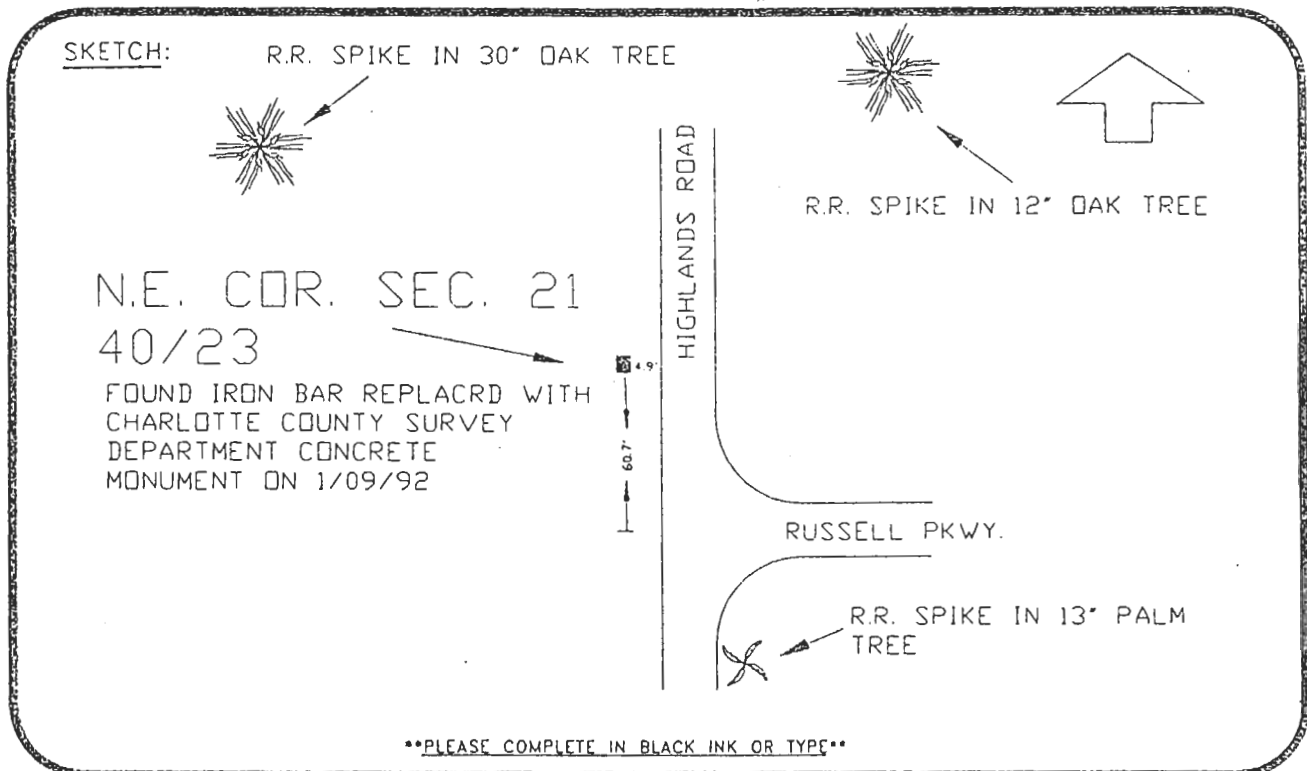

BASIS OF BEARING-SOLAR OBSERVATION REFER: F.B. 276-18

All bearings and distances must be from the corner to the witness. Indicate whether corner was found, set, or replaced and show north arrow.

REFERENCE MEASUREMENTS ( at least three vicinity references must be given below even if they appear on the above sketch ):

Description	Bearing	Distance
RAILROAD SPIKE IN 30" OAK TREE	N.57°48'57"W.	154.61'
RAILROAD SPIKE IN 12" OAK TREE	N.43°15'47"E.	145.53'
RAILROAD SPIKE IN 13" PALM TREE	S.20°52'19"E.	113.71'
SET SURVEY MARKER POST	W.L.Y	3.0'

SURVEYORS CERTIFICATE: I certify the monument and accessories indicated above were field located on DECEMBER 9, 19 91.

[Signature] PLS 4260  
SIGNATURE  
July 12, 1993  
DATE  
CHARLOTTE COUNTY SURVEY DEPT.  
FIRM OR AGENCY  
7000 FLORIDA STREET  
ADDRESS  
PUNTA GORDA, FLA. 33950  
CITY STATE



Completeness checked by: G.R. Green  
Accepted and filed: 8-93  
Date  
B.L.M. - I.D. 21161522 O.N.R. USE ONLY

SEND TO:  
Department of Natural Resources  
Bureau of Survey and Mapping  
3900 Commonwealth Boulevard  
Mail Station 105  
Tallahassee, Florida 32399  
DNR 53-001(16)  
REV. 7/16/92  
PAGE 2 OF 2