

4023N19

FLORIDA DEPARTMENT OF ENVIRONMENTAL PROTECTION
CERTIFIED CORNER RECORD

CORNER DESCRIPTION:

MEANDER CORNER SECTION 14 ,
Twp 40 S. , Rge 23 E. ,
Tallahassee Base Meridian,
CHARLOTTE County(s), Florida.

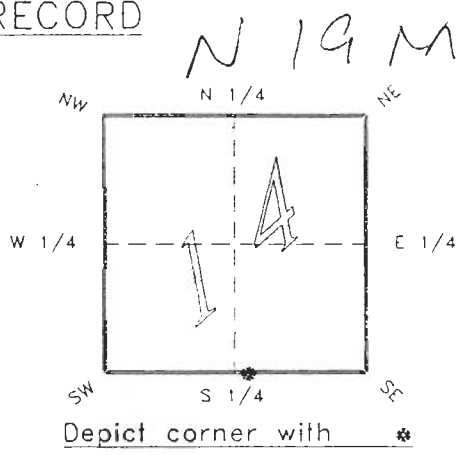

MONUMENTATION DESCRIPTION:

Describe original monument and accessories, or subsequent restoration. Give sources of information. (If no attempt was made to search for the original monument and accessories, this information is not necessary.)

Description of corner evidence found:
1 1/2 " IRON PIPE WITH 1 1/2" IRON PIPE ADJACENT.
REPLACED WITH CONCRETE MONUMENT.

State method(s) to determine corner location (lost corners only):

HORIZONTAL POSITION INFORMATION (if determined):

Latitude 26°59'31.37439 N Longitude 81°58'56.75280 W
Y(Northing) 294523.165 m X(Easting) 201743.796 m Zone FLW
Convergence 0°00'28.706" Scale factor 0.99994121

Coordinate determination (circle one): Field traverse GPS
Horizontal datum (circle one): NAD27 NAD83(1986) NAD83(1990) other (explain)

Order of accuracy as defined in "Standards and Specifications for Geodetic Control Networks" published by the Federal Geodetic Control Committee (circle one):
1st, 2nd, 3rd, class 1 ,

or Minimum Technical Standards (Chapter 21HH-6, F.A.C.) ratio of closure for field data (example 1:10,000), _____ . This does not specify an order of accuracy.

Control point(s) used for survey: CHARLOTTE COUNTY HORIZONTAL CONTROL NETWORK INCLUDES HAVOLINE 2, PLACIDA 2, W260, PUNTAPOINT, & FLGPS 5B AS B ORDER STATIONS.

Comments:

REFER TO ANDREW DUFFY SURVEY RECORDED IN PLAT BOOK 2 PAGE 35 C.C.P.R.

0047008

4023N19

DOC. #

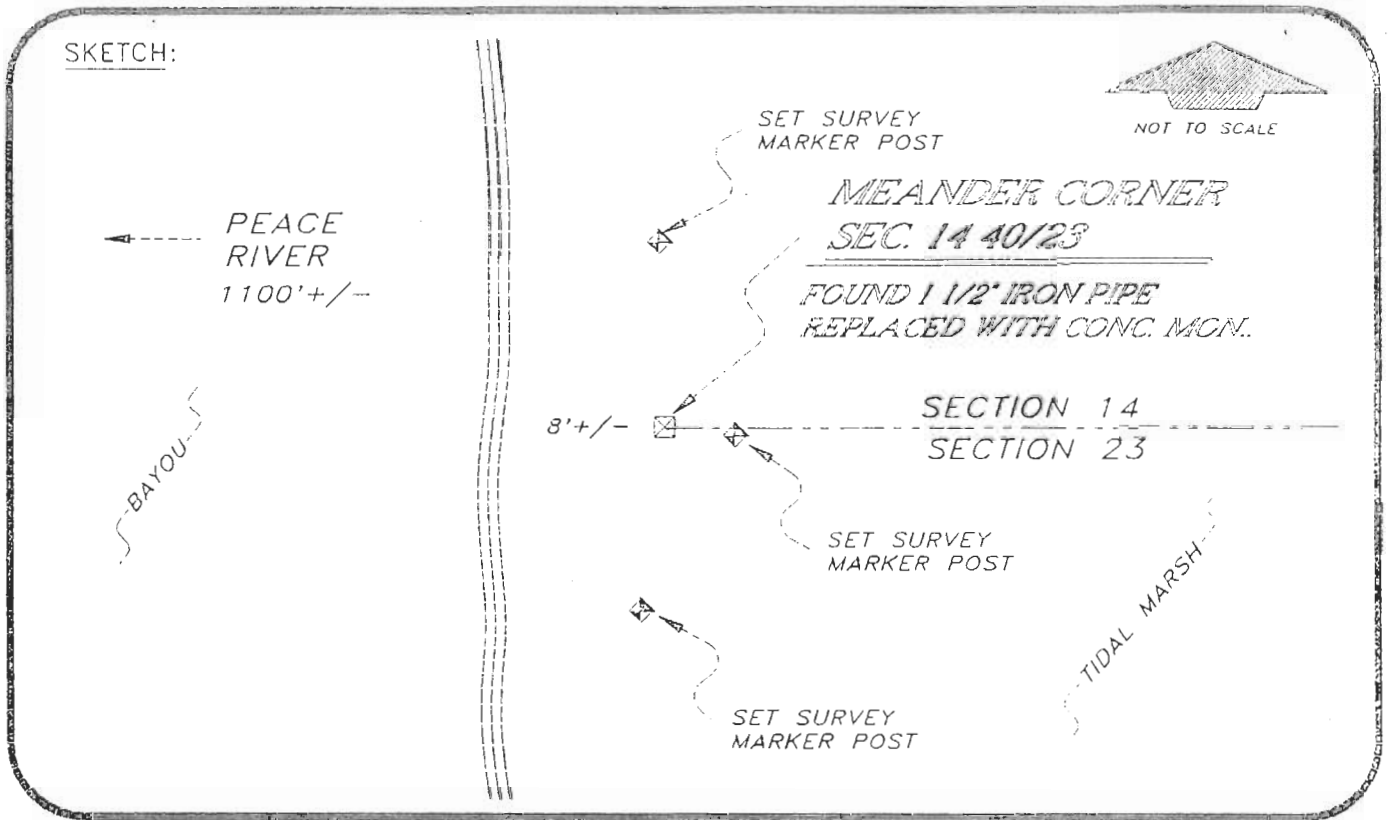

BEARINGS BASED ON MAGNETIC COMPASS

REFER FB 252/54

REFERENCE MEASUREMENTS

Description	Bearing	Distance
SET SURVEY MARKER POST	N 88° E	3.2'
SET SURVEY MARKER POST	S 10° W	13.1'
SET SURVEY MARKER POST	NORTH	12.2'

SURVEYORS CERTIFICATE: I certify the monument and accessories indicated above were field located on MAY 10, 19 91.

[Signature] PLS 4260
SIGNATURE

10-20-93
DATE

CHARLOTTE COUNTY SURVEY DEPT.
FIRM OR AGENCY

7000 FLORIDA STREET
ADDRESS

PUNTA GORDA, FLA. 33950
CITY STATE

508

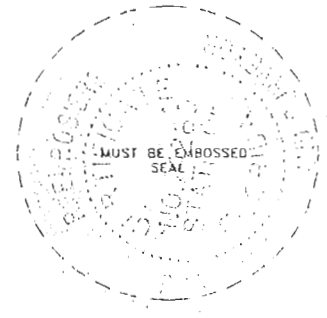

Completeness checked by: B. Binton
 Accepted and filed: 12-1-93
 B.L.M. - I.D. 14 PAC 235LE014 D.N.R. USE ONLY

SEND TO:
Department of Environmental Protection
Bureau of Survey and Mapping
3900 Commonwealth Boulevard
Mail Station 105
Tallahassee, Florida 32399