

4023P25

FLORIDA DEPARTMENT OF ENVIRONMENTAL PROTECTION  
CERTIFIED CORNER RECORD

CORNER DESCRIPTION:

E 1/4 corner of Section 24 ,  
Twp 40 S. , Rge 23 E. ,  
Tallahassee Base Meridian,  
CHARLOTTE County(s), Florida.

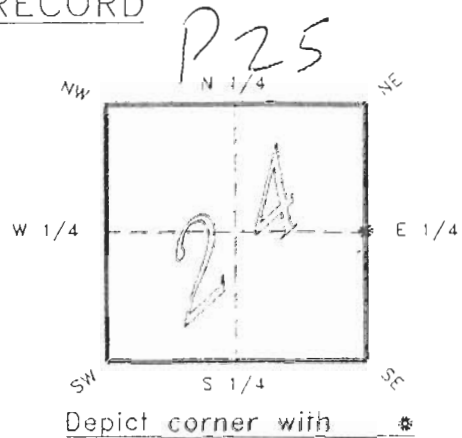

MONUMENTATION DESCRIPTION:

Describe original monument and accessories, or subsequent restoration. Give sources of information. (If no attempt was made to search for the original monument and accessories, this information is not necessary.)

Description of corner evidence found:

PK NAIL & DISK LB 3943

State method(s) to determine corner location (lost corners only):

HORIZONTAL POSITION INFORMATION ( if determined ):

Latitude 26°59'01.54326"N Longitude 81°57'33.24432"W  
Y(Northing) 293605.587 m X(Easting) 204046.515 m Zone FLW  
Convergence 0°01'06.589" Scale factor 0.99994138

Coordinate determination (circle one): Field traverse GPS  
Horizontal datum (circle one): NAD27 NAD83(1986) NAD83(1990) other (explain)

Order of accuracy as defined in "Standards and Specifications for Geodetic Control Networks" published by the Federal Geodetic Control Committee (circle one):  
1st, 2nd, 3rd, class 1 ,

or Minimum Technical Standards (Chapter 21HH-6, F.A.C.) ratio of closure for field data (example 1:10,000), \_\_\_\_\_ . This does not specify an order of accuracy.

Control point(s) used for survey: CHARLOTTE COUNTY HORIZONTAL CONTROL NETWORK INCLUDES HAVOLINE 2, PLACIDA 2, W260, PUNTAPORT, & FLGPS 58 AS B ORDER STATIONS.

Comments:

4023P25

DOC. #

0047010

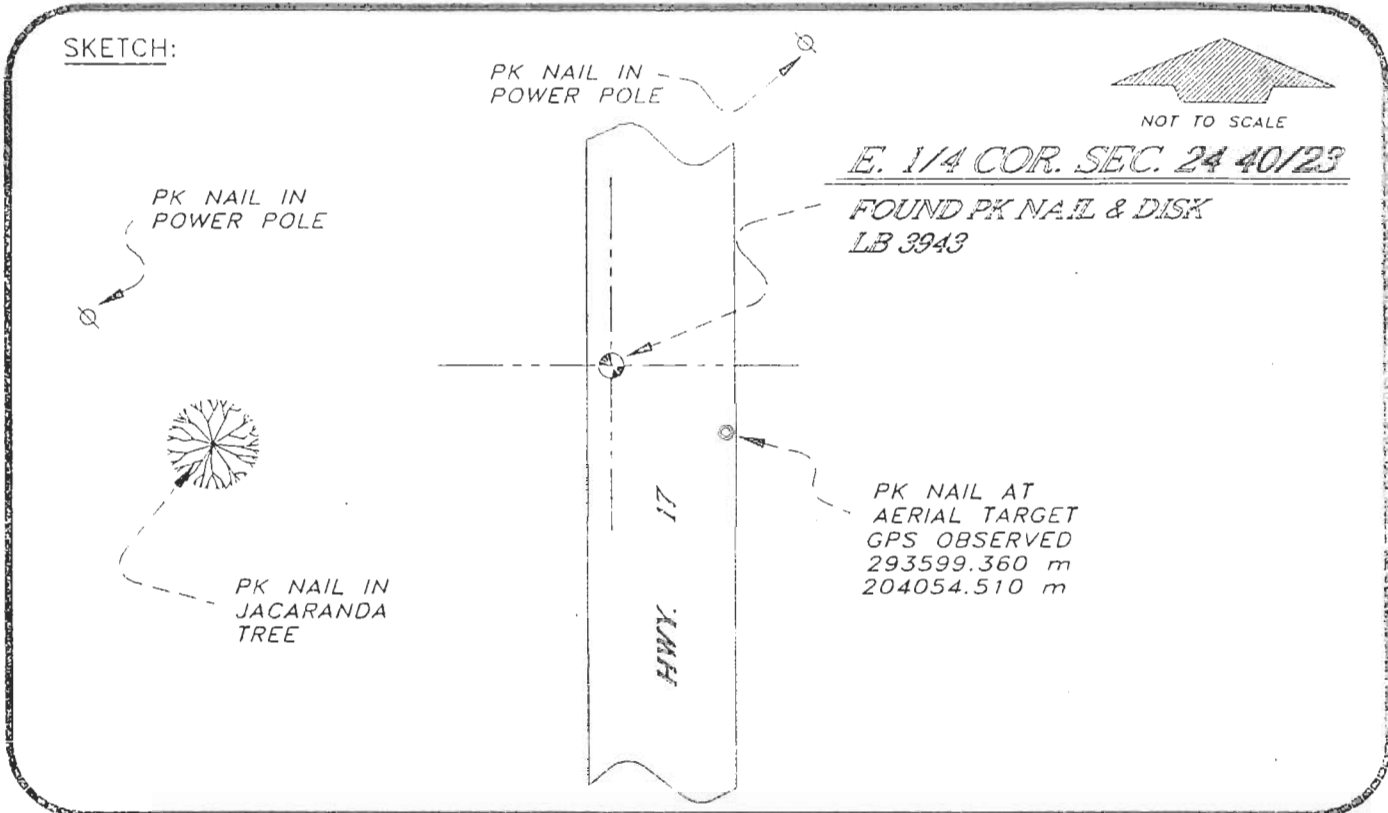

BASIS OF BEARING SOLAR OBSERVATION

REFER FB 251/26

REFERENCE MEASUREMENTS

Description	Bearing	Distance
PK NAIL IN JACARANDA TREE	S 81°31'52" W	168.35'
PK NAIL IN POWER POLE	N 87°52'29" W	202.00'
PK NAIL IN POWER POLE	N 23°27'00" E	212.29'
PK NAIL AT AERIAL TARGET	S 52°04'13" E	33.25'
	( S 52°05'20" E GRID )	

SURVEYORS CERTIFICATE: I certify the monument and accessories indicated above were field located on MARCH 15, 19 93.

[Signature] PLS 4260  
SIGNATURE

11-16-93  
DATE

CHARLOTTE COUNTY SURVEY DEPT.  
FIRM OR AGENCY

7000 FLORIDA STREET  
ADDRESS

PUNTA GORDA, FLA. 33950  
CITY STATE

508



Completeness checked by: B. Beinton  
 Accepted and filed: 12-1-93 Date  
 B.L.M. - I.D. 2400CL19 D.N.R. USE ONLY

SEND TO:  
Department of Environmental Protection  
Bureau of Survey and Mapping  
3900 Commonwealth Boulevard  
Mail Station 105  
Tallahassee, Florida 32399