

4024A13

FLORIDA DEPARTMENT OF ENVIRONMENTAL PROTECTION
CERTIFIED CORNER RECORD

CORNER DESCRIPTION:

N. W. corner of Section 3
Twp 40 S., Rge 24 E.
Tallahassee Base Meridian,

CHARLOTTE County(s), Florida.
DESOTO

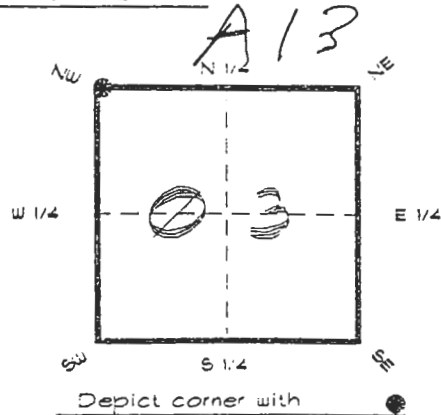

MONUMENTATION DESCRIPTION:

Describe original monument and accessories, or subsequent restoration. Give sources of information. (If no attempt was made to search for the original monument and accessories, this information is not necessary.)

Description of corner evidence found:

3"x3" CONCRETE MONUMENT

State method(s) to determine corner location (lost corners only):

HORIZONTAL POSITION INFORMATION (if determined):

Latitude 27°02'05.07489" N Longitude 81°54'26.73112" W
Y(Northing) 299256.857 m X(Easting) 209185.127 m Zone FLW
Convergence 0°02'31.481" Scale factor 0.99994222

Coordinate determination (circle one): Field traverse GPS

Horizontal datum (circle one): NAD27 NAD83(1986) NAD83(1990) other (explain)

Order of accuracy as defined in Standards and Specifications for Geodetic Control Networks published by the Federal Geodetic Control Committee (circle one):
1st, 2nd, 3rd, class 1

or Minimum Technical Standards (Chapter 61G17, F.A.C.) ratio of closure for field data (example 1:10,000), _____ This does not specify an order of accuracy.

Control point(s) used for survey: CHARLOTTE COUNTY HORIZONTAL CONTROL NETWORK INCLUDES HAYOLINE 2, FLACIDA 2, W260, PUNTPORT, 4 FLGPS 58 AS B ORDER STATIONS.

Comments:



FEB 20 1995

SURVEY & MAPPING

4024A13

DOC. #

051051

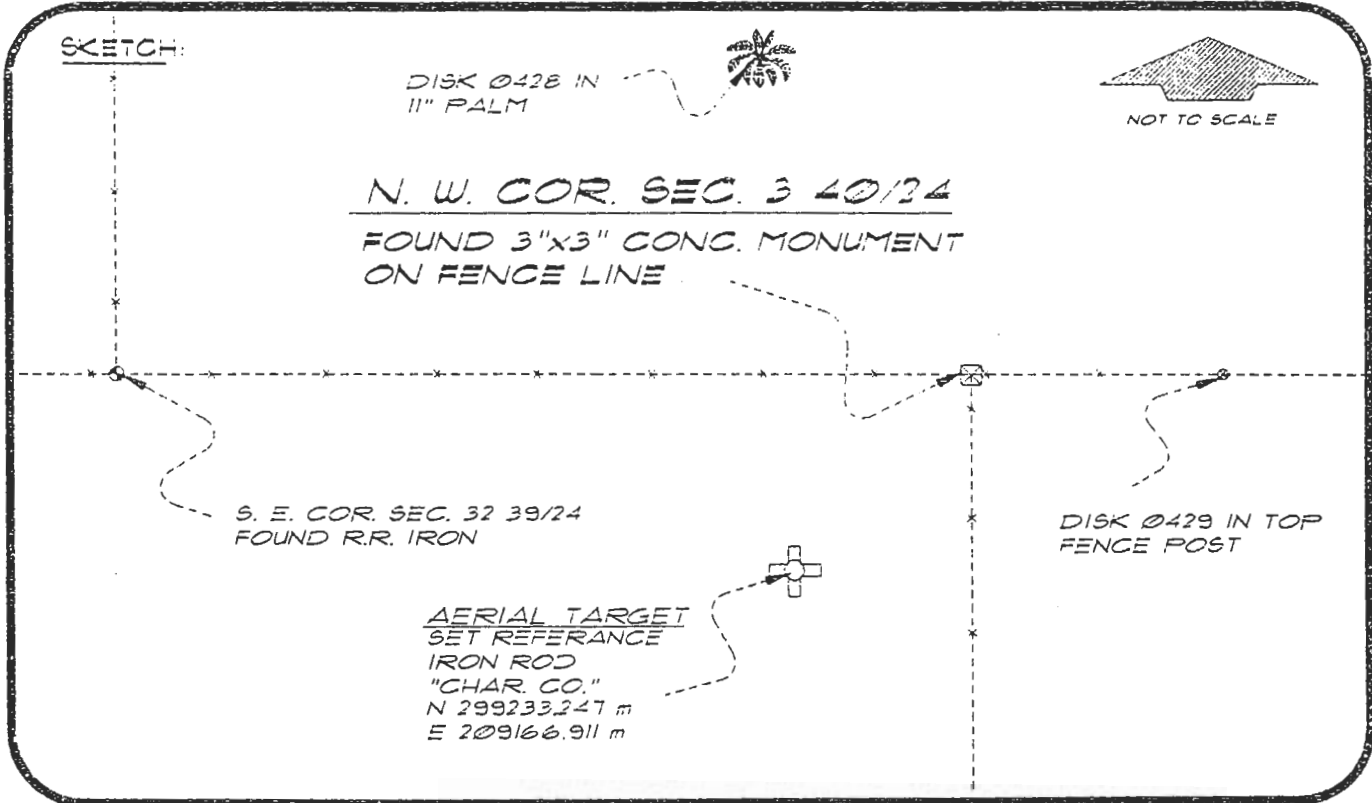

BASIS OF BEARING SOLAR OBSERVATION REFER: FB 304/61
SET SURVEY MARKER POST 0.5' S"LY

REFERENCE MEASUREMENTS

Description	Bearing	Distance
DISK 0428 IN 11" PALM	N 27°45'03" W	383.78'
DISK 0429 IN FENCE POST	S 29°49'12" E	114.53'
SET REF. IRON ROD	S 37°41'35" W	97.84'
S. E. COR. SEC. 32 39/40	N 89°42'05" W	760.39'

SURVEYORS CERTIFICATE: I certify the monument and accessories indicated above were field located on MARCH 29, 1994

R. P. ROSE PLS 4260
SIGNATURE

2-15-95
DATE

CHARLOTTE COUNTY SURVEY DEPT.
FIRM OR AGENCY

7000 FLORIDA STREET
ADDRESS

PUNTA GORDA, FLORIDA 33950
CITY STATE

UPDATED 2/7/95

546
FT. OGDEN



Completeness checked by: B. Bunt
Accepted and filed: 3-1-95
BLM. - ID. 04000003 Date
DEP USE ONLY

SEND TO:
Department of Environmental Protection
Bureau of Survey and Mapping
3900 Commonwealth Boulevard
Mail Station 105
Tallahassee, Florida 32399