

4024E13

DOC. #

051052

**FLORIDA DEPARTMENT OF ENVIRONMENTAL PROTECTION
CERTIFIED CORNER RECORD**

CORNER DESCRIPTION:

S. W. corner of Section 3

Twp 40 S., Rge 24 E.

Tallahassee Base Meridian,

CHARLOTTE County(s), Florida.

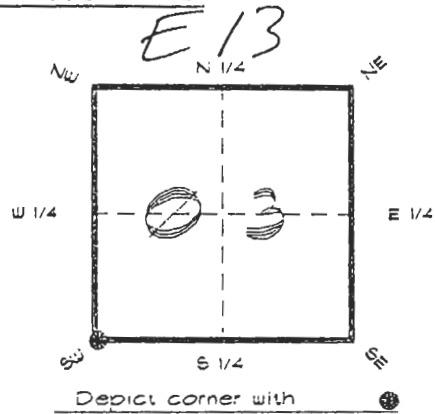

MONUMENTATION DESCRIPTION:

Describe original monument and accessories, or subsequent restoration. Give sources of information. (If no attempt was made to search for the original monument and accessories, this information is not necessary.)

Description of corner evidence found:

3"x3" CONCRETE MONUMENT UNDER FENCE

State method(s) to determine corner location (lost corners only):

HORIZONTAL POSITION INFORMATION (if determined):

Latitude 27°01'11.17298" N Longitude 81°54'27.42638" W

Y(Northing) 297597.899 m X(Easting) 209167.181 m Zone FLW

Convergence 0°02'31.088" Scale factor 0.99994221

Coordinate determination (circle one): Field traverse GPS

Horizontal datum (circle one): NAD27 NAD83(1986) NAD83(1990) other (explain)

Order of accuracy as defined in Standards and Specifications for Geodetic Control Networks published by the Federal Geodetic Control Committee (circle one):

1st, 2nd, 3rd, class 1

or Minimum Technical Standards (Chapter 6G17, F.A.C.) ratio of closure for field data (example 1:10,000), _____ . This does not specify an order of accuracy.

Control point(s) used for survey: CHARLOTTE COUNTY HORIZONTAL CONTROL NETWORK INCLUDES HAYOLINE 2, FLACIDA 2, W160 PUNTPORT, 4 FLGPS 58 45 B ORDER STATIONS.

Comments:



FEB 20 1995

SURVEY & MAPPING

4024E13

DOC. #

051052

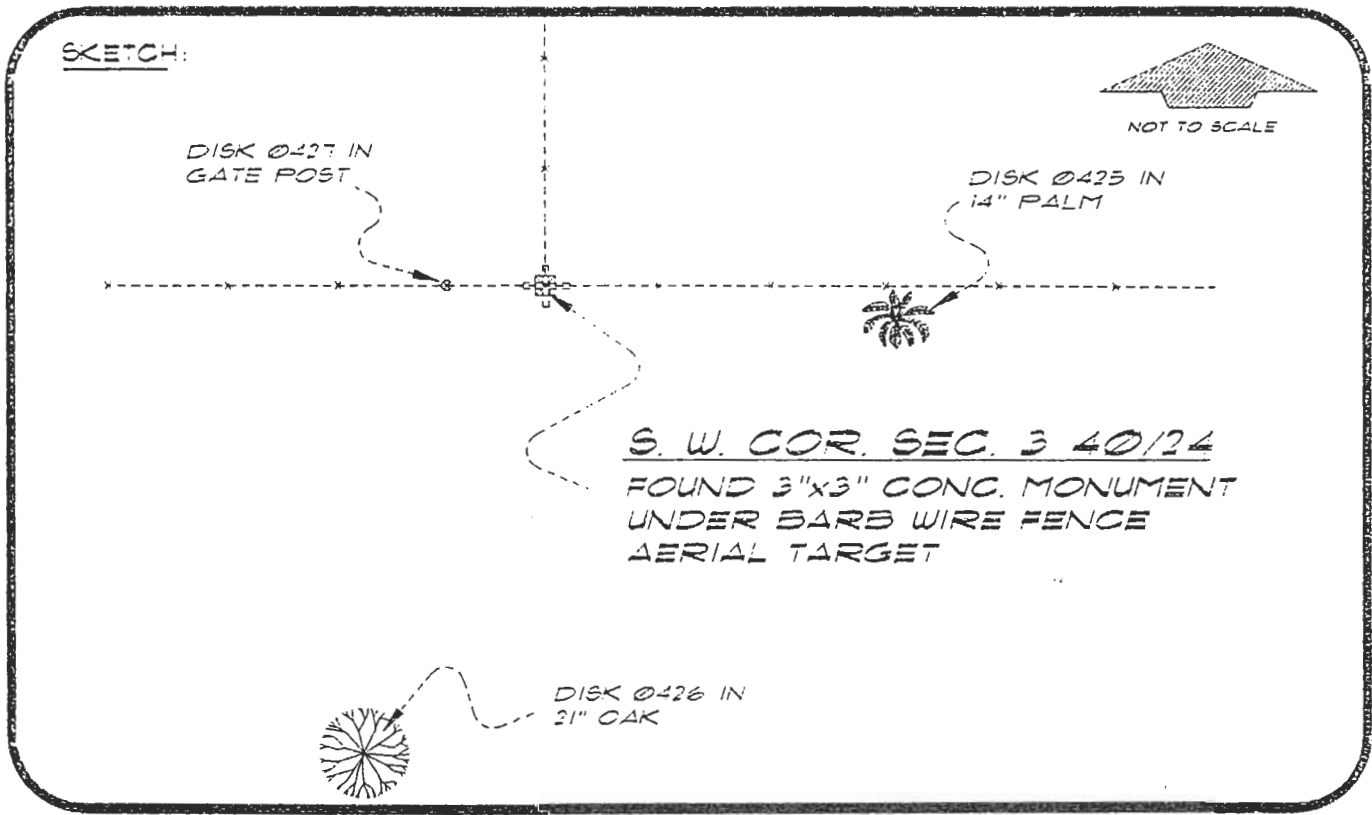

BASIS OF BEARING SOLAR OBSERVATION
SET SURVEY MARKER POST 3.0' N'LY

REFER: FB 304160

REFERENCE MEASUREMENTS

<u>Description</u>	<u>Bearing</u>	<u>Distance</u>
DISK Ø427 IN GATE POST	N 87°34'56" W	20.49'
DISK Ø425 IN 14" PALM	S 87°49'36" E	108.47'
DISK Ø426 IN 21" OAK.	S 12°38'39" W	232.25'

SURVEYORS CERTIFICATE: I certify the monument and accessories indicated above were field located on MARCH 29, 1994

R. P. Rose
SIGNATURE

PLS 4260

UPDATED 2/7/95

2-15-95
DATE

CHARLOTTE COUNTY SURVEY DEPT.
FIRM OR AGENCY

1000 FLORIDA STREET
ADDRESS

PUNTA GORDA, FLORIDA 33950
CITY STATE

546



Completeness checked by: *B. Dinton*

Accepted and filed: 3-1-95 Date

BLM. - I.D. 09040310 DEP. USE ONLY

SEND TO:

Department of Environmental Protection
Bureau of Survey and Mapping
3500 Commonwealth Boulevard
Mail Station 105
Tallahassee, Florida 32399