

4024E17

DOC. #

052035

# FLORIDA DEPARTMENT OF ENVIRONMENTAL PROTECTION CERTIFIED CORNER RECORD

CORNER DESCRIPTION:

S. W. corner of Section 2,  
Twp 40 S., Rge 24 E.,  
Tallahassee Base Meridian,  
CHARLOTTE County(s), Florida.

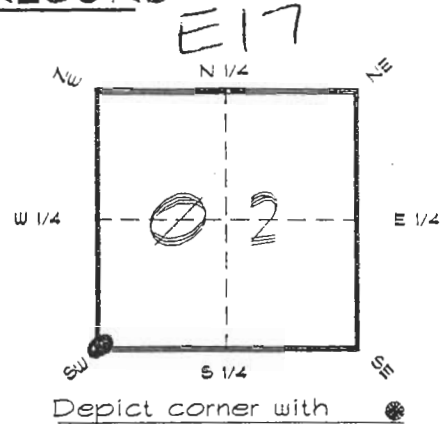

MONUMENTATION DESCRIPTION:

Describe original monument and accessories, or subsequent restoration. Give sources of information. (If no attempt was made to search for the original monument and accessories, this information is not necessary.)

Description of corner evidence found:

State method(s) to determine corner location (lost corners only):

**SET BY DOUBLE PROPORTION**

HORIZONTAL POSITION INFORMATION ( if determined ):

Latitude 27°01'10.40112" N Longitude 81°53'28.66301" W

Y(Northing) 297575.435 m X(Easting) 210786.977 m Zone FLW

Convergence 0°02'57.782" Scale factor 0.99994261

Coordinate determination (circle one): Field traverse GPS

Horizontal datum (circle one): NAD27 NAD83(1986) NAD83(1990) other (explain)

Order of accuracy as defined in "Standards and Specifications for Geodetic Control Networks" published by the Federal Geodetic Control Committee (circle one):  
1st, 2nd, 3rd class \_\_\_\_\_,

or Minimum Technical Standards (Chapter 21HH-6, F.A.C.) ratio of closure for field data (example 1:10,000), \_\_\_\_\_ . This does not specify an order of accuracy.

Control point(s) used for survey: CHARLOTTE COUNTY HORIZONTAL CONTROL NETWORK  
INCLUDES HAVOLINE 2, FLACIDA 2, W260, PUNTPORT, & FLGPS 58 AS 3 ORDER STATIONS.

Comments:

Stamp: JUN 4 1995

4024E17

DOC. #

052035

SKETCH:



NOT TO SCALE

PASTURE

S. W. COR. SEC. 2 40/24

SET CONCRETE MONUMENT  
BY DOUBLE PROPORTION

SET REFERENCE  
IRON ROD

N 89°13'51" W 2658.65'

S 1/4 COR. SEC. 3 40/24  
CONC. MONUMENT

SET REFERENCE  
IRON RODS

PASTURE

BASIS OF BEARING GPS OBSERVATION ( STATE PLANE GRID )

SET SURVEY MARKER POST 2.0' W'LY REF:FB 304-14

REFERENCE MEASUREMENTS

<u>Description</u>	<u>Bearing</u>	<u>Distance</u>
SET REF. IRON ROD	S 73°42'41" W	66.95'
SET REF. IRON ROD	N 62°13'24" E	55.73'
SET REF. IRON ROD	S 13°48'21" E	52.13'

SURVEYORS CERTIFICATE: I certify the monument and accessories indicated above were field located on MAY 15, 1995

*R. Rose*

PLS 4260

SIGNATURE

6/5/95

DATE

CHARLOTTE COUNTY SURVEY DEPT.

FIRM OR AGENCY

1000 FLORIDA STREET

ADDRESS

PUNTA GORDA, FLA. 33950

CITY

STATE

546



Completeness checked by: *B. Lent*  
 Accepted and filed: *7-31-95*  
 Date: *7-31-95*  
 BLM - ID: *10030211* D.E.P. USE ONLY

SEND TO:

Department of Environmental Protection  
Bureau of Survey and Mapping  
3900 Commonwealth Boulevard  
Mail Station 105  
Tallahassee, Florida 32399