

4024J05

DOC. #

051059

FLORIDA DEPARTMENT OF ENVIRONMENTAL PROTECTION
CERTIFIED CORNER RECORD

CORNER DESCRIPTION:

S. E. corner of Section 7,

Twp 40 S., Rge 24 E.,

Tallahassee Base Meridian,

CHARLOTTE County(s), Florida.

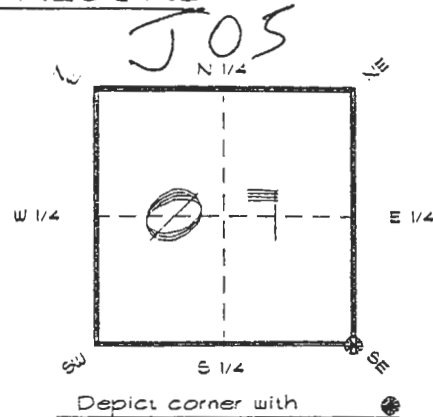

MONUMENTATION DESCRIPTION:

Describe original monument and accessories, or subsequent restoration. Give sources of information. (If no attempt was made to search for the original monument and accessories, this information is not necessary.)

Description of corner evidence found:

4"x4" CONCRETE MONUMENT "CHAR. ENGR."

State method(s) to determine corner location (lost corners only):

HORIZONTAL POSITION INFORMATION (if determined):

Latitude 27°00'19.68390" N Longitude 81°56'25.92947" W

Y(Northing) 296011.253 m X(Easting) 205901.464 m Zone FLW

Convergence 0°01'37.204" Scale factor 0.99994161

Coordinate determination (circle one): Field traverse GPS

Horizontal datum (circle one): NAD27 NAD83(1986) NAD83(1990) other (explain)

Order of accuracy as defined in Standards and Specifications for Geodetic Control Networks published by the Federal Geodetic Control Committee (circle one):

1st, 2nd, 3rd, class 1

or Minimum Technical Standards (Chapter 61G17, F.A.C.) ratio of closure for field data (example 1:10,000), _____ . This does not specify an order of accuracy.

Control point(s) used for survey: CHARLOTTE COUNTY HORIZONTAL CONTROL NETWORK INCLUDES HAYOLINE 2, PLACIDA 2, W260, PUNTPORT, 4 FLGPS 58 AS B ORDER STATIONS.

Comments:

RECEIVED

FEB 20 1995

SURVEY & MAPPING

4024J05

DOC. #

051059

SKETCH:



NOT TO SCALE

S. E. COR. SEC. 7 40/24

FOUND 4"x4" CONC. MON.
"CHAR. ENGR."

PK & DISK LB 3943
IN TOP FENCE POST

N 88°26'57" W 2616.78'

CONC. MON. AT
S. 1/4 COR. SEC. 7

DISK Ø387 IN
8" PINE



AERIAL TARGET
IRON ROD & ALUM. CAP
"DMK TRAV. PT."
N 296006.402 m
E 205909.461 m

DISK Ø388 IN
GATE POST

BASIS OF BEARING GPS OBSERVATION
SET SURVEY MARKER POST 0.5' N'LY

REFER: FB 304/45

REFERENCE MEASUREMENTS

Description	Bearing	Distance
IRON ROD & ALUM. CAP	S 58°43'54" E	30.69'
PK & DISK LB 3943	N 89°50'22" E	17.62'
DISK Ø388 IN GATE POST	S 02°11'45" E	22.39'
DISK Ø387 IN 8" PINE	S 15°21'10" W	78.19'

SURVEYORS CERTIFICATE: I certify the monument and accessories indicated above
were field located on AUGUST 23, 1994

R. P. Rose

FLS 4260

UPDATED 2/2/95

SIGNATURE

2-15-95

DATE

CHARLOTTE COUNTY SURVEY DEPT.

FIRM OR AGENCY

7000 FLORIDA STREET

ADDRESS

PUNTA GORDA, FLORIDA 33950

CITY

STATE

546



SEND TO:

Department of Environmental Protection
Bureau of Survey and Mapping
3900 Commonwealth Boulevard
Mail Station 105
Tallahassee Florida 32399

Completeness checked by: *B. Smith*
Accepted and filed: 3-1-95
BLM - ID. 18070817 Date
DEP. USE ONLY