

4024J13

DOC. #

051060

FLORIDA DEPARTMENT OF ENVIRONMENTAL PROTECTION CERTIFIED CORNER RECORD

CORNER DESCRIPTION:

S. E. corner of Section 09 ,
Twp 40 S. , Rge 24 E. ,
Tallahassee Base Meridian,
CHARLOTTE County(s), Florida.

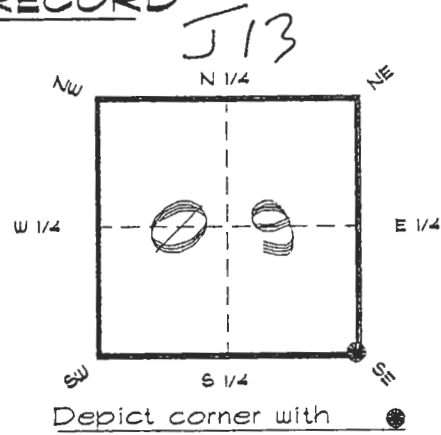

MONUMENTATION DESCRIPTION:

Describe original monument and accessories, or subsequent restoration. Give sources of information. (If no attempt was made to search for the original monument and accessories, this information is not necessary.)

Description of corner evidence found:

3" x3" CONCRETE MONUMENT

State method(s) to determine corner location (lost corners only):

HORIZONTAL POSITION INFORMATION (if determined):

Latitude 27°00'17.3888" N Longitude 81°54'28.65599" W
Y(Northing) 295342.558 m X(Easting) 209134.495 m Zone FLW
Convergence 0°02'30.45" Scale factor 0.99994221

Coordinate determination (circle one): Field traverse **GPS**

Horizontal datum (circle one): NAD27 NAD83(1986) **NAD83(1990)** other (explain)

Order of accuracy as defined in "Standards and Specifications for Geodetic Control Networks" published by the Federal Geobetic Control Committee (circle one):
1st, **2nd**, 3rd, class _____ ,

or Minimum Technical Standards (Chapter 21HH-6, F.A.C.) ratio of closure for field data (example 1:10,000), _____ . This does not specify an order of accuracy.

Control point(s) used for survey: CHARLOTTE COUNTY HORIZONTAL CONTROL NETWORK INCLUDES HAVOLINE 2, PLACIDA 2, W260, PUNTPORT, 4 FLGPS 58 AS B ORDER STATIONS.

Comments:

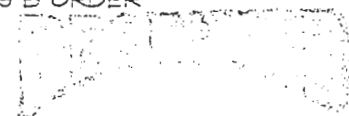

FEB 20 1995

SURVEY & MAPPING

051060

4024J13

DOC. #

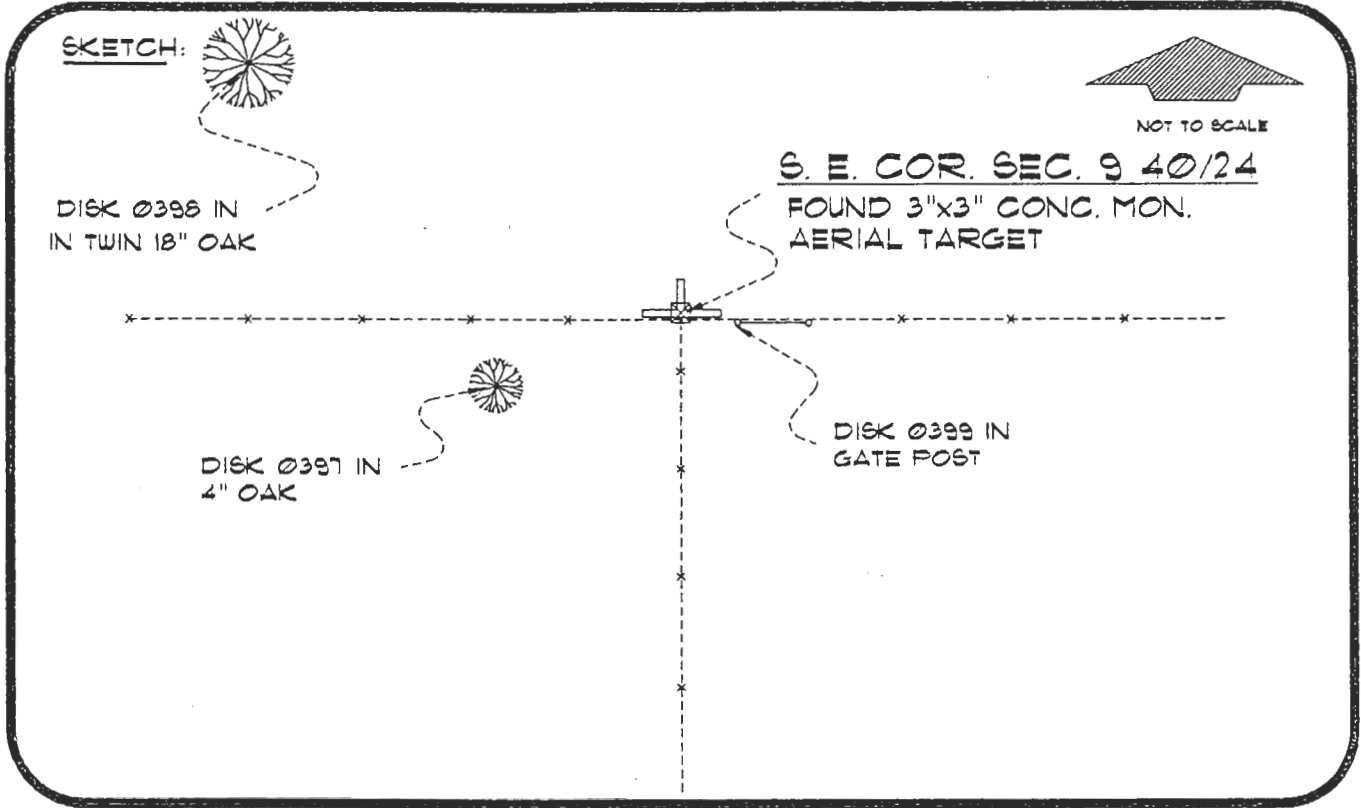

BASIS OF BEARING SOLAR OBSERVATION

REFER: FB 304/48

REFERENCE MEASUREMENTS

| <u>Description</u> | <u>Bearing</u> | <u>Distance</u> |
|---------------------------|----------------|-----------------|
| DISK 0397 IN 4" OAK | S 78°06'34" W | 76.90' |
| DISK 0398 IN TWIN 18" OAK | N 55°12'26" W | 454.05' |
| DISK 0399 IN GATE POST | S 87°54'46" E | 7.03' |

SURVEYORS CERTIFICATE: I certify the monument and accessories indicated above were field located on FEBRUARY 15, 1995

R. Rose

PLS 4260

SIGNATURE

2-15-95

DATE

CHARLOTTE COUNTY SURVEY DEPT.

FIRM OR AGENCY

7000 FLORIDA STREET

ADDRESS

PUNTA GORDA, FLA. 33950

CITY

STATE

546



SEND TO:

Department of Environmental Protection
Bureau of Survey and Mapping
3900 Commonwealth Boulevard
Mail Station 105
Tallahassee, Florida 32399

Completeness checked by: *[Signature]*

Accepted and filed: 3-1-95 Date

BLM. - ID. 16091015 DNR USE ONLY