

4024J17

DOC. #

051062

FLORIDA DEPARTMENT OF ENVIRONMENTAL PROTECTION CERTIFIED CORNER RECORD

CORNER DESCRIPTION:

S. E. corner of Section 10

Twp 40 S., Rge 24 E.

Tallahassee Base Meridian,

CHARLOTTE County(s), Florida.

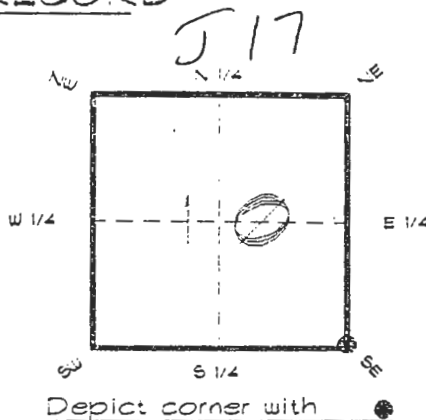

MONUMENTATION DESCRIPTION:

Describe original monument and accessories, or subsequent restoration. Give sources of information. (If no attempt was made to search for the original monument and accessories, this information is not necessary.)

Description of corner evidence found:

2" IRON PIPE

State method(s) to determine corner location (lost corners only):

HORIZONTAL POSITION INFORMATION (if determined):

Latitude 27°00'16.03174" N Longitude 811°53'28.71277" W

Y(Northing) 295902.105 m X(Easting) 210787.047 m Zone FLW

Convergence 0°02'57.668" Scale factor 0.99994261

Coordinate determination (circle one): Field traverse GPS

Horizontal datum (circle one): NAD27 NAD83(1986) NAD83(1990) other (explain)

Order of accuracy as defined in "Standards and Specifications for Geodetic Control Networks" published by the Federal Geodetic Control Committee (circle one):
1st, 2nd, 3rd, class 1

or Minimum Technical Standards (Chapter 21HH-6, F.A.C.) ratio of closure for field data (example 1:10,000), _____ . This does not specify an order of accuracy.

Control point(s) used for survey: CHARLOTTE COUNTY HORIZONTAL CONTROL NETWORK INCLUDES HAYLINE 2, PLACIDA 2, W260, PUNTPORT, 4 FLGPS 58 AS B ORDER STATIONS.

Comments:

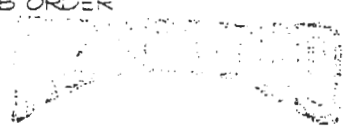

FEB 20 1995

SURVEY & MAPPING

051062

4024J17

DOC. #

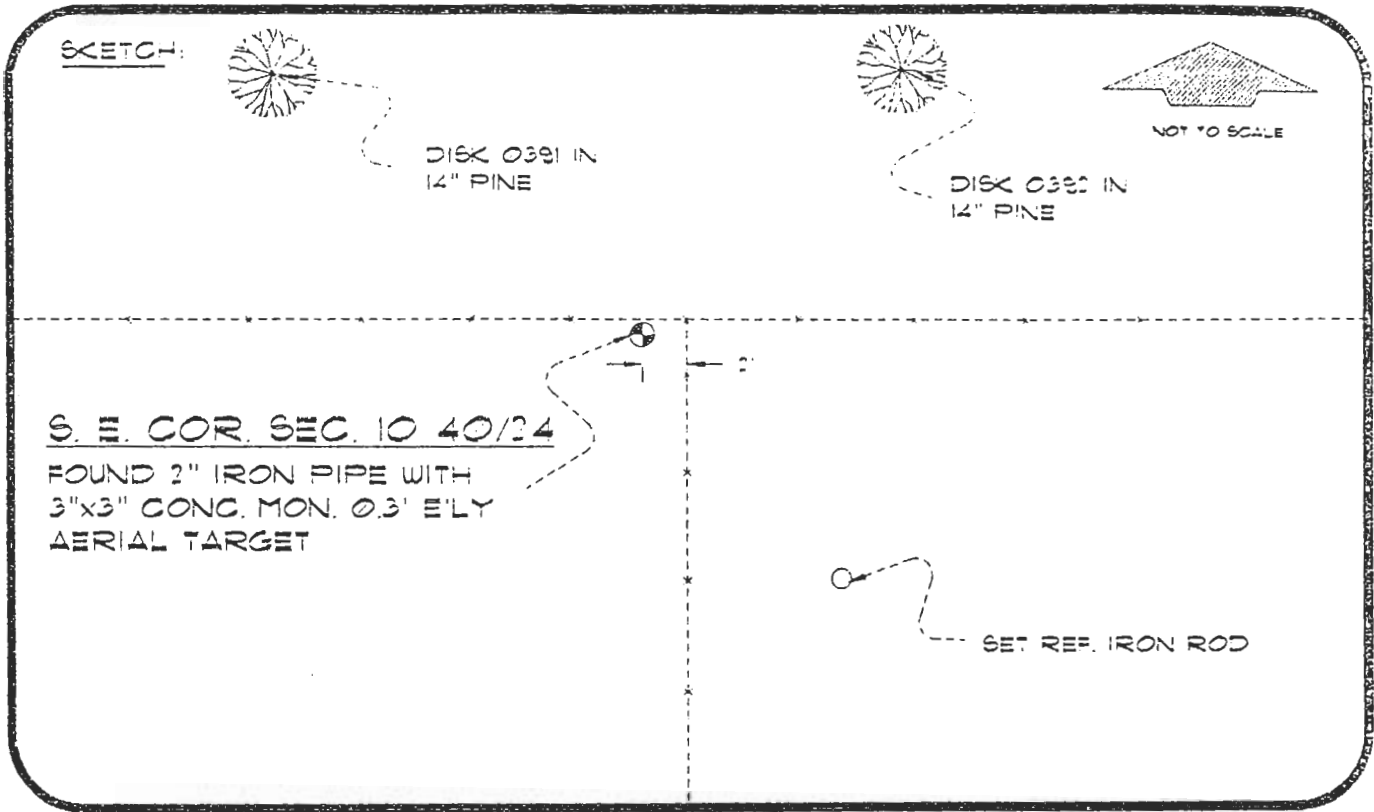

BASIS OF BEARING SOLAR OBSERVATION
SET SURVEY MARKER POST 3' E'LY

REFER: FS 304/27

REFERENCE MEASUREMENTS

Description	Bearing	Distance
DISK 0392 IN 14" PINE	N 59°32'42" W	74.92'
DISK 0391 IN 14" PINE	N 46°37'07" E	56.95'
SET REF. IRON ROD	S 31°18'19" E	33.09'

SURVEYORS CERTIFICATE: I certify the monument and accessories indicated above were field located on FEBRUARY 9, 1995

R. Rose

PLS 4260

SIGNATURE

2-15-95

DATE

CHARLOTTE COUNTY SURVEY DEPT.

FIRM OR AGENCY

1000 FLORIDA STREET

ADDRESS

PUNTA GORDA FLA 33950

CITY

STATE



546

Completeness checked by: *B. Smith*

Accepted and filed: *3-1-95*

BLM - ID. 15101114 Date

DNR USE ONLY

SEND TO:

Department of Environmental Protection
Bureau of Survey and Mapping
3900 Commonwealth Boulevard
Mail Station 105
Tallahassee Florida 32399