

FLORIDA DEPARTMENT OF ENVIRONMENTAL PROTECTION  
CERTIFIED CORNER RECORD

CORNER DESCRIPTION:

S. E. corner of Section 11  
Twp 40 S., Rge 24 E.  
Tallahassee Base Meridian,  
CHARLOTTE County(s), Florida.

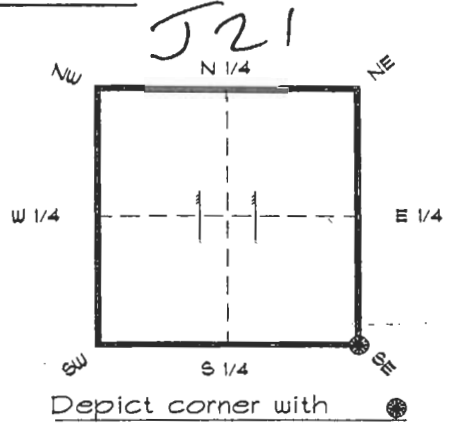

MONUMENTATION DESCRIPTION:

Describe original monument and accessories, or subsequent restoration. Give sources of information. (If no attempt was made to search for the original monument and accessories, this information is not necessary.)

Description of corner evidence found:

3"x3" CONCRETE MONUMENT

State method(s) to determine corner location (lost corners only):

HORIZONTAL POSITION INFORMATION ( if determined ):

Latitude 27°00'17.80183" N Longitude 81°52'30.26836" W  
Y(Northing) 295958.075 m X(Easting) 212398.196 m Zone FL. W.  
Convergence 0°03'24.209" Scale factor 0.99994307

Coordinate determination (circle one): Field traverse (GPS)

Horizontal datum (circle one): NAD27 NAD83(1986) NAD83(1990) other (explain)

Order of accuracy as defined in "Standards and Specifications for Geodetic Control Networks" published by the Federal Geodetic Control Committee (circle one): 1st, 2nd, 3rd, class 1

or Minimum Technical Standards (Chapter 21HH-6, F.A.C.) ratio of closure for field data (example 1:10,000), This does not specify an order of accuracy.

Control point(s) used for survey: CHARLOTTE COUNTY HORIZONTAL CONTROL NETWORK INCLUDES HAVOLINE 2, PLACIDA 2, W260, PUNTPORT, 4 FLGPS 58 AS B ORDER STATIONS.

Comments:



APR 14 1995

SURVEY & MAPPING

4024J21

051551

4024J21

DOC. #

SKETCH:

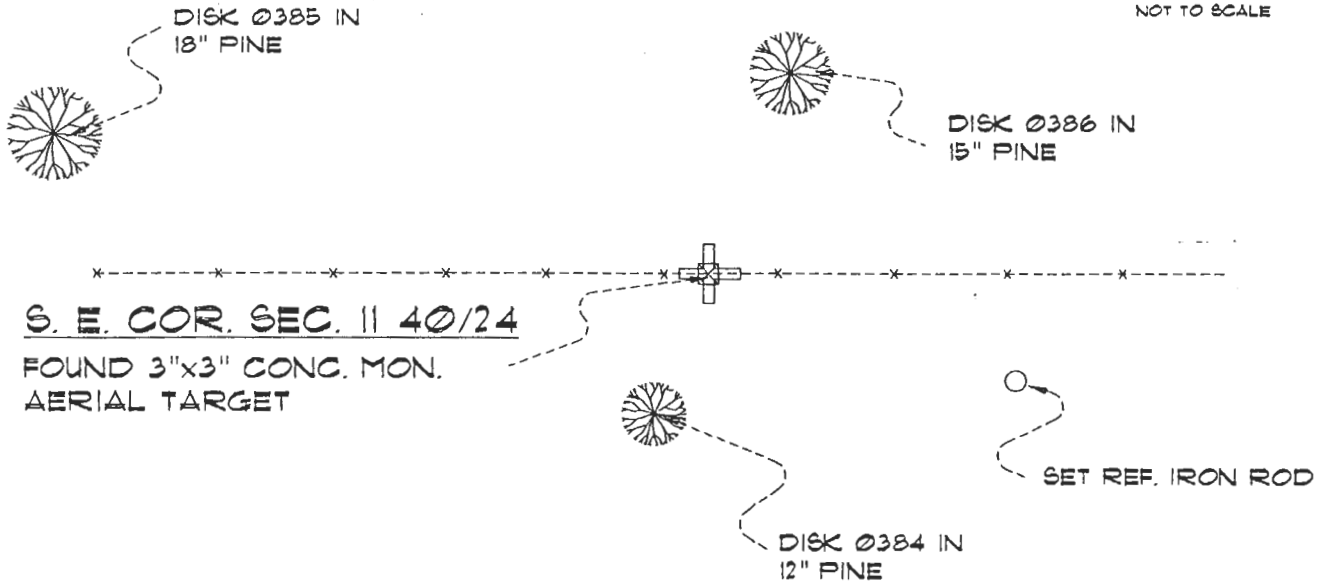

BASIS OF BEARING SOLAR OBSERVATION

REFER: FB 304/44

SET SURVEY MARKER POST 0.4' N'LY

REFERENCE MEASUREMENTS

<u>Description</u>	<u>Bearing</u>	<u>Distance</u>
DISK 0384 IN 12" PINE	S 13°06'52" W	19.18'
DISK 0385 IN 18" PINE	N 81°32'11" W	162.21'
DISK 0386 IN 15" PINE	N 08°37'12" E	39.64'
SET REF. IRON ROD	S 81°57'20" E	67.57'

SURVEYORS CERTIFICATE: I certify the monument and accessories indicated above were field located on FEBRUARY 22, 1995

*R. Rose*  
SIGNATURE

PLS 4260

April 11, 1995  
DATE

CHARLOTTE COUNTY SURVEY DEPT.  
FIRM OR AGENCY

1000 FLORIDA STREET  
ADDRESS

PUNTA GORDA, FLA. 33950  
CITY STATE

546



Completeness checked by: B. Linder  
 Accepted and filed: 5-1-95 Date  
 Ex. 111 - 110. 1411213 IDENTIFICATION ONLY

SEND TO:

Department of Environmental Protection  
Bureau of Survey and Mapping  
3900 Commonwealth Boulevard  
Mail Station 105  
Tallahassee, Florida 32399