

4024Z13

FLORIDA DEPARTMENT OF ENVIRONMENTAL PROTECTION
CERTIFIED CORNER RECORD

CORNER DESCRIPTION:

S. E. corner of Section 33

Twp 40 S. Rge 24 E.

Tallahassee Base Meridian,

CHARLOTTE County(s), Florida.

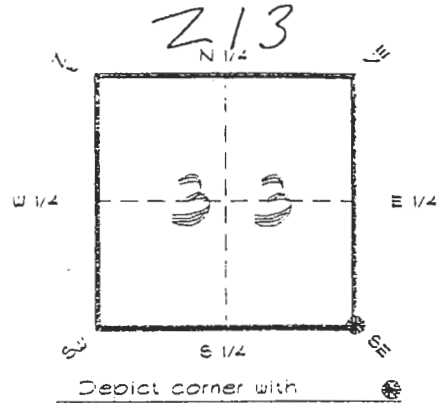

MONUMENTATION DESCRIPTION:

Describe original monument and accessories, or subsequent restoration. Give sources of information. (If no attempt was made to search for the original monument and accessories, this information is not necessary.)

Description of corner evidence found:

PK NAIL



JAN 31 1995

State method(s) to determine corner location (lost corners only).

SURVEY & MAPPING

HORIZONTAL POSITION INFORMATION (if determined):

Latitude 26°56'47.81728" N Longitude 81°54'27.90531" W

Y(Northing) 289492.619 m X(Easting) 309159.900 m Zone FLW

Convergence 0°02'30.492" Scale factor 0.99994221

Coordinate determination (circle one): Field traverse GPS

Horizontal datum (circle one): NAD27 NAD83(1986) NAD83(1990) other (explain)

Order of accuracy as defined in Standards and Specifications for Geodetic Control Networks published by the Federal Geodetic Control Committee (circle one):

1st, 2nd, 3rd, class I

or Minimum Technical Standards (Chapter 61G17, F.A.C.) ratio of closure for field data (example 1:10,000). _____ This does not specify an order of accuracy.

Control point(s) used for survey: CHARLOTTE COUNTY HORIZONTAL CONTROL NETWORK INCLUDES HAVOLINE 2, PLACIDA 2, W260 PUNTPORT, 4 FLGPS 58 AS B ORDER STATIONS.

Comments:

4024Z13

DOC. #

051087

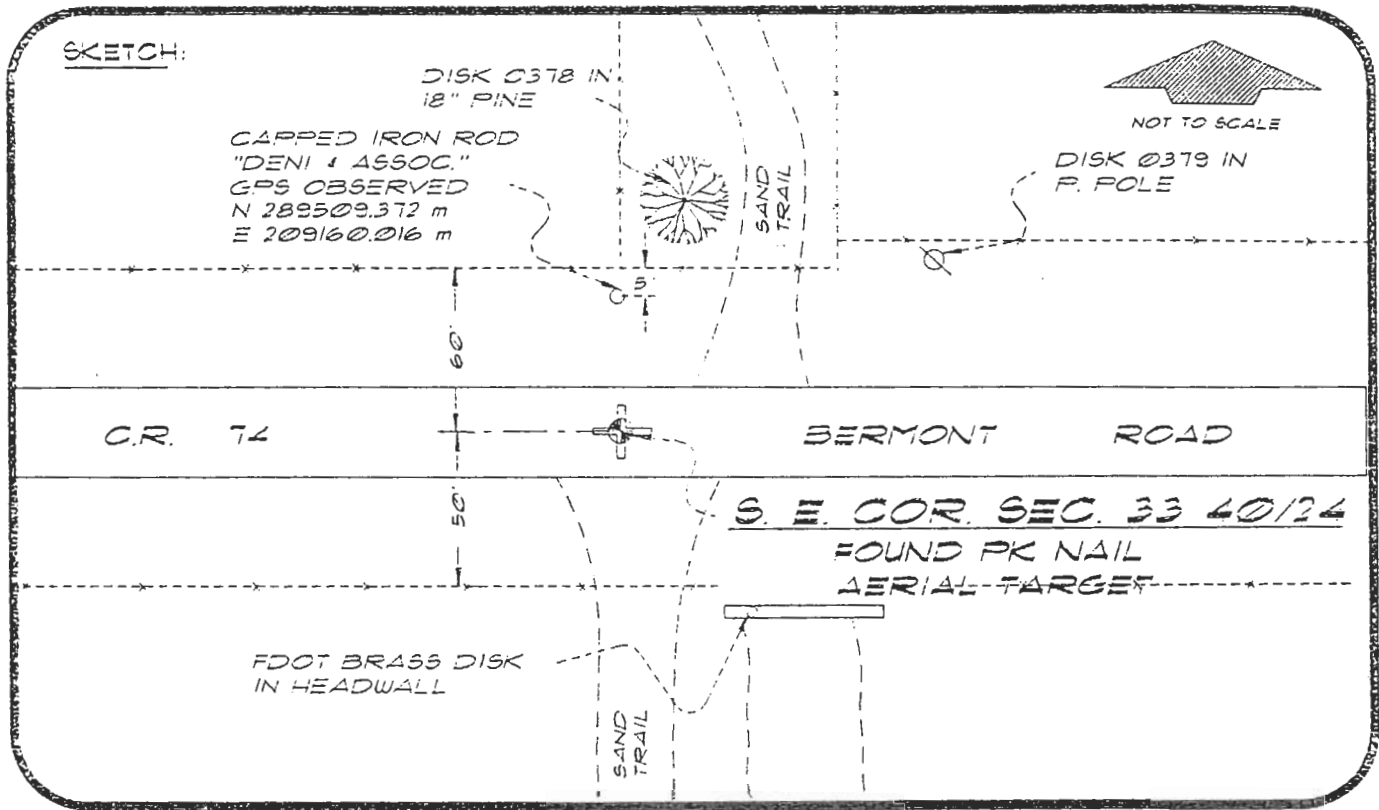

BASIS OF BEARING SOLAR OBSERVATION. REFER: FB 304/41

REFERENCE MEASUREMENTS

Description	Bearing	Distance
DISK 0378 IN 22" PINE	N 12°26'04" E	73.43'
DISK 0379 IN P. POLE	N 52°00'12" E	97.46'
DISK IN HEADWALL	S 23°59'04" E	50.64'
CAPPED IRON ROD	N 00°26'13" E	54.97'
	(N 00°23'43" E GRID)	

SURVEYORS CERTIFICATE: I certify the monument and accessories indicated above were field located on FEBRUARY 15, 1994

R. P. Ross
SIGNATURE

PLS 4260

UPDATED JAN. 12, 1995

1/30/95
DATE

CHARLOTTE COUNTY SURVEY DEPT.
FIRM OR AGENCY

7000 FLORIDA STREET
ADDRESS

PUNTA GORDA FLORIDA 33950
CITY STATE



508

Completeness checked by B. Sinton
 Accepted and filed: 3-1-95 Date
 BLM. - ID. 04373403 DNR USE ONLY

SEND TO:
 Department of Environmental Protection
 Bureau of Survey and Mapping
 3900 Commonwealth Boulevard
 Mail Station 105
 Tallahassee Florida 32399