

**FLORIDA DEPARTMENT OF ENVIRONMENTAL PROTECTION
CERTIFIED CORNER RECORD**

CORNER DESCRIPTION:

S. W. corner of Section 02 ,
Twp 40 S. , Rge 25 E. ,
Tallahassee Base Meridian,
CHARLOTTE County(s), Florida.

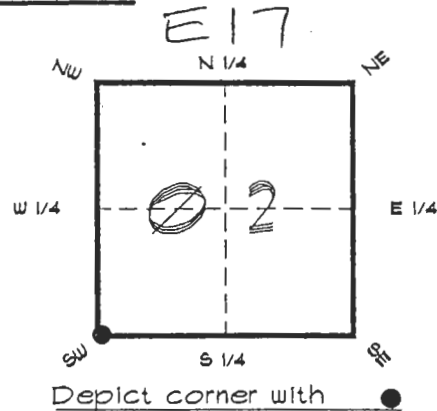

MONUMENTATION DESCRIPTION:

Describe original monument and accessories, or subsequent restoration. Give sources of information. (If no attempt was made to search for the original monument and accessories, this information is not necessary.)

Description of corner evidence found:

3"x3" CONCRETE MONUMENT 1.5' BELOW, SET C.C.S.D. CONCRETE MONUMENT ABOVE. FENCE LINE 0.5' N'LY

State method(s) to determine corner location (lost corners only):

HORIZONTAL POSITION INFORMATION (if determined):

Latitude 27°01'10.52473" N Longitude 81°47'35.17482" W

Y(Northing) 297591.430 m X(Easting) 220530.687 m Zone _____

Convergence 0°05'38.372" Scale factor 0.99994638

Coordinate determination (circle one): Field traverse GPS

Horizontal datum (circle one): NAD27 NAD83(1986) NAD83(1990) other (explain)

Order of accuracy as defined in "Standards and Specifications for Geodetic Control Networks" published by the Federal Geodetic Control Committee (circle one): 1st, 2nd, 3rd, class _____ ,

or Minimum Technical Standards (Chapter 21HH-6, F.A.C.) ratio of closure for field data (example 1:10,000), _____ . This does not specify an order of accuracy.

Control point(s) used for survey: CHARLOTTE COUNTY HORIZONTAL CONTROL NETWORK INCLUDES HAVOLINE 2, PLACIDA 2, W260, PUNTPORT, & FLGPS 58 AS B ORDER STATIONS.

Comments:

RECEIVED

MAR 21 1995

SURVEY & MAPPING

055751

4025E17

DOC. #

SKETCH:

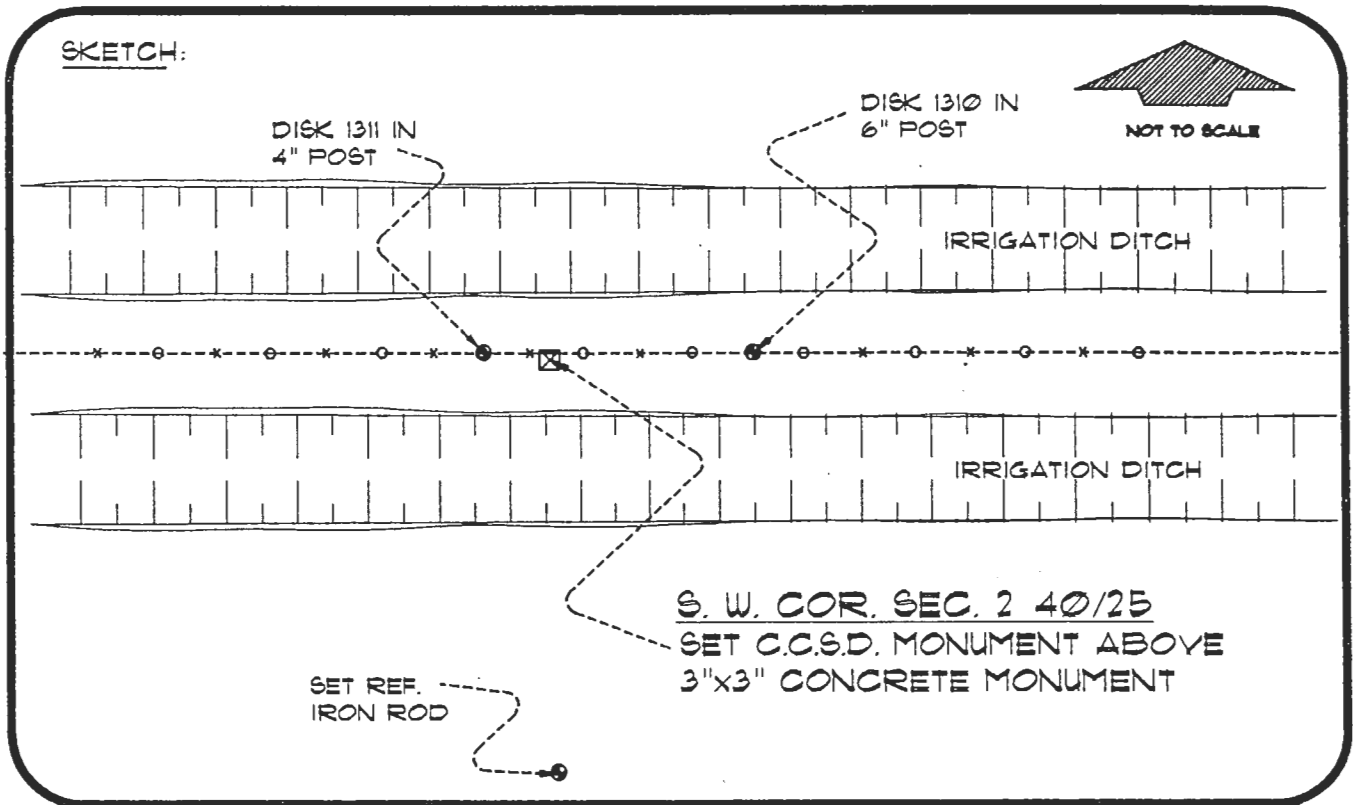

BASIS OF BEARING SOLAR OBSERVATION REFER: FB 307/50
 SET SURVEY MARKER POST 1.0' N'LY

REFERENCE MEASUREMENTS

Description	Bearing	Distance
SET REF. IRON ROD	S 01°54'16" E	66.33'
DISK 1311 IN 4" POST	N 88°38'10" W	6.59'
DISK 1310 IN 6" POST	N 89°56'03" E	36.60'

SURVEYORS CERTIFICATE: I certify the monument and accessories indicated above were field located on APRIL 5, 1995

R. Rose

PLS 4260

SIGNATURE

MARCH 18, 1996

DATE

CHARLOTTE COUNTY SURVEY DEPT.

FIRM OR AGENCY

7000 FLORIDA STREET

ADDRESS

PUNTA GORDA, FLA. 33950

CITY

STATE

545



SEND TO:

Department of Environmental Protection
 Bureau of Survey and Mapping
 3900 Commonwealth Boulevard
 Mail Station 105
 Tallahassee, Florida 32399

Completeness checked by: *B. Smith*
 Accepted and filed: *4-1-96*
 BLM - ID. 10030211 Date
 D.E.P. USE ONLY