

# FLORIDA DEPARTMENT OF ENVIRONMENTAL PROTECTION

## CERTIFIED CORNER RECORD

DOC. # 089326

CORNER DESCRIPTION:      MONUMENTATION DESCRIPTION (EVIDENCE FOUND OR METHOD TO SET)

Depict corner with  Z-9

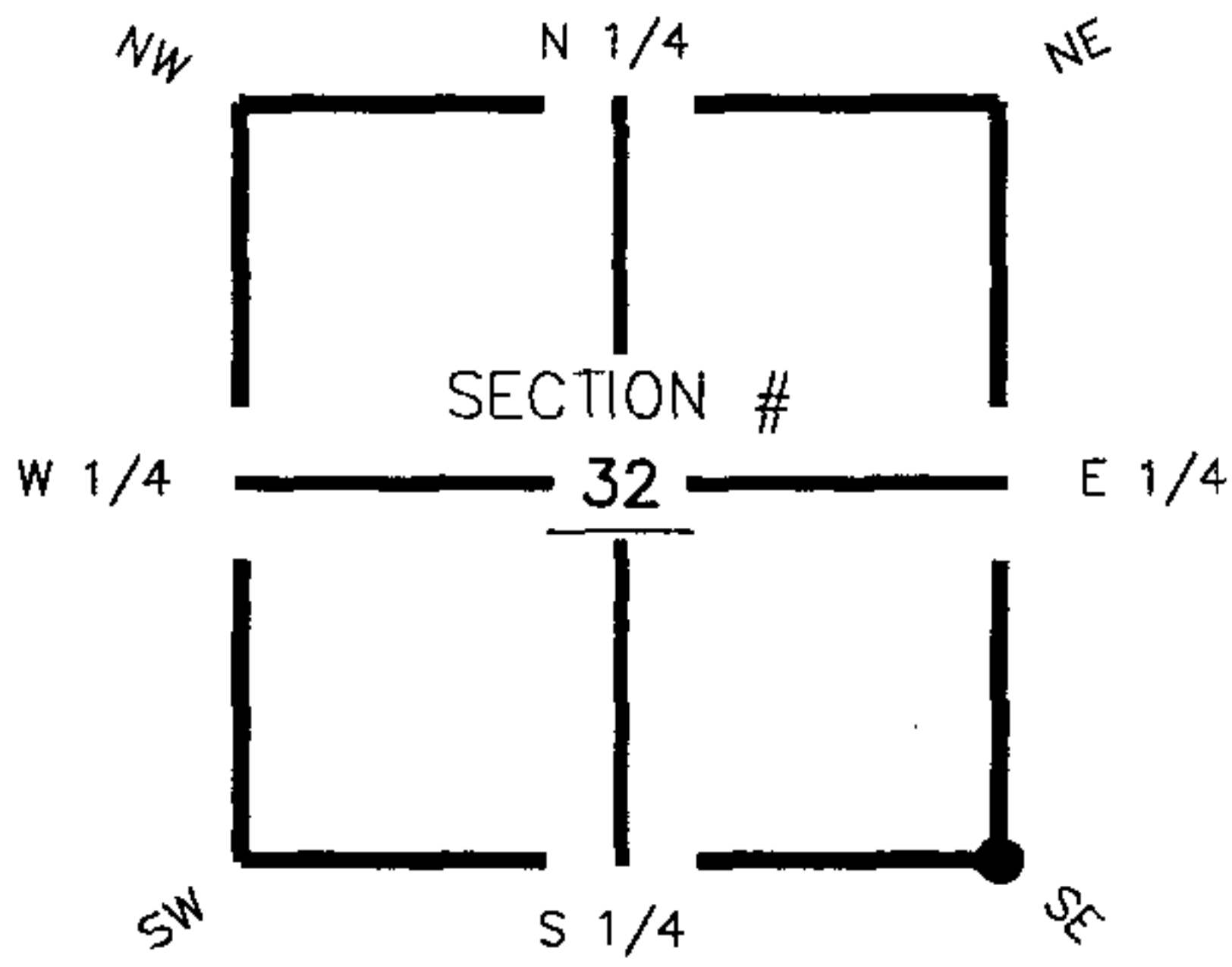

Set PK Nail & Disc  
(LB 642)

HORIZONTAL POSITION INFORMATION ( if determined ):

Latitude 26° 56' 44.43233" N      Longitude 81° 43' 42.08997" W  
 Y(NORTHING-Ft.) 949519.34      X(EASTING-Ft.) 744661.18      Zone FL83-WF  
 Convergence 0° 07' 23.13821"      Scale factor 0.999950155  
 Coordinate determination (circle one):      Field traverse  GPS  
 Horizontal datum (circle one):      NAD27      NAD83(1986)       NAD83(1999)      other (explain)  
 Accuracy (circle one):      1st       2nd      3rd      other \_\_\_\_\_

SE corner of Section 32  
 Twp 40 South , Rge 26 East  
 Tallahassee Base Meridian,  
Charlotte County(s), Florida

1. 5' 50.15'. Found 6"x6" state road R/W Concrete Monument.
2. 84' 50.65'. Set PK Nail and Trav. Pt. Disc (LB 642) in white paint stripe at N. E.O.P.
3. 90' 106.25'. Set PK Nail and Trav. Pt. Disc (LB 642) in white paint stripe at N. E.O.P.

NOT TO SCALE

Field Book LB-33, Page 7

SURVEYORS CERTIFICATE:

I certify the monument and accessories indicated above were field located on October 18, 2005

*[Signature]*  
 SIGNATURE \_\_\_\_\_ 4912  
 Johnson Engineering, Inc. PSM NO. \_\_\_\_\_  
 FIRM OR AGENCY \_\_\_\_\_ 642  
 251 West Hickpochee (SR80) ADDRESS \_\_\_\_\_ LB NO. \_\_\_\_\_  
 La Belle CITY STATE Florida ZIP 33935  
 (863) 612-0594 PHONE NUMBER DATE October 27, 2005

EMBOSSED SEAL OVER SIGNATURE

SEND ORIGINAL TO:  
 Department of Environmental Protection  
 Bureau of Surveying and Mapping  
 3900 Commonwealth Boulevard  
 Mail Station 105  
 Tallahassee, Florida 32399

D.E.P. USE ONLY	
Processed:	<u>10-31-06 MB</u>
B.L.M. - I.D.	<u>300100</u>
QUAD - I.D.	<u>2414 Telegraph Swamp NW</u>