

FLORIDA DEPARTMENT OF ENVIRONMENTAL PROTECTION

CERTIFIED CORNER RECORD

079897

DOC. # _____

CORNER DESCRIPTION: **MONUMENTATION DESCRIPTION (EVIDENCE FOUND OR METHOD TO SET)**

Depict corner with

Set 4"x4" Concrete Monument Stamped with LB 6940

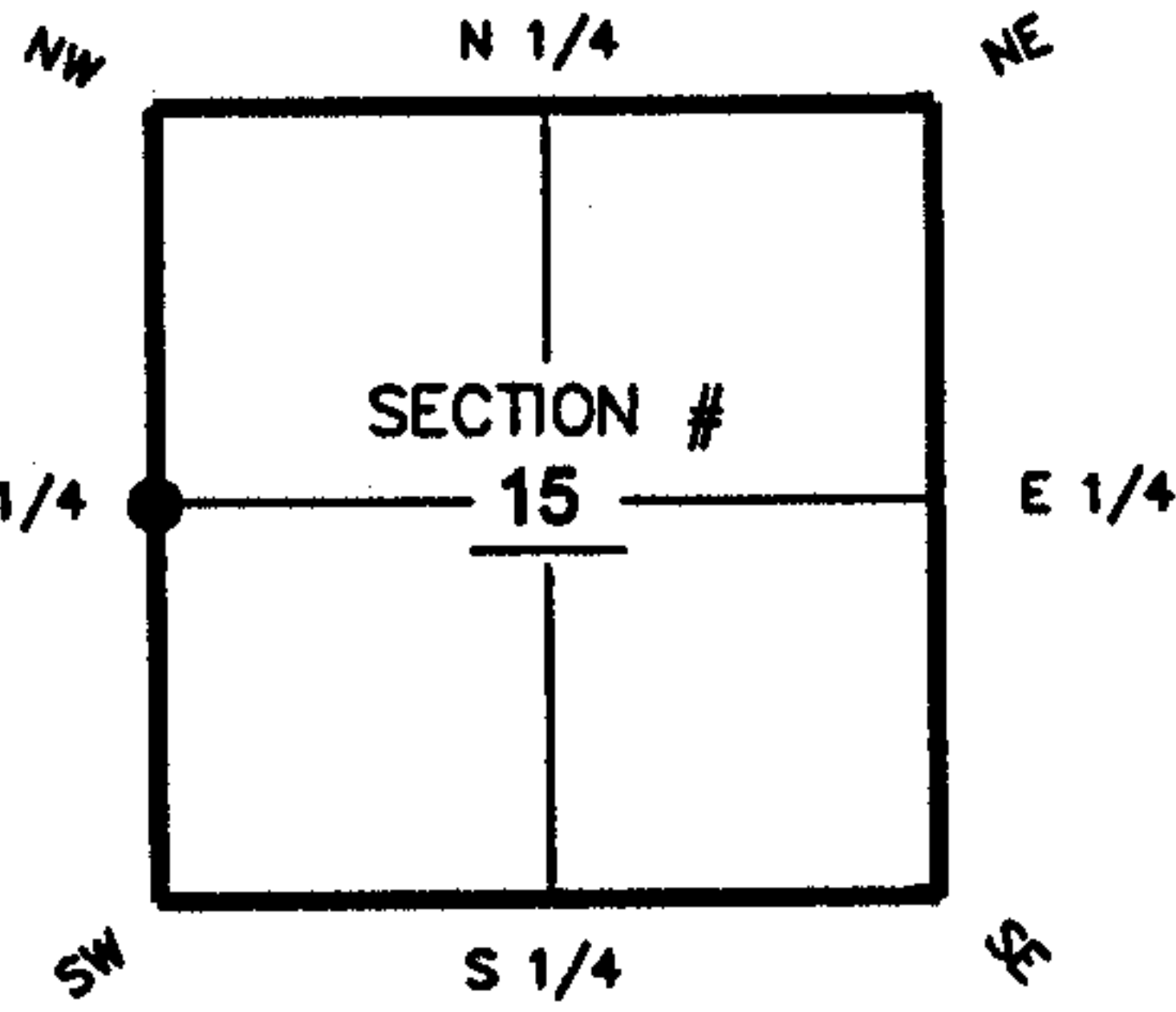

Single Proportion

W 1/4 corner of Section 15
Twp 40 S, Rge 27 E
Tallahassee Base Meridian,
Charlotte County(s), Florida

HORIZONTAL POSITION INFORMATION (if determined):

Latitude 26-59-48.1000 N Longitude 81-36-43.8846 W
 Y(NORTHING-Ft.) 968163.878 X(EASTING-Ft.) 782449.410 Zone FL W
 Convergence 0-10-33.75916118 Scale factor 0.99995946
 Coordinate determination (circle one): Field traverse GPS
 Horizontal datum (circle one): NAD27 NAD83(1986) NAD83(1990) other (explain)
 Accuracy (circle one): 1st 2nd 3rd other _____

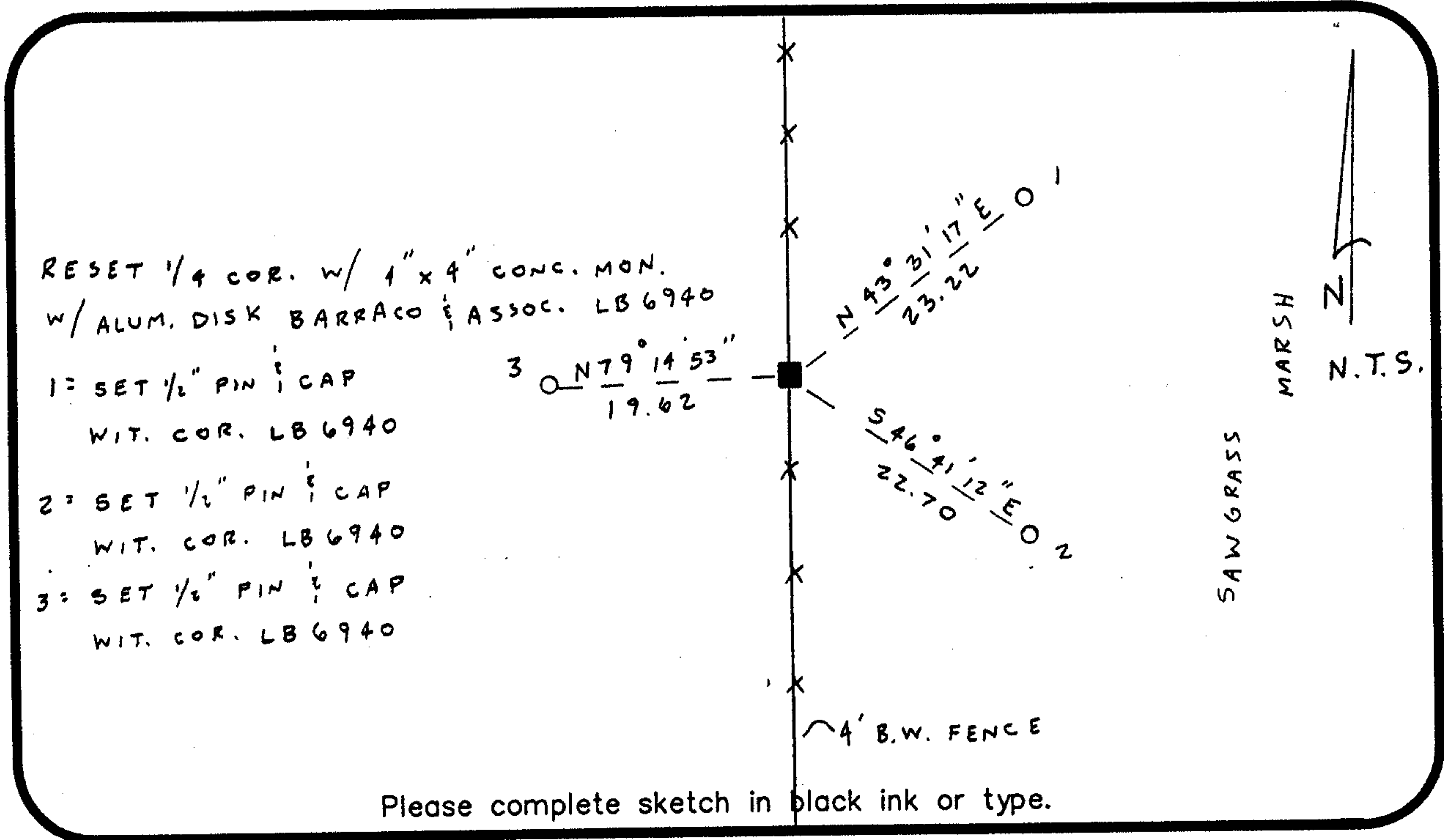

SURVEYORS CERTIFICATE:

I certify the monument and accessories indicated above were field located on July 11, 2003

Sara A. Barraco 5949
 SIGNATURE PSM NO.
 Barraco and Associates, Inc. LB 6940
 FIRM OR AGENCY LB NO.
 2271 McGregor Boulevard ADDRESS
 Fort Myers FL 33902-2800
 CITY STATE ZIP
 (239) 461-3170 8/11/2003
 PHONE NUMBER DATE

SEND ORIGINAL TO:
 Department of Environmental Protection
 Bureau of Surveying and Mapping
 3900 Commonwealth Boulevard
 Mail Station 105
 Tallahassee, Florida 32399

D.E.P. USE ONLY
 Processed: 9-23-2003 CH
 B.L.M. - I.D. 400 440
 QUAD - I.D. 2413 Telegraph Swamp NE

EMBOSSSED SEAL OVER SIGNATURE