

FLORIDA DEPARTMENT OF ENVIRONMENTAL PROTECTION

CERTIFIED CORNER RECORD

079898

DOC. # _____

CORNER DESCRIPTION: **MONUMENTATION DESCRIPTION (EVIDENCE FOUND OR METHOD TO SET)**

Depict corner with Found 3.5"x 3.5" Concrete Monument with Nail in Center

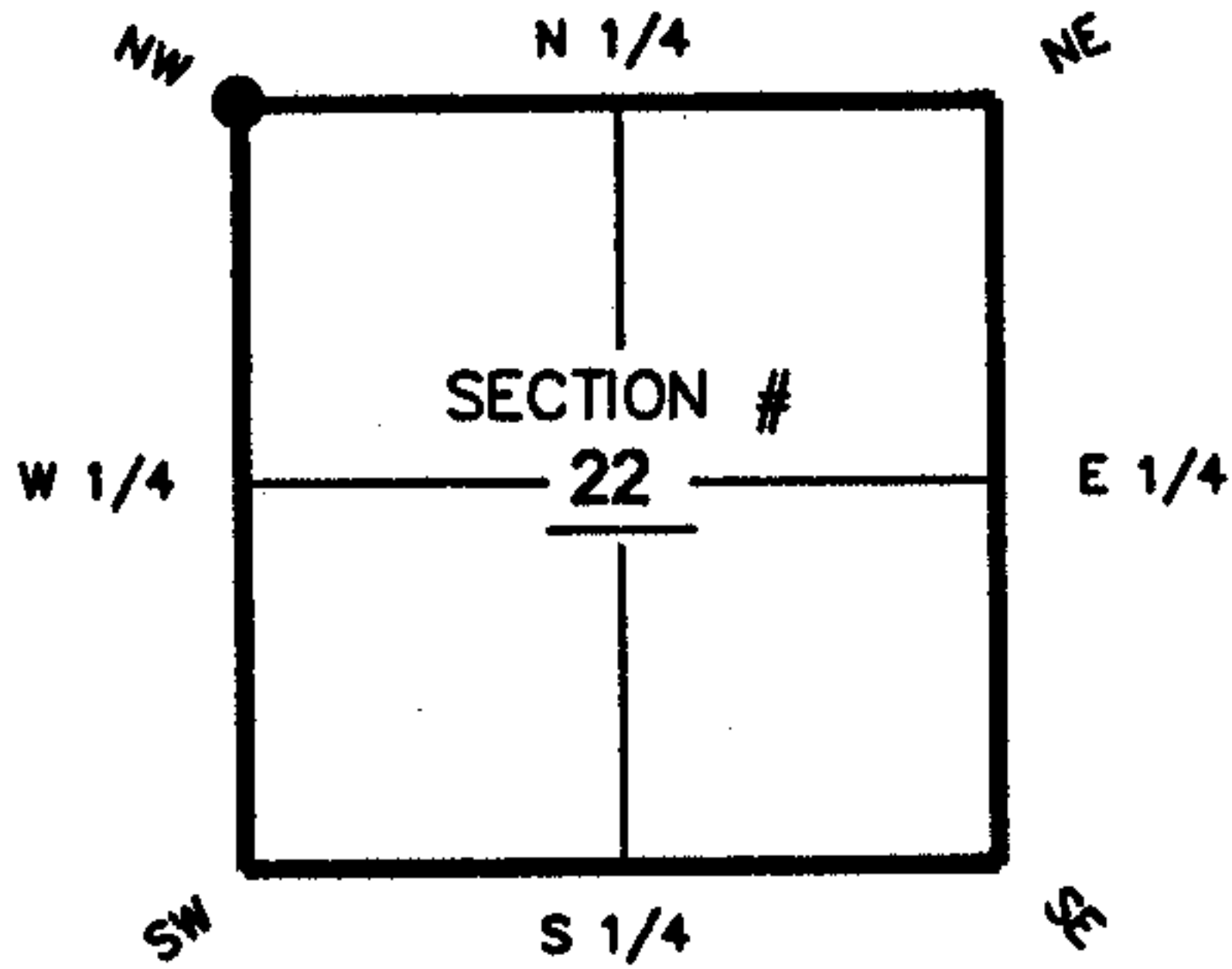

NW corner of Section 22
Twp 40 S, Rge 27 E
Tallahassee Base Meridian,
Charlotte County(s), Florida

HORIZONTAL POSITION INFORMATION (if determined):

Latitude 26-59-21.3952 N Longitude 81-36-43.9562 W
 Y(NORTHING-Ft.) 965467.330 X(EASTING-Ft.) 782451.223 Zone FL W
 Convergence 0-10-33.56563164 Scale factor 0.99995946
 Coordinate determination (circle one): Field traverse GPS
 Horizontal datum (circle one): NAD27 NAD83(1986) NAD83(1990) other (explain)
 Accuracy (circle one): 1st 2nd 3rd other _____

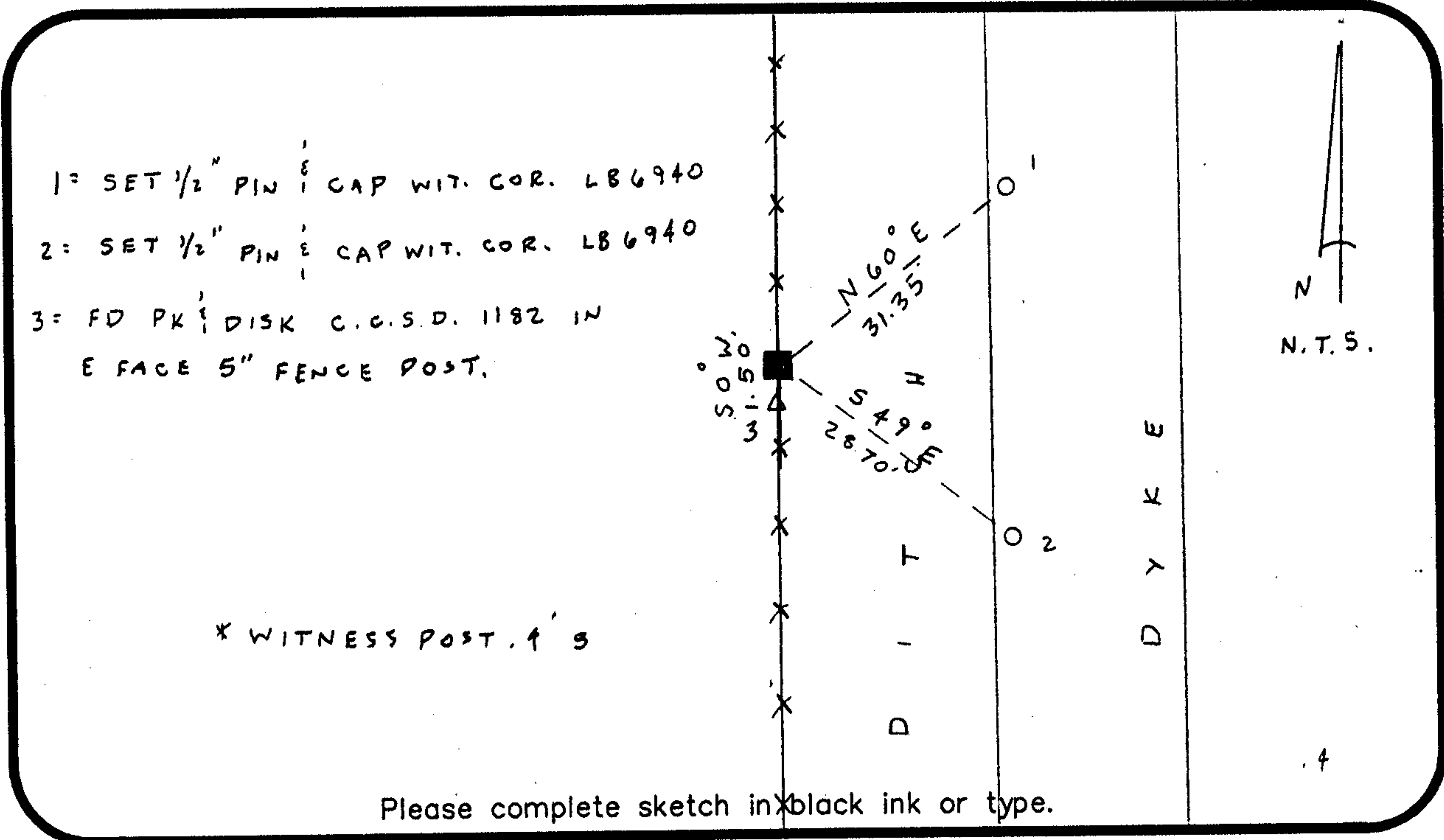

Please complete sketch in black ink or type.

SURVEYORS CERTIFICATE:

I certify the monument and accessories indicated above were field located on July 11, 2003

[Signature] 5949
SIGNATURE PSM NO.
 Barraco and Associates, Inc. LB 6940
FIRM OR AGENCY LB NO.
 2271 McGregor Boulevard
ADDRESS
 Fort Myers FL 33902-2800
CITY STATE ZIP
 (239) 461-3170 8/11/2003
PHONE NUMBER DATE

EMBOSSSED SEAL OVER SIGNATURE

SEND ORIGINAL TO:
 Department of Environmental Protection
 Bureau of Surveying and Mapping
 3900 Commonwealth Boulevard
 Mail Station 105
 Tallahassee, Florida 32399

D.E.P. USE ONLY
 Processed: 9-23-2003 CH
 B.L.M. - I.D. 400 400
 QUAD - I.D. 2413 Telegraph Swamp NE

7
120
131
29