

# FLORIDA DEPARTMENT OF ENVIRONMENTAL PROTECTION

## CERTIFIED CORNER RECORD

079905

DOC. # \_\_\_\_\_

**CORNER DESCRIPTION:**      **MONUMENTATION DESCRIPTION (EVIDENCE FOUND OR METHOD TO SET)**

Depict corner with  ●

Found 3" Dia. Round Concrete Monument with Brass Plate stamped with

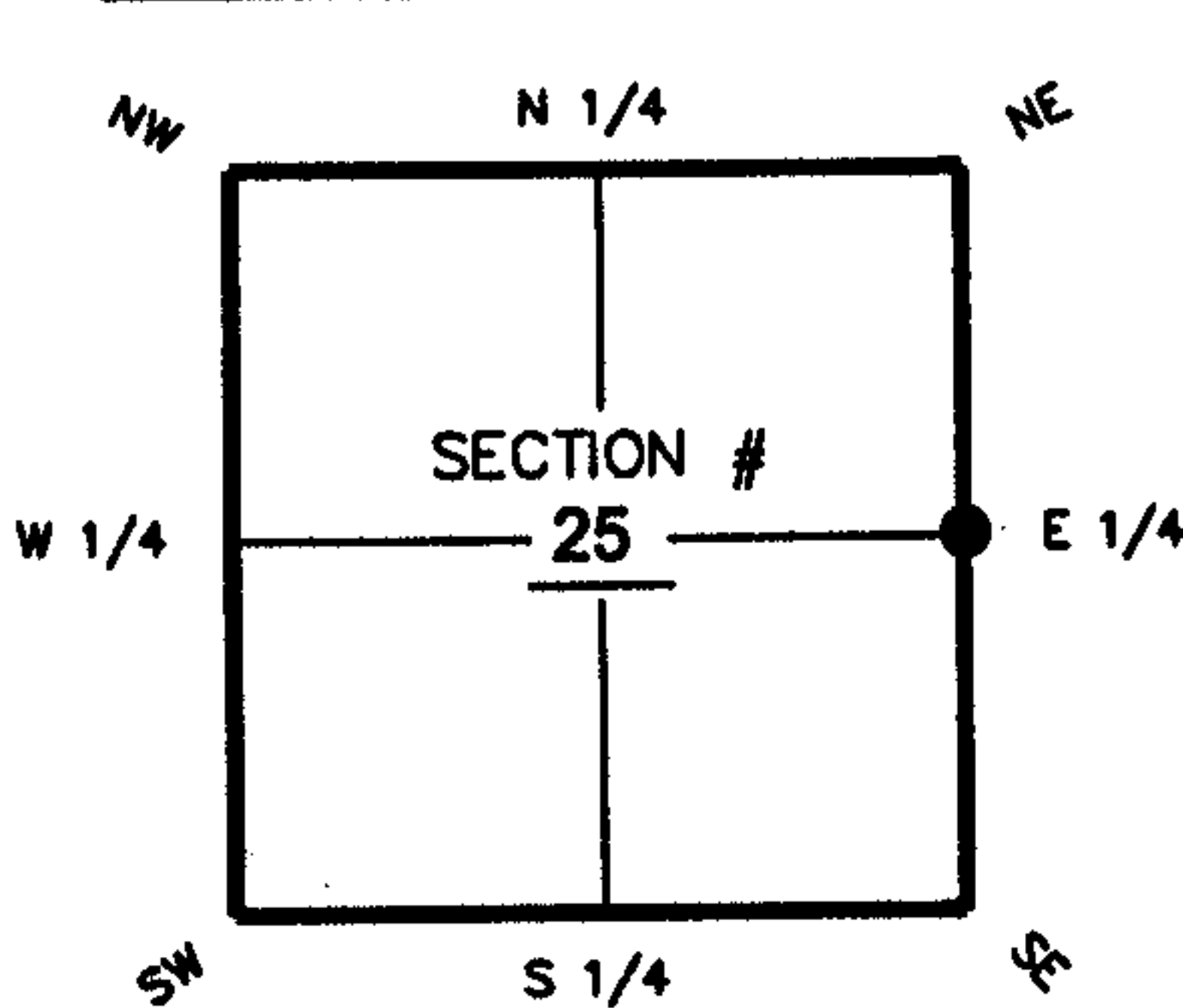

T40S

R		R
27		28
E		E

E 1/4 corner of Section 25  
Twp. 40 S, Rge 27 E  
Tallahassee Base Meridian,  
Charlotte County(s), Florida

**HORIZONTAL POSITION INFORMATION ( If determined ):**

Latitude 26-58-01.7151 N      Longitude 81-33-46.1241 W  
 Y(NORTHING-Ft.) 957474.148      X(EASTING-Ft.) 798565.735      Zone FL W  
 Convergence 0-11-53.73157984      Scale factor 0.99996442  
 Coordinate determination (circle one):      Field traverse  GPS  
 Horizontal datum (circle one):      NAD27      NAD83(1986)       NAD83(1990)      other (explain)  
 Accuracy (circle one):      1st       2nd      3rd      other \_\_\_\_\_

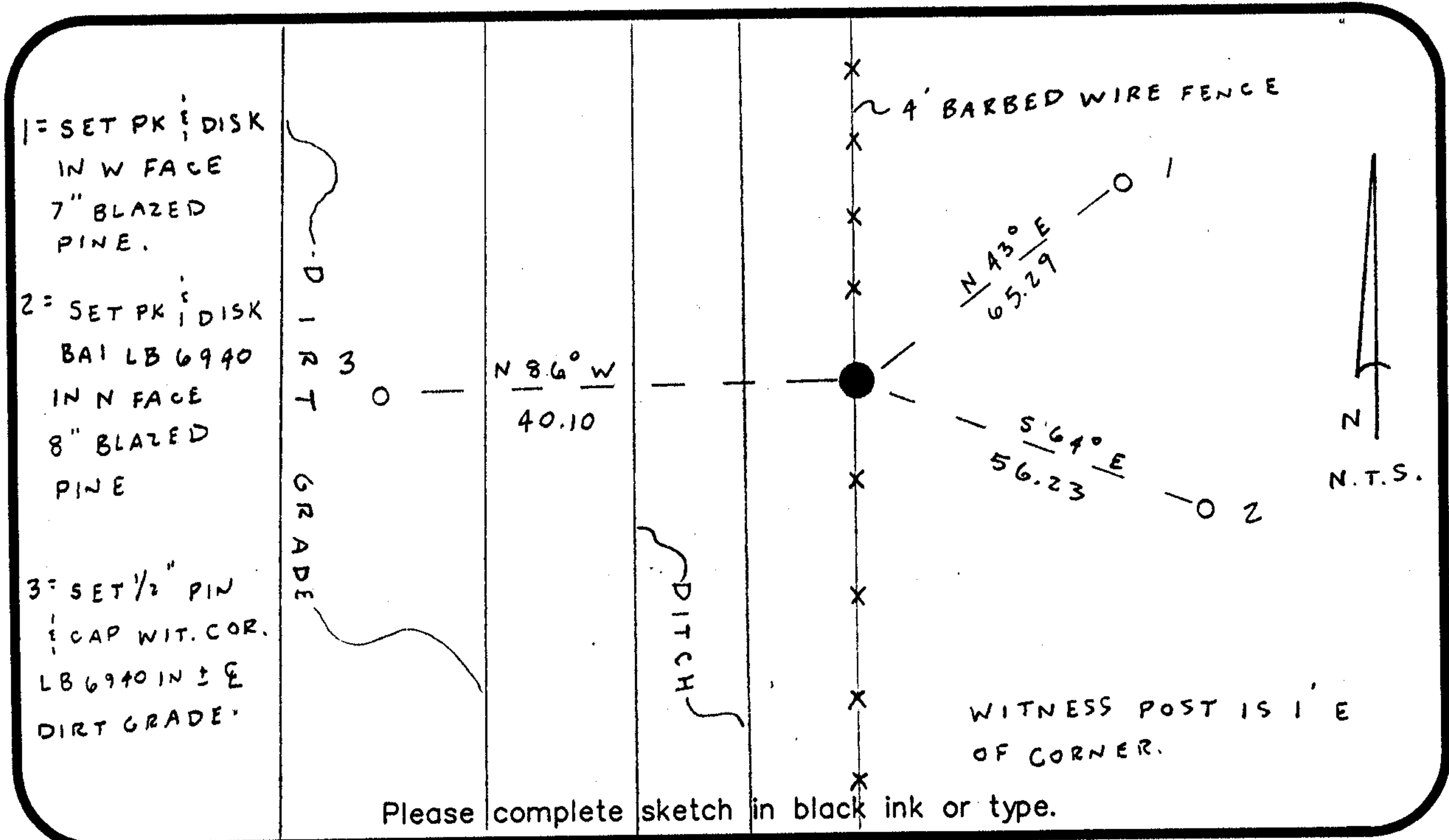

Please complete sketch in black ink or type.

**SURVEYORS CERTIFICATE:**

I certify the monument and accessories indicated above were field located on July 11, 2003

*Sara A. Barraco*      5949  
 SIGNATURE      PSM NO.  
 Barraco and Associates, Inc.      LB 6940  
 FIRM OR AGENCY      LB NO.  
 2271 McGregor Boulevard  
 ADDRESS  
 Fort Myers, FL 33902-2800  
 CITY      STATE      ZIP  
 (239) 461-3170      8/11/2003  
 PHONE NUMBER      DATE

SEND ORIGINAL TO:  
 Department of Environmental Protection  
 Bureau of Surveying and Mapping  
 3900 Commonwealth Boulevard  
 Mail Station 105  
 Tallahassee, Florida 32399

D.E.P. USE ONLY

Processed: 9-23-2003 CH  
 B.L.M. - I.D. 700 240  
 QUAD - I.D. 2413 Telegraph Swamp NE

EMBOSSSED SEAL OVER SIGNATURE