

FLORIDA DEPARTMENT OF ENVIRONMENTAL PROTECTION CERTIFIED CORNER RECORD

DOC. # 079907

CORNER DESCRIPTION: MONUMENTATION DESCRIPTION (EVIDENCE FOUND OR METHOD TO SET)

Depict corner with Found. 3.5" Dia. Round Concrete Monument with 1/2" Steel Rod in Center

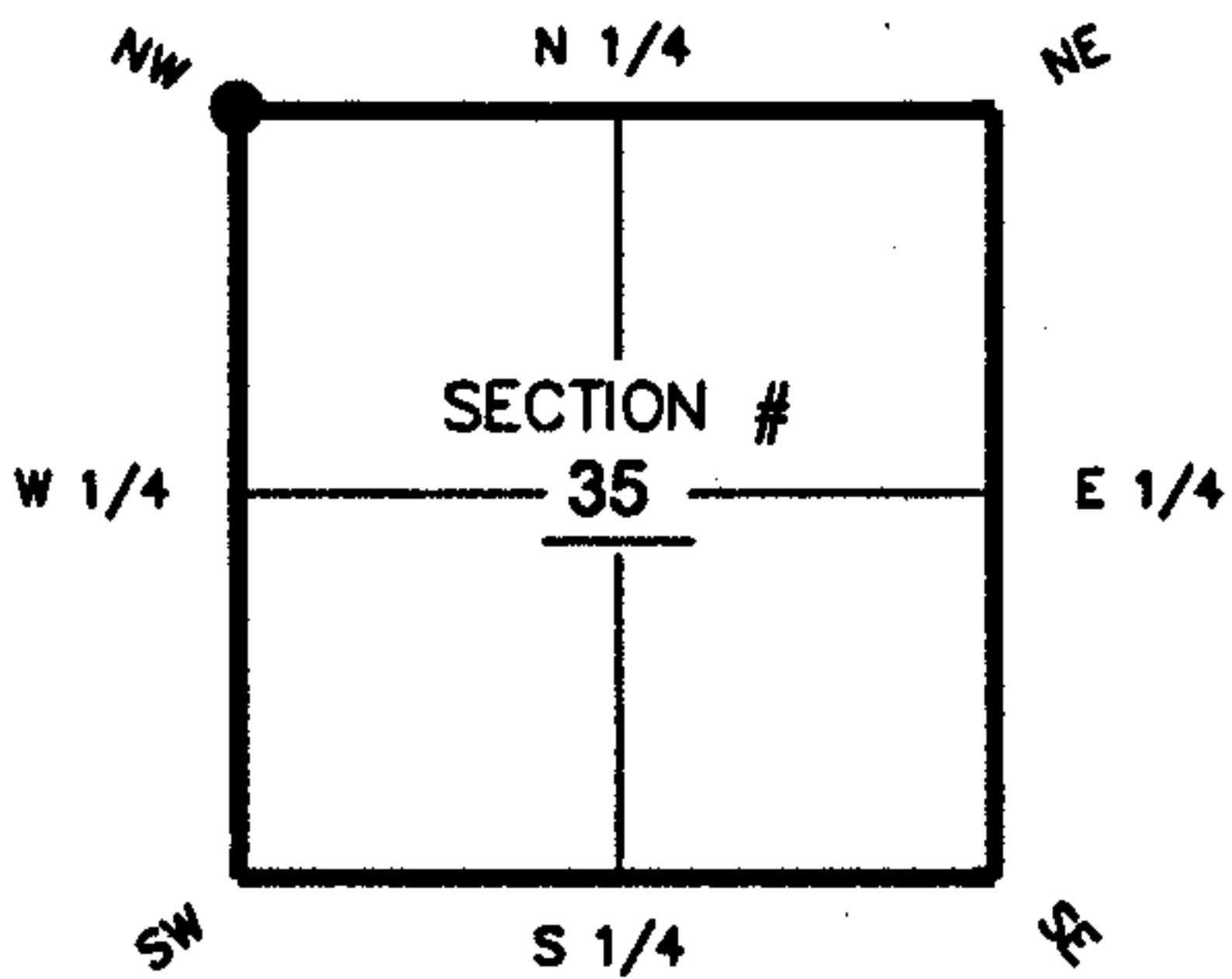

NW corner of Section 35
Twp 40 S, Rge 27 E
Tallahassee Base Meridian,
Charlotte County(s), Florida

HORIZONTAL POSITION INFORMATION (if determined):

Latitude 26-57-34.9424 N Longitude 81-35-44.4703 W
 Y(NORTHING-Ft.) 954735.117 X(EASTING-Ft.) 787866.703 Zone FL W
 Convergence 0-10-59.89327859 Scale factor 0.99996106
 Coordinate determination (circle one): Field traverse GPS
 Horizontal datum (circle one): NAD27 NAD83(1986) NAD83(1990) other (explain)
 Accuracy (circle one): 1st 2nd 3rd other _____

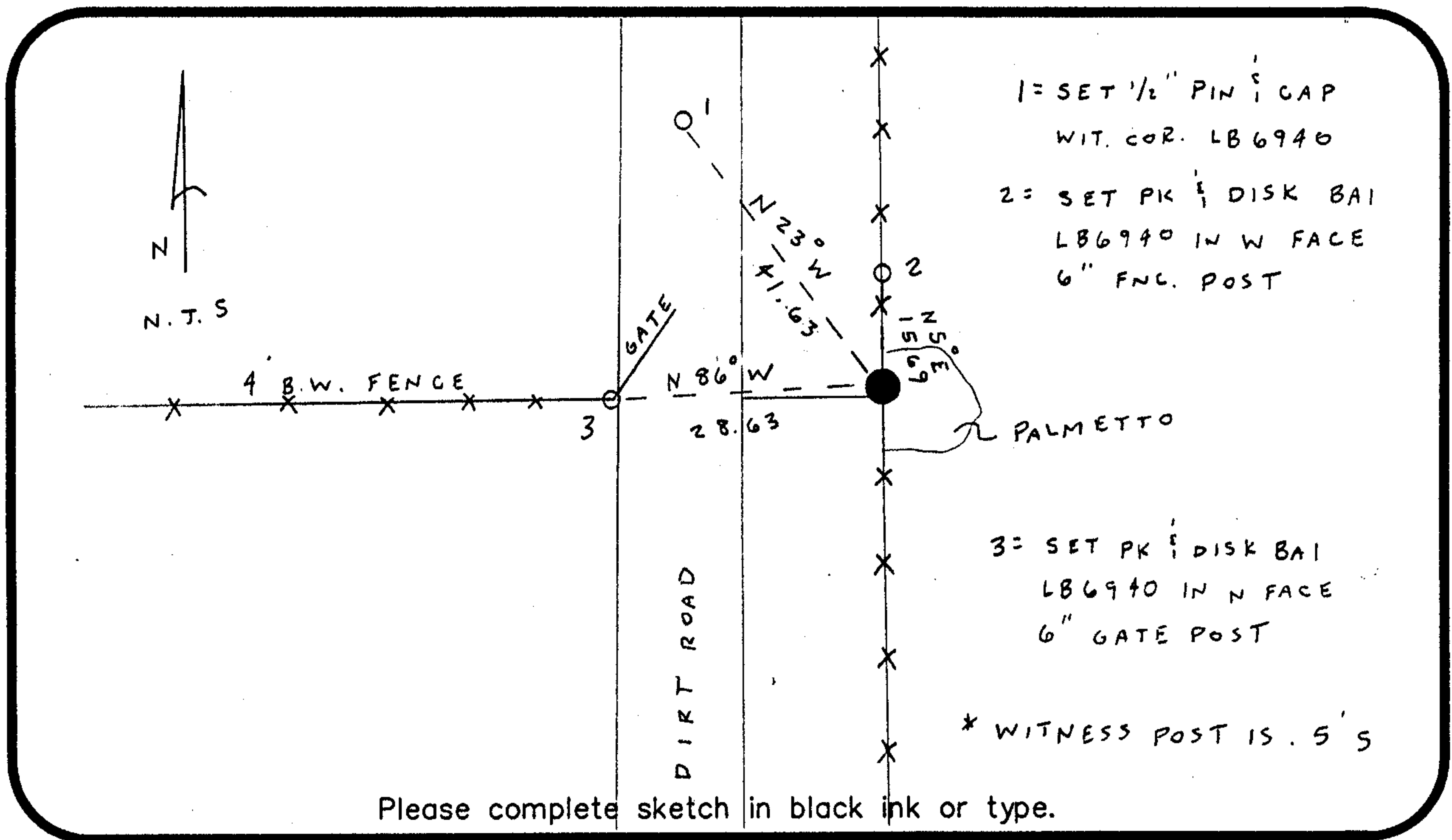

SURVEYORS CERTIFICATE:

I certify the monument and accessories indicated above were field located on July 11, 2003

Sara A. Wheeler 5949
 SIGNATURE PSM NO.
 Barraco and Associates, Inc. LB 6940
 FIRM OR AGENCY LB NO.
 2271 McGregor Boulevard
 ADDRESS
 Fort Myers FL 33902-2800
 CITY STATE ZIP
 (239) 461-3170 8/11/2003
 PHONE NUMBER DATE

EMBOSSSED SEAL OVER SIGNATURE

SEND ORIGINAL TO:
 Department of Environmental Protection
 Bureau of Surveying and Mapping
 3900 Commonwealth Boulevard
 Mail Station 105
 Tallahassee, Florida 32399

D.E.P. USE ONLY
 Processed: 9-23-2003 CH
 B.L.M. - I.D. 500 200
 QUAD - I.D. 2413 Telegraph Swamp NE