

FLORIDA DEPARTMENT OF ENVIRONMENTAL PROTECTION CERTIFIED CORNER RECORD

079910

DOC. # _____

CORNER DESCRIPTION: MONUMENTATION DESCRIPTION (EVIDENCE FOUND OR METHOD TO SET)

Depict corner with Found 3"x3" Concrete Monument with 1/4" Steel Rod in center

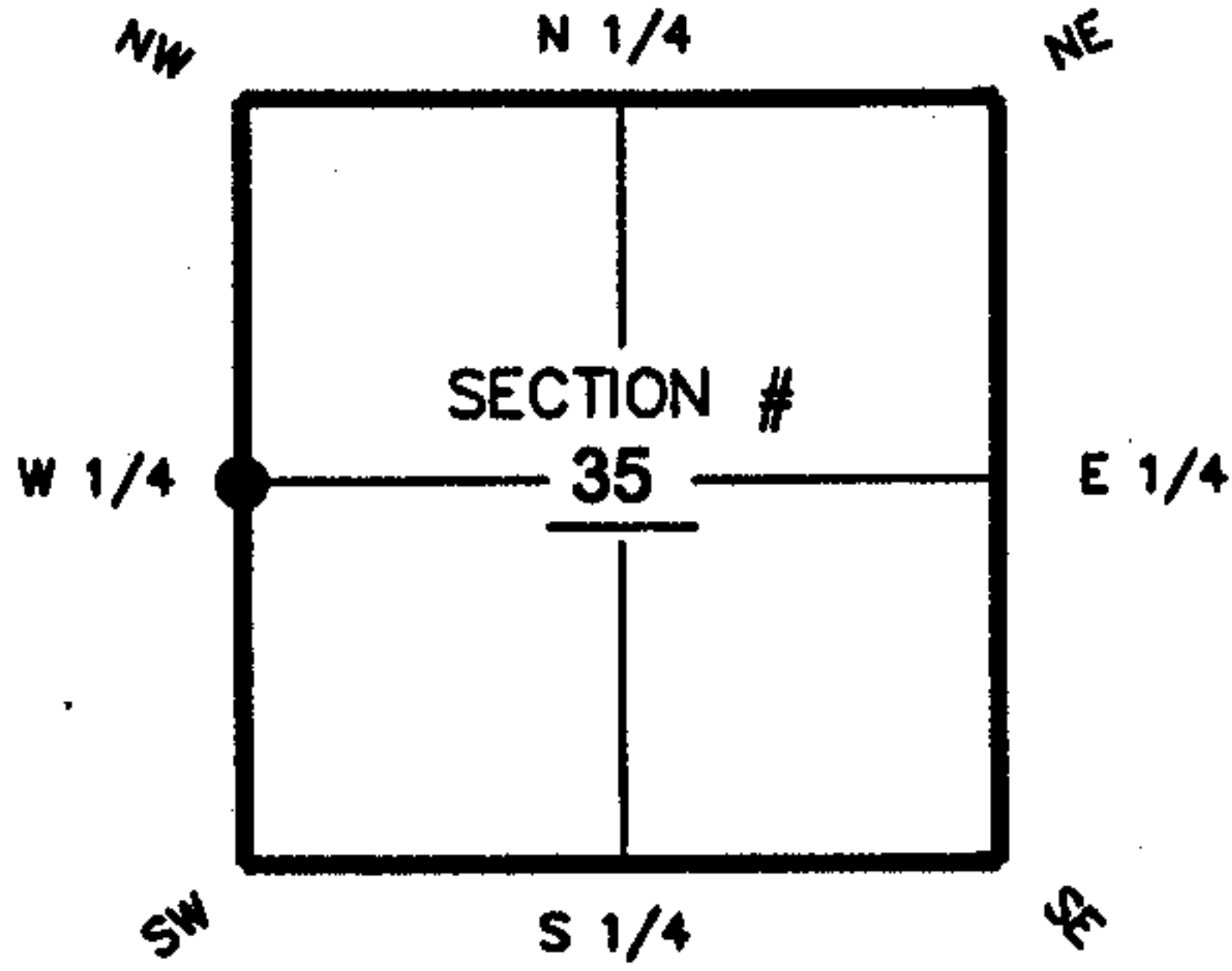

W 1/4 corner of Section 35
Twp 40 S, Rge 27 E
Tallahassee Base Meridian,
Charlotte County(s), Florida

HORIZONTAL POSITION INFORMATION (if determined):

Latitude 26-57-08.7905 N Longitude 81-35-44.9355 W
 Y(NORTHING-Ft.) 952094.298 X(EASTING-Ft.) 787833.060 Zone FL W
 Convergence 0-10-59.51795012 Scale factor 0.99996105
 Coordinate determination (circle one): Field traverse GPS
 Horizontal datum (circle one): NAD27 NAD83(1986) NAD83(1990) other (explain)
 Accuracy (circle one): 1st 2nd 3rd other _____

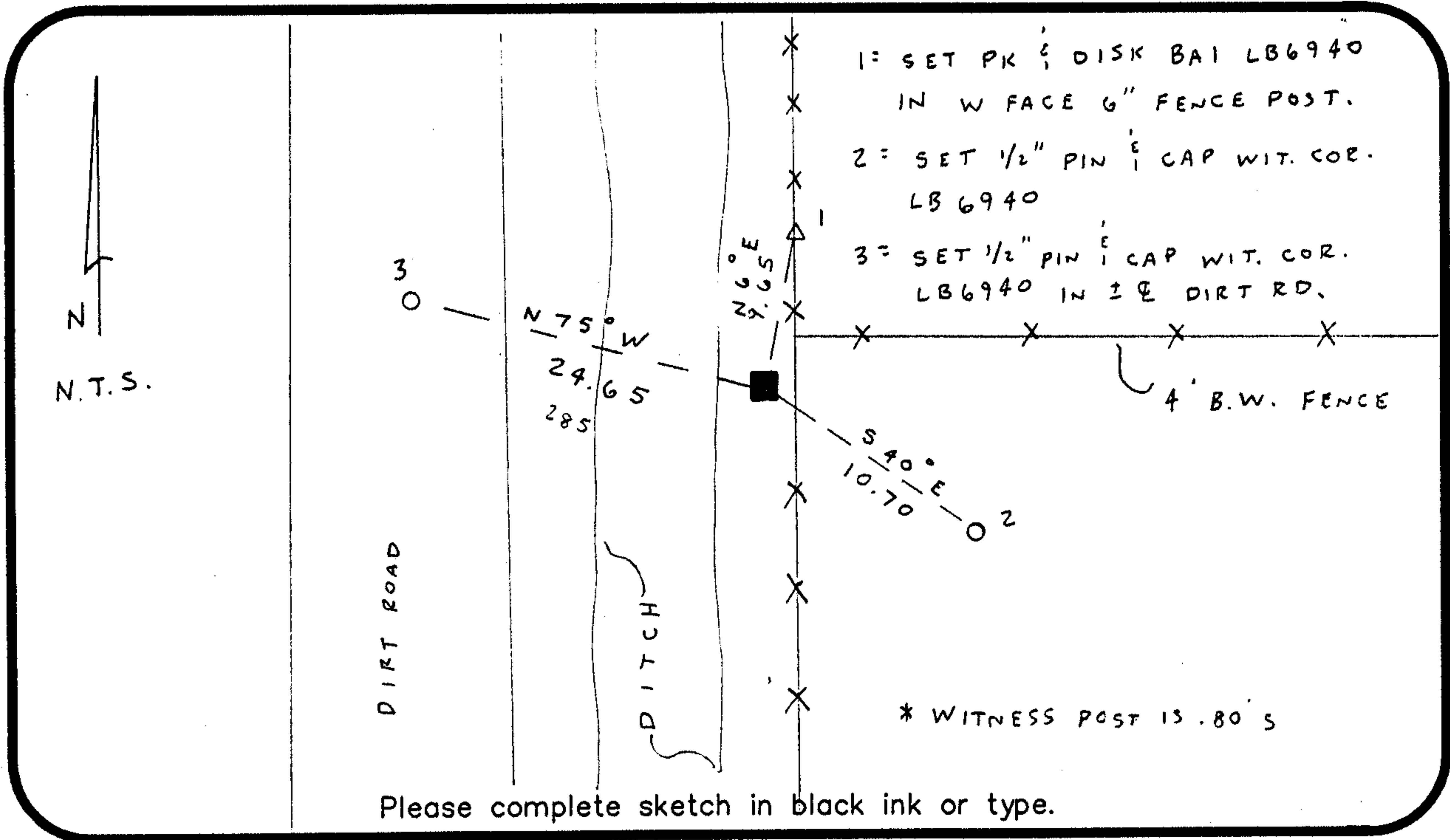

Please complete sketch in black ink or type.

SURVEYORS CERTIFICATE:

I certify the monument and accessories indicated above were field located on July 11, 2003

[Signature] 5949
 SIGNATURE PSM NO.
Barraco and Associates, Inc. LB 6940
 FIRM OR AGENCY LB NO.
 2271 McGregor Boulevard
 ADDRESS
 Fort Myers FL 33902-2800
 CITY STATE ZIP
 (239) 461-3170 8/11/2003
 PHONE NUMBER DATE

EMBOSSSED SEAL OVER SIGNATURE

SEND ORIGINAL TO:
 Department of Environmental Protection
 Bureau of Surveying and Mapping
 3900 Commonwealth Boulevard
 Mail Station 105
 Tallahassee, Florida 32399

D.E.P. USE ONLY
 Processed: 9-23-2003 CH
 B.L.M. - I.D. 500 140
 QUAD - I.D. 2413 Telegraph Swamp NE