

4120A07

**FLORIDA DEPARTMENT OF ENVIRONMENTAL PROTECTION
CERTIFIED CORNER RECORD**

CORNER DESCRIPTION:

N. 1/4 corner of Section 05,
Twp 41 S., Rge 20 E.,
Tallahassee Base Meridian,
CHARLOTTE County(s), Florida.

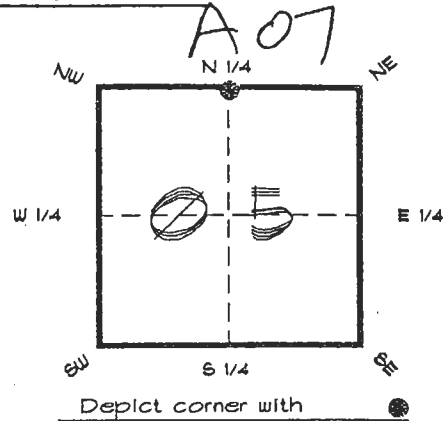

MONUMENTATION DESCRIPTION:

Describe original monument and accessories, or subsequent restoration. Give sources of information. (If no attempt was made to search for the original monument and accessories, this information is not necessary.)

Description of corner evidence found:

3" CAST IRON PIPE

State method(s) to determine corner location (lost corners only):

HORIZONTAL POSITION INFORMATION (if determined):

Latitude 26°56'44.76464" N Longitude 82°19'44.76488" W
Y(Northing) 289437.856 m X(Easting) 167321.242 m Zone FLW
Convergence -0°08'56.877" Scale factor 0.99995435

Coordinate determination (circle one): Field traverse GPS

Horizontal datum (circle one): NAD27 NAD83(1986) NAD83(1990) other (explain)

Order of accuracy as defined in Standards and Specifications for Geodetic Control Networks published by the Federal Geodetic Control Committee (circle one):
1st, 2nd, 3rd, class _____

or Minimum Technical Standards (Chapter 6IG17, F.A.C.) ratio of closure for field data (example 1:10,000), _____. This does not specify an order of accuracy.

Control point(s) used for survey: CHARLOTTE COUNTY HORIZONTAL CONTROL NETWORK INCLUDES HAYOLINE 2, PLACIDA 2, W260, PUNTPORT, & FLGPS 58 AS B ORDER STATIONS.

Comments:

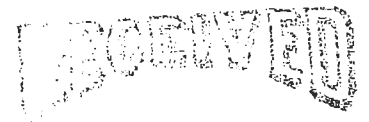

SEP 12 1994

0049742

4120A07

DOC. #

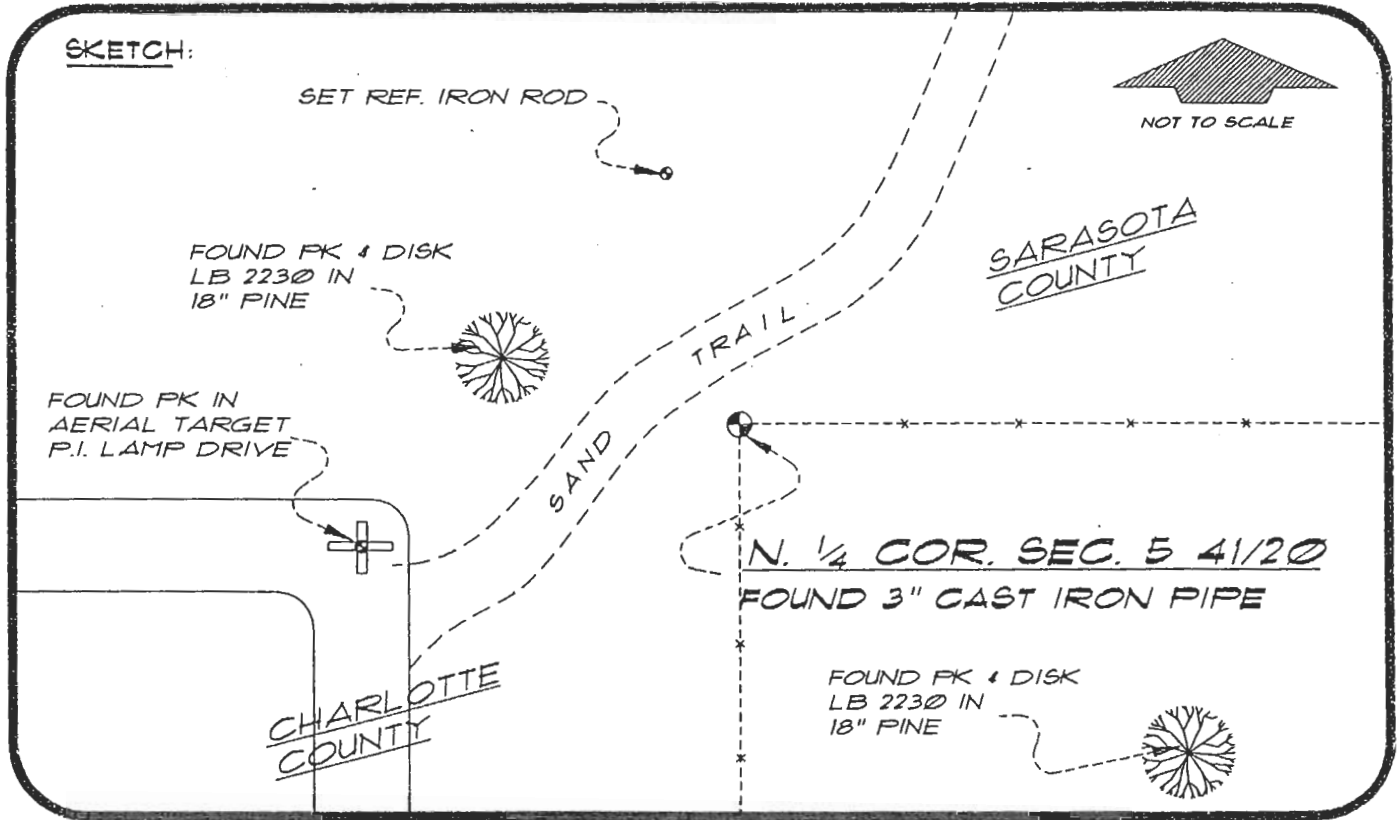

BASIS OF BEARING SOLAR OBSERVATION REFER: FB 281/62
 SET SURVEY MARKER POST 3.0' N'LY

REFERENCE MEASUREMENTS

Description	Bearing	Distance
FD. PK & DISK LB 2230	S 54°16'58" E	97.89'
FD. PK & DISK LB 2230	N 71°13'17" W	34.20'
FD. PK IN AERIAL TARGET	S 69°43'24" W	75.96'
SET REF. IRON ROD	N 11°24'51" W	46.08'

SURVEYORS CERTIFICATE: I certify the monument and accessories indicated above were field located on AUGUST 31, 1994

R. P. Rose
 SIGNATURE

PLS 4260

September 7, 1994
 DATE

CHARLOTTE COUNTY SURVEY DEPT.
 FIRM OR AGENCY

1000 FLORIDA STREET
 ADDRESS

PUNTA GORDA, FLORIDA 33950
 CITY STATE

511



Completeness checked by: B. J. Linton
 Accepted and filed: 10-3-1994 Date
 B.L.M. - ID. 05CL0032 D.E.P. USE ONLY

SEND TO:

Department of Environmental Protection
 Bureau of Survey and Mapping
 3900 Commonwealth Boulevard
 Mail Station 105
 Tallahassee, Florida 32399