

4120A09

FLORIDA DEPARTMENT OF NATURAL RESOURCES  
CERTIFIED CORNER RECORD

A 09

CORNER DESCRIPTION:

N.W. corner of Section 4,  
Twp 41 S., Rge 20,  
Tallahassee Base Meridian,

CHARLOTTE County(s), Florida.  
SARASOTA

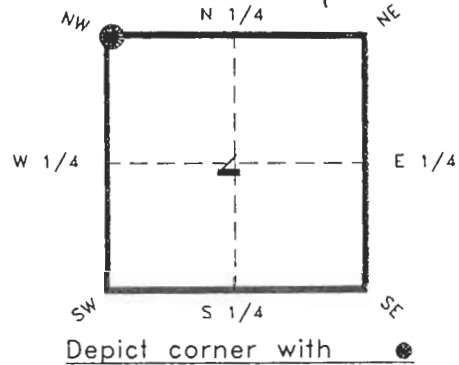

MONUMENTATION DESCRIPTION:

Describe original monument and accessories, or subsequent restoration. Give sources of information. (If no attempt was made to search for the original monument and accessories, this information is not necessary.)

Description of corner evidence found:

SARASOTA COUNTY CONCRETE MONUMENT (5"X 5") WITH DISK

State method(s) to determine corner location (lost corners only):

HORIZONTAL POSITION INFORMATION ( if determined ):

Latitude 26°56'44.48952"N Longitude 82°19'15.31587"W

Y(Northing) 289427.300(M) X(Easting) 168133.502(M) Zone FL W

Convergence -0°08'43.531" Scale factor 0.99995371

Coordinate determination (circle one): Field traverse GPS

Horizontal datum (circle one): NAD27 NAD83(1986) NAD83(1990) other (explain)

Order of accuracy as defined in "Standards and Specifications for Geodetic Control Networks" published by the Federal Geodetic Control Committee (circle one):  
1st 2nd, 3rd, class 1

or Minimum Technical Standards (Chapter 21HH-6, F.A.C.) ratio of closure for field data (example 1:10,000), . This does not specify an order of accuracy.

Control point(s) used for survey:

Comments:

RECEIVED  
JAN 31 1995

SURVEY & MAPPING

DNR 53-001(16)  
REV: 7/16/92  
PAGE 1 OF 2

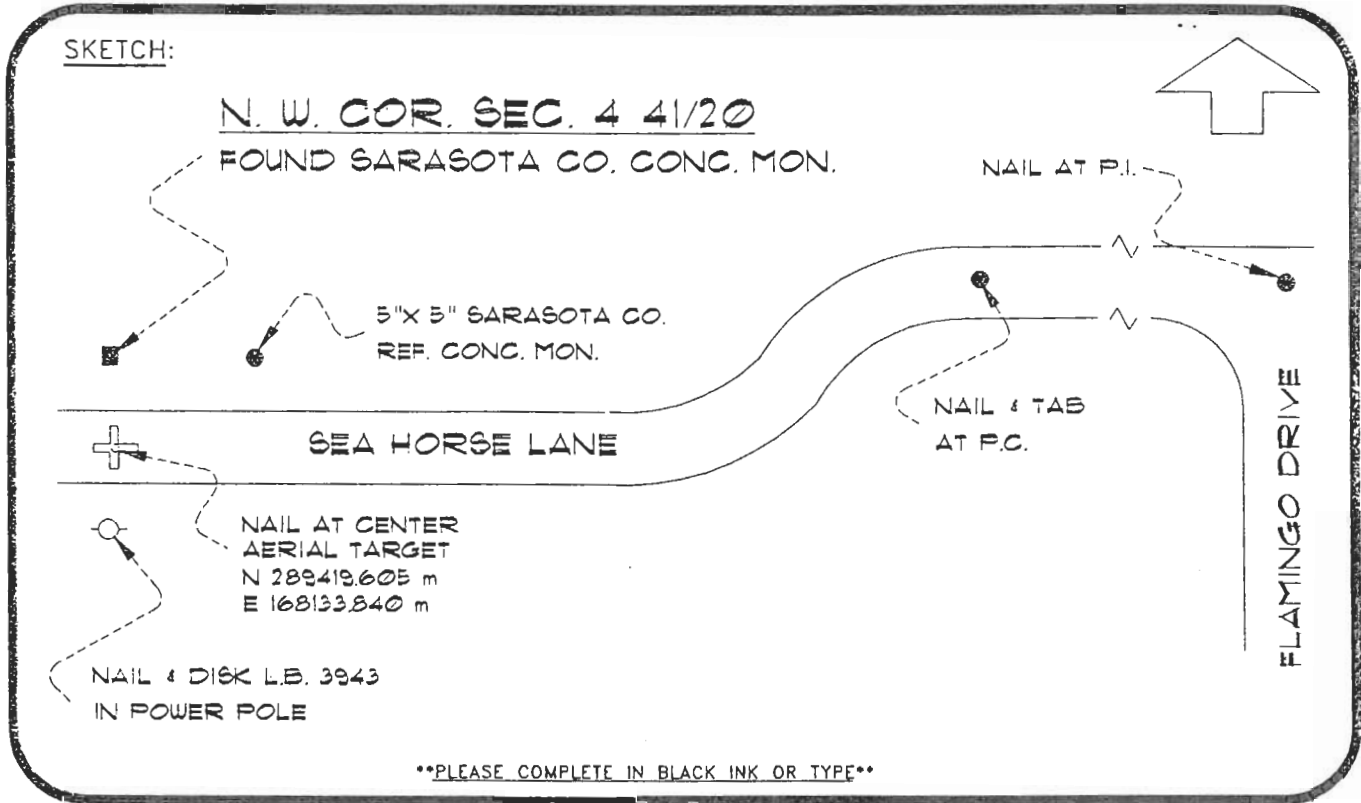

\*\*PLEASE COMPLETE IN BLACK INK OR TYPE\*\*

SET SURVEY MARKER POST 3.0' N.'LY REFER: F.B. 281-23

All bearings and distances must be from the corner to the witness. Indicate whether corner was found, set, or replaced and show north arrow.

BASIS OF BEARING-SOLAR OBSERVATION (TRUE)

REFERENCE MEASUREMENTS ( at least three vicinity references must be given below even if they appear on the above sketch ):

Description	Bearing	Distance
5"X 5" SARASOTA CO. REF. MON.	S88°43'48"E.	38.95'
NAIL AT CENTER AERIAL TARGET	S02°39'43"E.	25.27'
NAIL & DISK L.B. 3943 IN POWER POLE	S01°24'19"W.	47.71'
NAIL & TAB AT P.C.	N84°56'32"E.	241.44'
NAIL AT P.I.	N89°20'07"E.	1045.34'

SURVEYORS CERTIFICATE: I certify the monument and accessories indicated above were field located on JANUARY 3, 19 95.

*[Signature]* PLS 4260

SIGNATURE

1/30/95

DATE

CHARLOTTE COUNTY SURVEY DEPT.

FIRM OR AGENCY

7000 FLORIDA STREET

ADDRESS

PUNTA GORDA, FLA. 33950

CITY

STATE

511

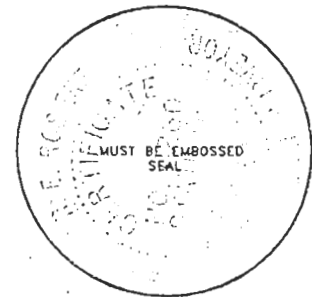

SEND TO:

Department of Natural Resources  
Bureau of Survey and Mapping  
3900 Commonwealth Boulevard  
Mail Station 105  
Tallahassee, Florida 32399

DNR 53-001(16)  
REV. 7/16/92  
PAGE 2 OF 2

Completeness checked by: *[Signature]*

Accepted and filed: 3-1-95 Date

B.L.M. - I.D. 05323304 D.N.R. USE ONLY