

FLORIDA DEPARTMENT OF NATURAL RESOURCES
CERTIFIED CORNER RECORD

A-25

CORNER DESCRIPTION:

NE corner of Section 1 ,
Twp 41 S , Rge 20 E ,
Tallahassee Base Meridian,
Charlotte County(s), Florida.

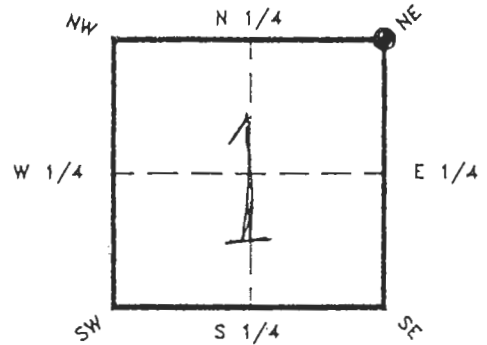

Depict corner with ●

MONUMENTATION DESCRIPTION:

Describe original monument and accessories, or subsequent restoration. Give sources of information. (If no attempt was made to search for the original monument and accessories, this information is not necessary.)

Description of corner evidence found:
*FOUND CHARLOTTE COUNTY CONCRETE
MONUMENT IN WELL BOX*

State method(s) to determine corner location (lost corners only):

HORIZONTAL POSITION INFORMATION (if determined):

Latitude _____ Longitude _____

Y(Northing) _____ X(Easting) _____ Zone _____

Convergence _____ Scale factor _____

Coordinate determination (circle one): Field traverse GPS

Horizontal datum (circle one): NAD27 NAD83(1986) NAD83(1990) other (explain)

Order of accuracy as defined in "Standards and Specifications for Geodetic Control Networks" published by the Federal Geodetic Control Committee (circle one):
1st, 2nd, 3rd, class _____ ,

or Minimum Technical Standards (Chapter 21HH-6, F.A.C.) ratio of closure for field data (example 1:10,000), _____ . This does not specify an order of accuracy.

Control point(s) used for survey:

Comments:

RECEIVED

JUL 28 1993

SURVEY & MAPPING

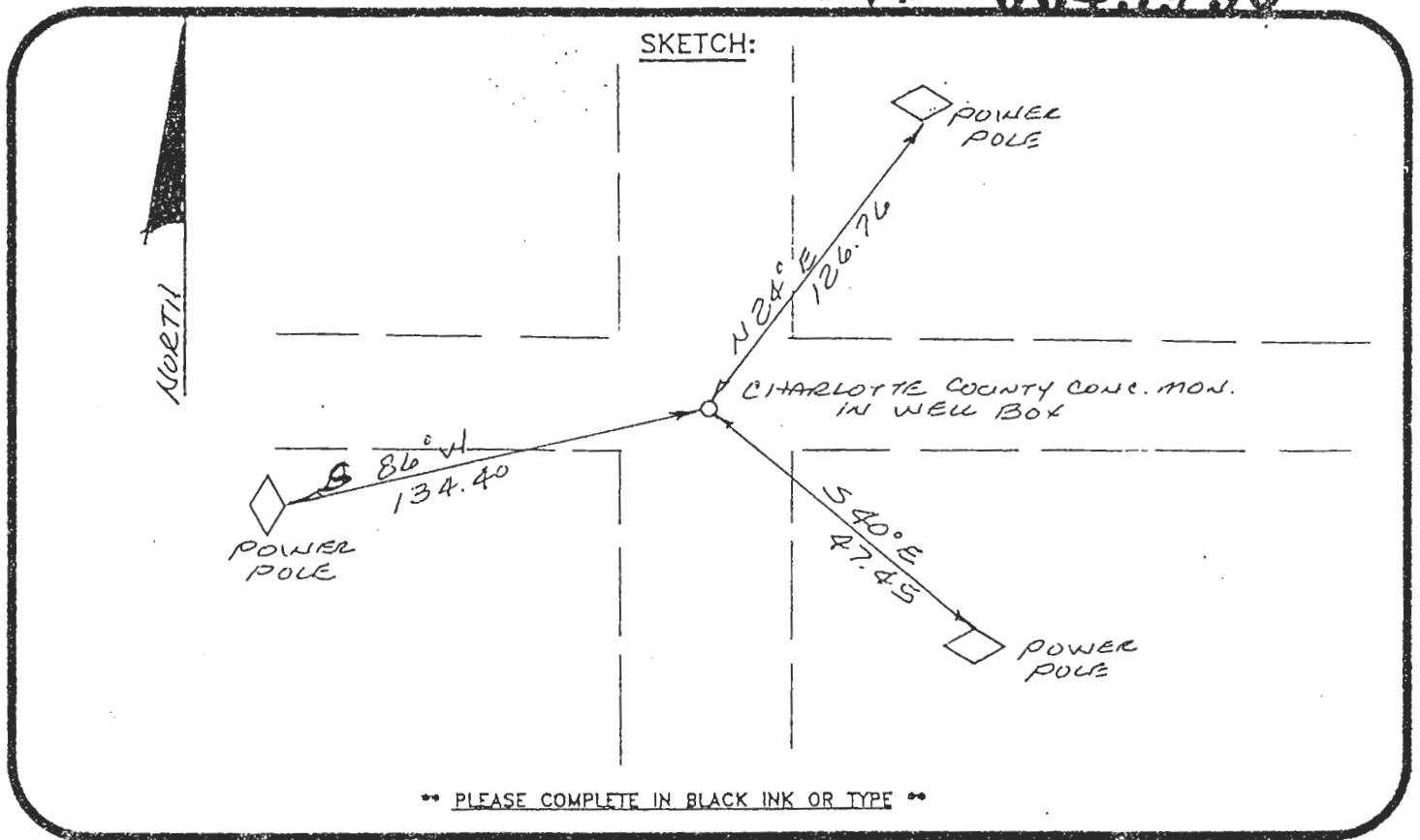

All bearings and distances must be from the corner to the witness. Indicate whether corner was found, set, or replaced and show north arrow.

REFERENCE MEASUREMENTS (at least three vicinity references must be given below even if they appear on the above sketch):

| Description | Bearing | Distance |
|---------------------------|---------|----------|
| NAIL & DISC IN POWER POLE | N 24° E | 126.76 |
| " " " " " | S 40° E | 47.45 |
| " " " " " | S 86° W | 134.40 |

SURVEYORS CERTIFICATE: I certify the monument and accessories indicated above were field located on February 23, 19 93.

J. R. Brandenburg 2995
SIGNATURE PLS. NO.
 June 18, 1993
DATE
 AIM Engineering & Surveying, Inc.
FIRM OR AGENCY L.B. NO.
 P. O. Box 1235
ADDRESS
 Lehigh Acres, FL 33970
CITY STATE



Completeness checked by: DR Green
 Accepted and filed: 8-93
Date
 B.L.M. - I.D. 01363106 D.N.R. USE ONLY

SEND TO:
 Department of Natural Resources
 Bureau of Survey and Mapping
 3900 Commonwealth Boulevard
 Mail Station 105
 Tallahassee, Florida 32399

DNR 53-001(16)
 REY. 7/16/92
 PAGE 2 OF 2