

FLORIDA DEPARTMENT OF NATURAL RESOURCES  
CERTIFIED CORNER RECORD

C-25

CORNER DESCRIPTION:

EAST 1/4 corner of Section 1 ,  
Twp 41 S , Rge 20 E ,  
Tallahassee Base Meridian,  
Charlotte County(s), Florida.

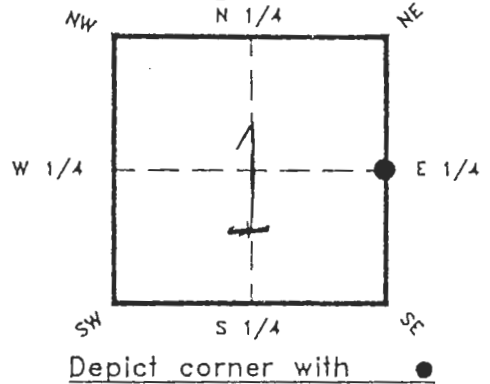

MONUMENTATION DESCRIPTION:

Describe original monument and accessories, or subsequent restoration. Give sources of information. (If no attempt was made to search for the original monument and accessories, this information is not necessary.)

Description of corner evidence found:

State method(s) to determine corner location (lost corners only):

*SET 5/8" IRON ROD WITH AIM ENCL. CAP.  
GOVERNMENT NOTES & PLAT  
SINGLE PROPORTION MEASUREMENT.*

HORIZONTAL POSITION INFORMATION ( if determined ):

Latitude \_\_\_\_\_ Longitude \_\_\_\_\_

Y(Northing) \_\_\_\_\_ X(Easting) \_\_\_\_\_ Zone \_\_\_\_\_

Convergence \_\_\_\_\_ Scale factor \_\_\_\_\_

Coordinate determination (circle one):                      Field traverse                      GPS

Horizontal datum (circle one):    NAD27    NAD83(1986)    NAD83(1990)    other (explain)

Order of accuracy as defined in "Standards and Specifications for Geodetic Control Networks" published by the Federal Geodetic Control Committee (circle one):

1st, 2nd, 3rd, class \_\_\_\_\_ ,

or Minimum Technical Standards (Chapter 21HH-6, F.A.C.) ratio of closure for field data (example 1:10,000), \_\_\_\_\_ . This does not specify an order of accuracy.

Control point(s) used for survey:

Comments:

**RECEIVED**

JUL 28 1993

SURVEY & MAPPING

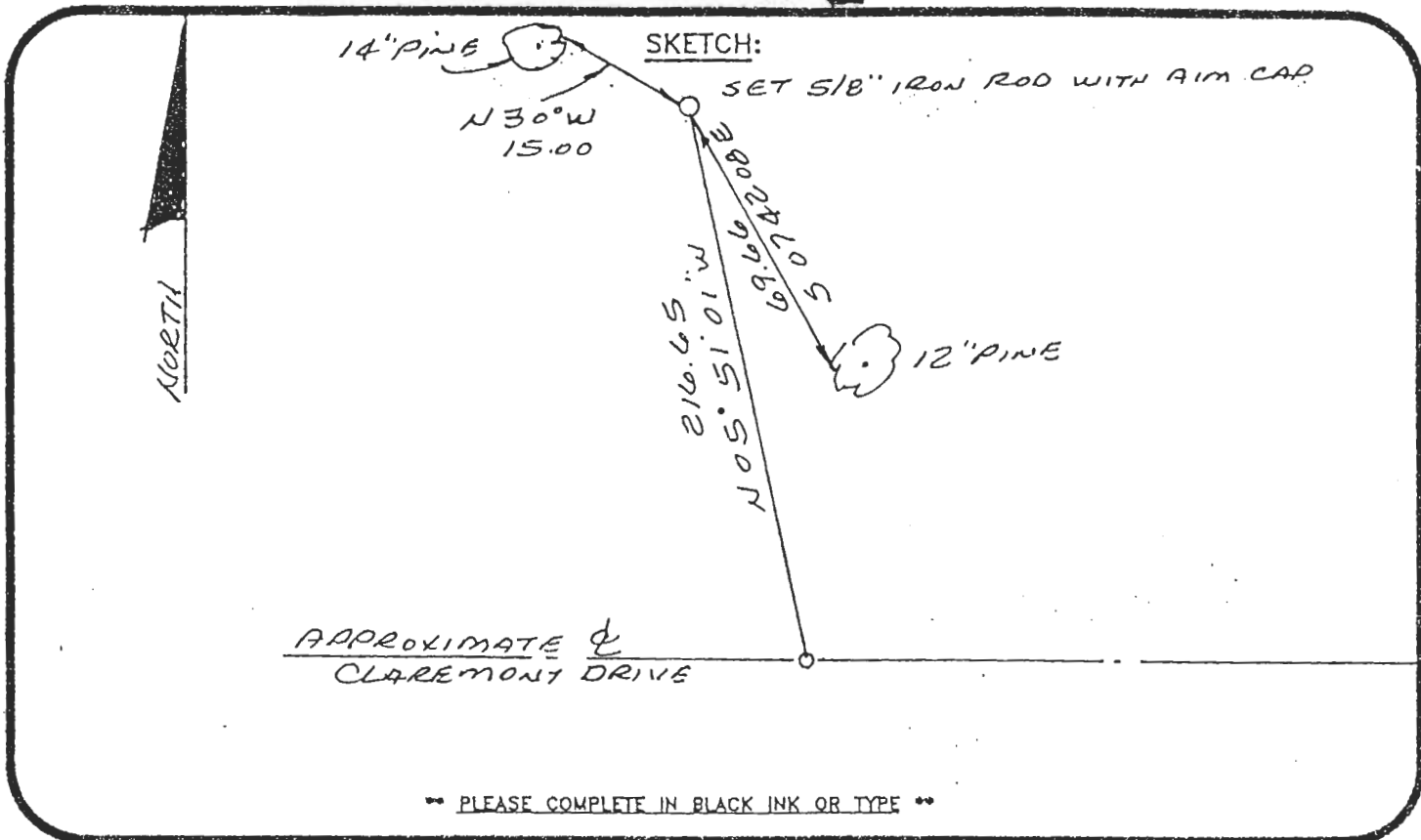

PLEASE COMPLETE IN BLACK INK OR TYPE

All bearings and distances must be from the corner to the witness. Indicate whether corner was found, set, or replaced and show north arrow.

REFERENCE MEASUREMENTS ( at least three vicinity references must be given below even if they appear on the above sketch ):

Description	Bearing	Distance
14" PINE	N 30° W	15.00
12" PINE	S 87 42 08 E	69.66
C/L CLAREMONT DRIVE	N 05 51' 01" W	216.65

SURVEYORS CERTIFICATE: I certify the monument and accessories indicated above were field located on February 23, 19 93.

J. R. Brandenburg 2995  
SIGNATURE PLS. NO.  
 June 18, 1993  
DATE  
 AIM Engineering & Surveying, Inc.  
FIRM OR AGENCY L.B. NO.  
 P. O. Box 1235  
ADDRESS  
 Lehigh Acres, FL 33970  
CITY STATE

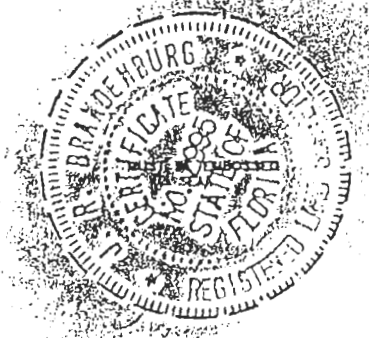

Completeness checked by: [Signature]  
 Accepted and filed: [Signature] Date: 8-9-93  
 B.L.M. - I.D. 0100CLO6 D.N.R. USE ONLY

SEND TO:  
 Department of Natural Resources  
 Bureau of Survey and Mapping  
 3900 Commonwealth Boulevard  
 Mail Station 105  
 Tallahassee, Florida 32399  
 DNR 53-001(16)  
 REV. 7/16/92  
 PAGE 2 OF 2