

4120R13

FLORIDA DEPARTMENT OF ENVIRONMENTAL PROTECTION
CERTIFIED CORNER RECORD

R13

CORNER DESCRIPTION:

S. E. corner of Section 21,
Twp 41 S., Rge 20 E.,
Tallahassee Base Meridian,
CHARLOTTE County(s), Florida.

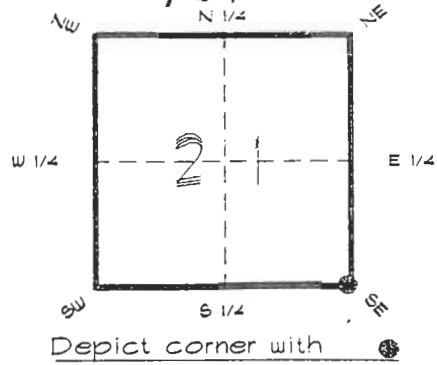

MONUMENTATION DESCRIPTION:

Describe original monument and accessories, or subsequent restoration. Give sources of information. (If no attempt was made to search for the original monument and accessories, this information is not necessary.)

Description of corner evidence found:

ROUND SHELL MONUMENT WITH LEAD DISK " REC 1930"

RECEIVED
JAN 31 1995
SURVEY & MAPPING

State method(s) to determine corner location (lost corners only):

HORIZONTAL POSITION INFORMATION (if determined):

Latitude 26°53'12.51364" N Longitude 82°18'18.58543" W
Y(Northing) 282899.479 m X(Easting) 169682.549 m Zone FL. W.
Convergence -0°08'16.816" Scale factor 0.99995252

Coordinate determination (circle one): Field traverse GPS

Horizontal datum (circle one): NAD27 NAD83(1986) NAD83(1990) other (explain)

Order of accuracy as defined in "Standards and Specifications for Geodetic Control Networks" published by the Federal Geodetic Control Committee (circle one):
1st, 2nd, 3rd, class 1

or Minimum Technical Standards (Chapter 21HH-6, F.A.C.) ratio of closure for field data (example 1:10,000), _____ . This does not specify an order of accuracy.

Control point(s) used for survey: CHARLOTTE COUNTY HORIZONTAL CONTROL NETWORK INCLUDES HAVOLINE 2, PLACIDA 2, W260, PUNTPORT, & FLGPS 58 A5 B ORDER STATIONS.

Comments:

050940

4120R13

DOC. #

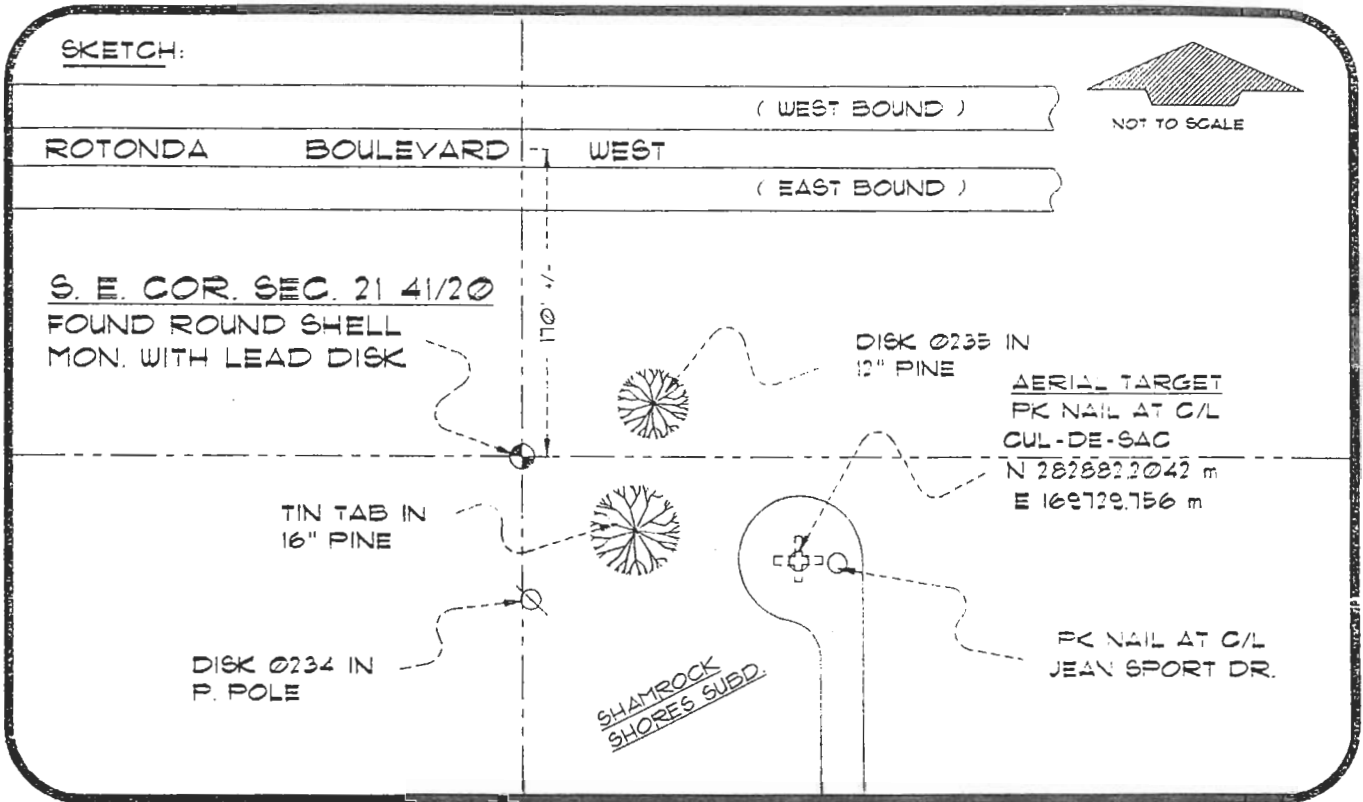

BASIS OF BEARING SOLAR OBSERVATION

REFER: FB 281/34

SET SURVEY MARKER POST 3.0' N'LY

REFERENCE MEASUREMENTS

Description	Bearing	Distance
PK NAIL IN C/L JEAN SPORT DR.	S 72°09'14" E	183.06'
TIN TAB IN 16" PINE	S 58°31'56" E	81.97'
DISK Ø234 IN P. POLE	S 03°48'24" E	78.83'
DISK Ø235 IN 12" PINE	N 65°16'18" E	79.89'
PK NAIL IN AERIAL TARGET	S 70°02'19" E	164.93'

SURVEYORS CERTIFICATE: I certify the monument and accessories indicated above were field located on JUNE 1, 1992

R. Rose

PLS 4260

update 1/17/95

SIGNATURE

1/30/95

DATE

CHARLOTTE COUNTY SURVEY DEPT.

FIRM OR AGENCY

7000 FLORIDA STREET

ADDRESS

PUNTA GORDA, FLA. 33950

CITY

STATE



511

Completeness checked by: *[Signature]*

Accepted and filed: *[Signature]*

BLM - ID. 2021227 Date

DNR USE ONLY

SEND TO:

Department of Environmental Protection
Bureau of Survey and Mapping
3900 Commonwealth Boulevard
Mail Station 105
Tallahassee, Florida 32399