

4121E01

DOC. #

0046990

FLORIDA DEPARTMENT OF NATURAL RESOURCES
CERTIFIED CORNER RECORD

CORNER DESCRIPTION:

S.W. corner of Section 6,
Twp 41 S., Rge 21 E.,
Tallahassee Base Meridian,
CHARLOTTE County(s), Florida.

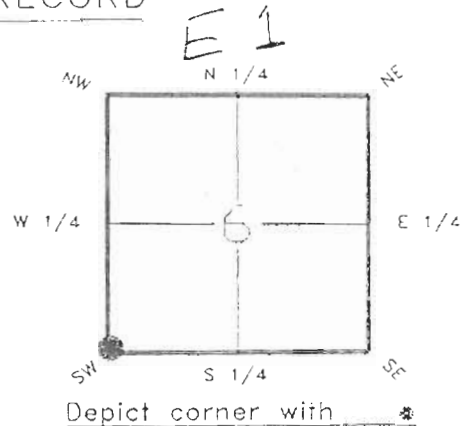

MONUMENTATION DESCRIPTION:

Describe original monument and accessories, or subsequent restoration. Give sources of information. (If no attempt was made to search for the original monument and accessories, this information is not necessary.)

NONE FOUND

Description of corner evidence found:

1 1/2" IRON PIPE (1.0' ABOVE GRADE)

State method(s) to determine corner location (lost corners only):

HORIZONTAL POSITION INFORMATION (if determined):

Latitude 26°55'50.14896" N Longitude 82°15'20.29747" W
Y(Northing) 287740.089 m X(Easting) 174612.545 m Zone FLW
Convergence -0°06'56.815" Scale factor 0.99994913

Coordinate determination (circle one): Field traverse GPS

Horizontal datum (circle one): NAD27 NAD83(1986) NAD83(1990) other (explain)

Order of accuracy as defined in "Standards and Specifications for Geodetic Control Networks" published by the Federal Geodetic Control Committee (circle one):
1st, 2nd, 3rd, class 1,

or Minimum Technical Standards (Chapter 21HH-6, F.A.C.) ratio of closure for field data (example 1:10,000), . This does not specify an order of accuracy.

Control point(s) used for survey:

Comments:

0048990

4121E01

DOC. #

SKETCH:



P.K. NAIL IN 20" PINE TREE



ATOLL AVENUE

S.W. CORNER SEC 6 41/21

FOUND 1 1/2" IRON PIPE (1.0' ABOVE GROUND)

36.8'

P.K. NAIL IN 14" PINE TREE



P.K. NAIL IN 22" PINE TREE

PLEASE COMPLETE IN BLACK INK OR TYPE

BASIS OF BEARING-SOLAR OBSERVATION REFER:F.B. 274-04

All bearings and distances must be from the corner to the witness. Indicate whether corner was found, set, or replaced and show north arrow.

SET SURVEY MARKER POST 1.6' S/LY

REFERENCE MEASUREMENTS (at least three vicinity references must be given below even if they appear on the above sketch):

Description	Bearing	Distance
P.K. NAIL IN 20" PINE TREE	N.67°33'43"E.	274.38'
P.K. NAIL IN 22" PINE TREE	S.55°27'50"E.	48.23'
P.K. NAIL IN 14" PINE TREE	S.39°28'33"W.	28.21'

SURVEYORS CERTIFICATE: I certify the monument and accessories indicated above were field located on May 20, 19 93.

[Signature] PLS 4260
SIGNATURE

10/27/93
DATE

CHARLOTTE COUNTY SURVEY DEPT.
FIRM OR AGENCY

7000 FLORIDA STREET
ADDRESS

PUNTA GORDA, FLA. 33950
CITY STATE

Completeness checked by: B. Hunter
Accepted and filed: 12-1-93 Date
B.L.M. - I.D. 12010607 D.N.R. USE ONLY

511

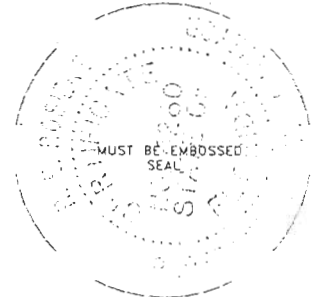

SEND TO:
Department of Natural Resources
Bureau of Survey and Mapping
3900 Commonwealth Boulevard
Mail Station 105
Tallahassee, Florida 32399
DNR 53-001(16)
REV. 7/16/92
PAGE 2 OF 2