

4121E09

DOC. # 0048988

FLORIDA DEPARTMENT OF NATURAL RESOURCES
CERTIFIED CORNER RECORD

E 9

CORNER DESCRIPTION:

S.W. corner of Section 4 ,
Twp 41 S. , Rge 21 E. ,
Tallahassee Base Meridian,
CHARLOTTE County(s), Florida.

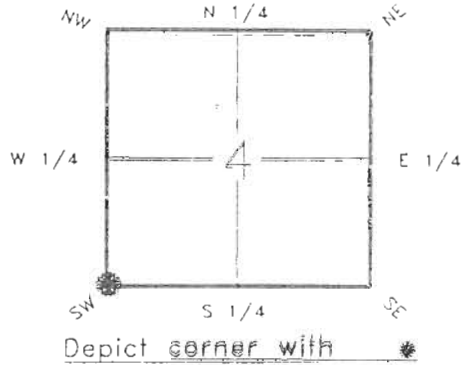

MONUMENTATION DESCRIPTION:

Describe original monument and accessories, or subsequent restoration. Give sources of information. (If no attempt was made to search for the original monument and accessories, this information is not necessary.)

3"X 3" LIGHTERWOOD POST. REPLACED WITH CHARLOTTE COUNTY SURVEY DEPARTMENT 4"X 4" CONCRETE MONUMENT (APPROPRIATE SEC.No.'s STAMPED).

Description of corner evidence found:

State method(s) to determine corner location (lost corners only):

HORIZONTAL POSITION INFORMATION (if determined):

Latitude 26°55'49.94659" N Longitude 82°13'22.61317" W
Y(Northing) 287727.720 m X(Easting) 177859.000 Zone FLW
Convergence -0°06'03.513" Scale factor 0.99994723

Coordinate determination (circle one): Field traverse GPS
Horizontal datum (circle one): NAD27 NAD83(1986) NAD83(1990) other (explain)

Order of accuracy as defined in "Standards and Specifications for Geodetic Control Networks" published by the Federal Geodetic Control Committee (circle one):
1st, 2nd, 3rd, class 1 ,

or Minimum Technical Standards (Chapter 21HH-6, F.A.C.) ratio of closure for field data (example 1:10,000), _____ . This does not specify an order of accuracy.

Control point(s) used for survey:

Comments:

REFER: D.N.R. CERTIFIED CORNER RECORD #0033339

0046688

4121E09

DOC. #

SKETCH:

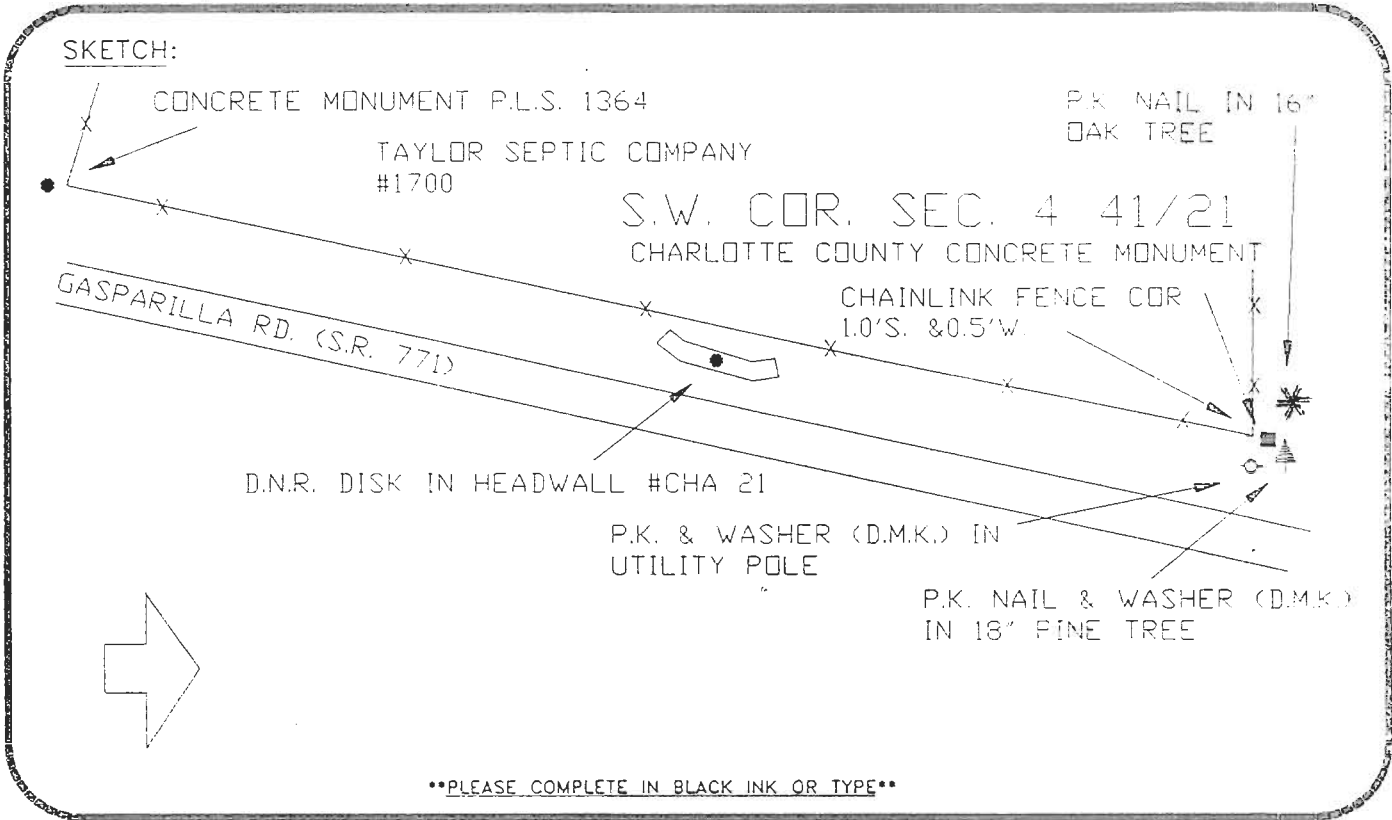

BASIS OF BEARING-SOLAR OBSERVATION REFER:F.B. 274-22

All bearings and distances must be from the corner to the witness. Indicate whether corner was found, set, or replaced and show north arrow.

SET SURVEY MARKER POST 2.0'W/LY

REFERENCE MEASUREMENTS (at least three vicinity references must be given below even if they appear on the above sketch):

| Description | Bearing | Distance |
|--|---------------|----------|
| SET P.K. NAIL IN 16" OAK TREE | N.54°31'13"W. | 20.58' |
| FOUND P.K. & WASHER (D.M.K.) IN 18" PINE | N.59°33'07"E. | 17.45' |
| FOUND P.K. & WASHER IN UTIL. POLE #V1185 | S.57°48'06"E. | 15.30' |
| FOUND D.N.R. DISK IN HEADWALL #CHA.21 | S.08°41'04"W. | 299.38' |
| FOUND CONCRETE MONUMENT P.L.S. #1364 | S.11°57'22"W. | 674.36' |

SURVEYORS CERTIFICATE: I certify the monument and accessories indicated above were field located on July 27, 1993.

Signature: [Handwritten Signature] PLS 4260

DATE: 10-27-93

CHARLOTTE COUNTY SURVEY DEPT.

7000 FLORIDA STREET ADDRESS

PUNTA GORDA, FLA. 33950 CITY STATE

510

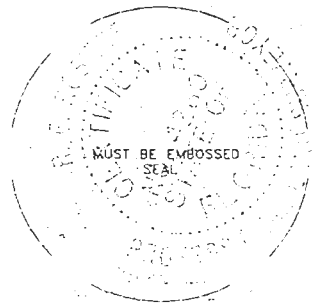

Completeness checked by: B. Linton

Accepted and filed: 12-1-93 Date

B.L.M. - I.D. 08050409 D.N.R. USE ONLY

SEND TO: Department of Natural Resources, Bureau of Survey and Mapping, 3900 Commonwealth Boulevard, Mail Station 105, Tallahassee, Florida 32399

DNR 53-001(16) REV. 7/16/92 PAGE 2 OF 2