

4121Z01

DOC. # ~~0046024~~ 0046024

FLORIDA DEPARTMENT OF NATURAL RESOURCES
CERTIFIED CORNER RECORD

Z-01

CORNER DESCRIPTION:

S.W. corner of Section 31,
Twp 41 S., Rge 21 E.,
Tallahassee Base Meridian,
CHARLOTTE County(s), Florida.

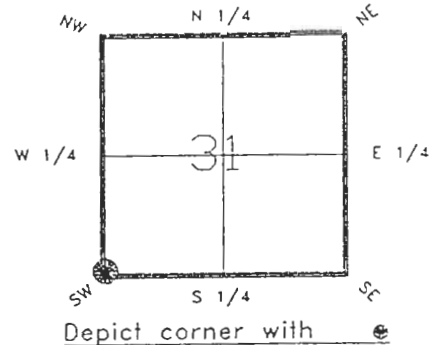

MONUMENTATION DESCRIPTION:

Describe original monument and accessories, or subsequent restoration. Give sources of information. (If no attempt was made to search for the original monument and accessories, this information is not necessary.)

FOUND LIGHTERWOOD POST 4'X 4' AT TOP.

REPLACED WITH CHARLOTTE COUNTY SURVEY MONUMENT. (POST WAS SET BY SAM RIED IN 1843)

Description of corner evidence found:

RECEIVED

JUL 26 1993

State method(s) to determine corner location (lost corners only):

SURVEY & MAPPING

HORIZONTAL POSITION INFORMATION (if determined):

Latitude 26°51'26.18724"N Longitude 82°15'21.563"W
Y(Northing) 279616.290(M) X(Easting) 174565.007(M) Zone FL W
Convergence -0°06'56.274" Scale factor 0.99994916

Coordinate determination (circle one):

Field traverse

GPS

Horizontal datum (circle one): NAD27 NAD83(1986) NAD83(1990) other (explain)

Order of accuracy as defined in "Standards and Specifications for Geodetic Control Networks" published by the Federal Geodetic Control Committee (circle one):

1st, 2nd, 3rd, class 1

or Minimum Technical Standards (Chapter 21HH-6, F.A.C.) ratio of closure for field data (example 1:10,000), . This does not specify an order of accuracy.

Control point(s) used for survey:

Comments:

NO BEARING TREES REMAIN. LIGHTERWOOD POST APPEARED TO HAVE BEEN PRESERVED BY OCCASIONAL INUNDATION WITH SALT WATER

PLEASE SEND ORIGINAL ONLY
PLEASE COMPLETE IN BLACK INK OR TYPE

DNR 53-001(16)
REV: 7/16/92
PAGE 1 OF 2

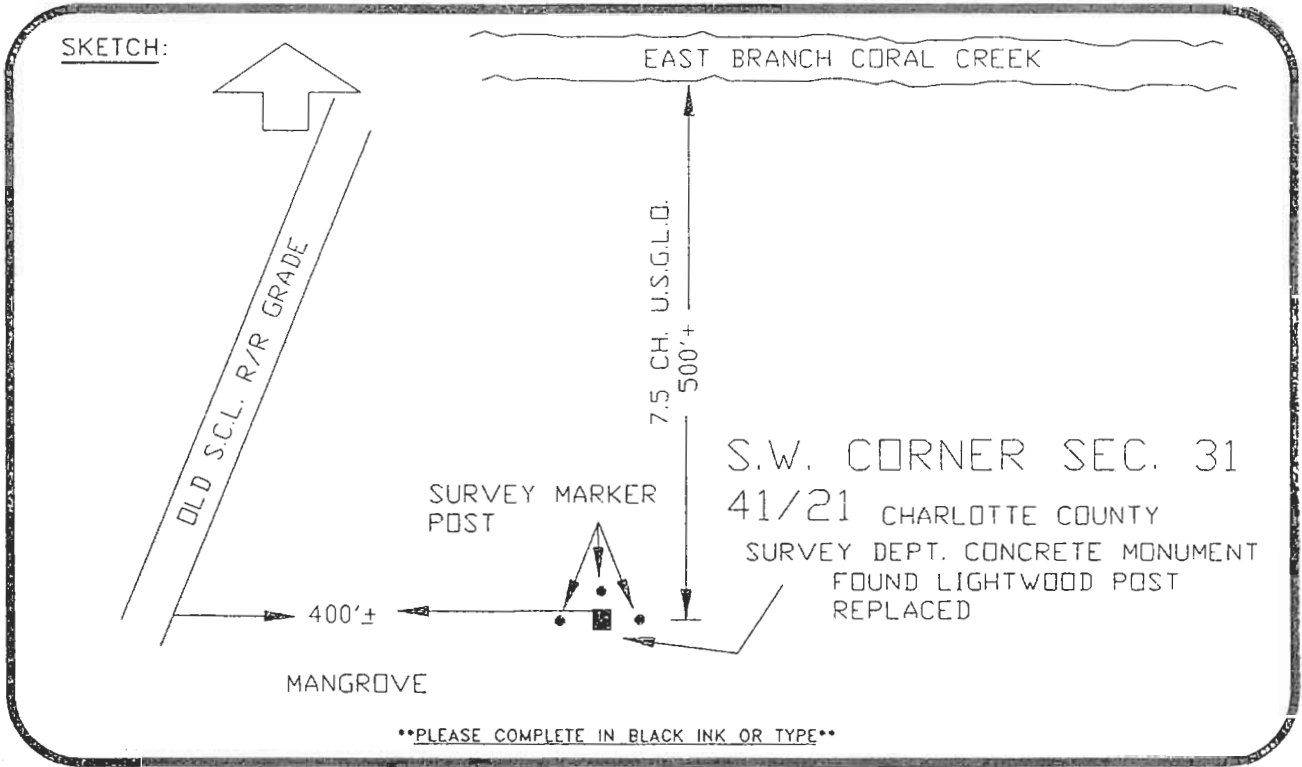

BASIS OF BEARING-COMPASS MAGNETIC REFER: F.B. 274-28
 All bearings and distances must be from the corner to the witness. Indicate whether corner was found, set, or replaced and show north arrow.

REFERENCE MEASUREMENTS (at least three vicinity references must be given below even if they appear on the above sketch):

Description	Bearing	Distance
SURVEY MARKER POST	WEST	10.0'
SURVEY MARKER POST	NORTH	5.0'
SURVEY MARKER POST	EAST	10.0'

SURVEYORS CERTIFICATE: I certify the monument and accessories indicated above were field located on JANUARY 21, 1992.

[Signature] PLS 4260
 SIGNATURE
July 12, 1993
 DATE
 CHARLOTTE COUNTY SURVEY DEPT.
 FIRM OR AGENCY
 7000 FLORIDA STREET
 ADDRESS
 PUNTA GORDA, FLA. 33950
 CITY STATE

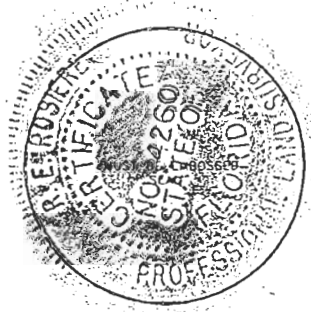

Completeness checked by: GR Green
 Accepted and filed: 8-93
 Date
 B.L.M. - I.D. 01303106 D.N.R. USE ONLY

SEND TO:

Department of Natural Resources
 Bureau of Survey and Mapping
 3900 Commonwealth Boulevard
 Mail Station 105
 Tallahassee, Florida 32399

DNR 53-001(16)
 REV. 7/16/92
 PAGE 2 OF 2