

4123R21

FLORIDA DEPARTMENT OF NATURAL RESOURCES
CERTIFIED CORNER RECORD

R21

CORNER DESCRIPTION:

S.E. corner of Section 23 ,
Twp 41 S. , Rge 23 E. ,
Tallahassee Base Meridian,
CHARLOTTE County(s), Florida.

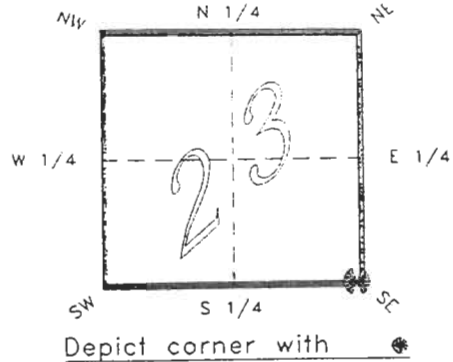

MONUMENTATION DESCRIPTION:

Describe original monument and accessories, or subsequent restoration. Give sources of information. (If no attempt was made to search for the original monument and accessories, this information is not necessary.)

Description of corner evidence found:

4"x4" SANDSTONE MONUMENT WITH TOP BROKEN
REFER TO CCR DNR DOC. # 0038279

State method(s) to determine corner location (lost corners only):

HORIZONTAL POSITION INFORMATION (if determined):

Latitude 26°53'15.61793"N Longitude 81°58'23.70006"W
Y(Northing) 282958.786 m X(Easting) 202657.543 m Zone FLW
Convergence 0°00'43.551" Scale factor 0.99994126

Coordinate determination (circle one): Field traverse GPS
Horizontal datum (circle one): NAD27 NAD83(1986) NAD83(1990) other (explain)

Order of accuracy as defined in "Standards and Specifications for Geodetic Control Networks" published by the Federal Geodetic Control Committee (circle one):
1st, 2nd, 3rd, class 1 ,

or Minimum Technical Standards (Chapter 21HH-6, F.A.C.) ratio of closure for field data (example 1:10,000), _____ . This does not specify an order of accuracy.

Control point(s) used for survey:

Comments:

RECORDED
FEB 20 1995

SKETCH:

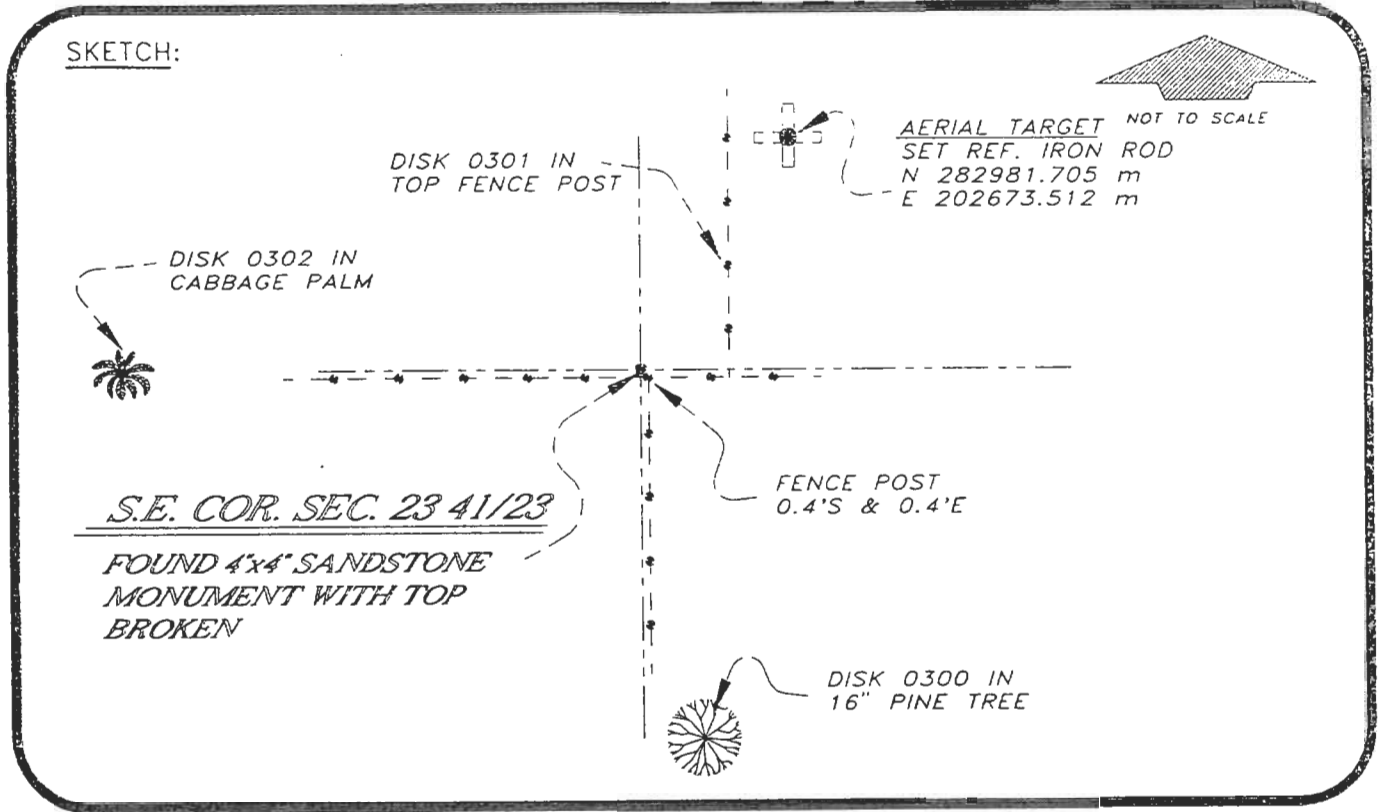

S.E. COR. SEC. 23 41/23

FOUND 4'x4' SANDSTONE MONUMENT WITH TOP BROKEN

AERIAL TARGET NOT TO SCALE
SET REF. IRON ROD
N 282981.705 m
E 202673.512 m

FENCE POST
0.4'S & 0.4'E

DISK 0300 IN
16" PINE TREE

BASIS OF BEARING SOLAR OBSERVATION REFER FB 283/58
All bearings and distances must be from the corner to the witness. Indicate whether corner was found, set, or replaced and show north arrow.

REFERENCE MEASUREMENTS (at least three vicinity references must be given below even if they appear on the above sketch):

Description	Bearing	Distance
CIR LS2776 REF. POINT	N 34°52'45" E	91.65'
DISK 0300 IN 16" PINE TREE	S 10°47'04" E	307.37'
DISK 0301 IN FENCE POST	N 51°40'31" E	48.08'
DISK 0302 IN CABBAGE PALM	N 89°51'51" W	273.25'

SURVEYORS CERTIFICATE: I certify the monument and accessories indicated above were field located on JUNE 17, 19 93.

[Signature] PLS 4260

UPDATED 2/14/95

2-15-95
DATE

CHARLOTTE COUNTY SURVEY DEPT.

FIRM OR AGENCY

7000 FLORIDA STREET

ADDRESS

PUNTA GORDA, FLA. 33950

CITY

STATE

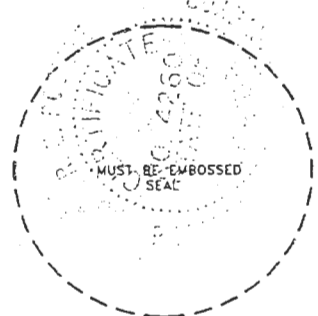

508

Completeness checked by: B. Linton
 Accepted and filed: 3-1-95 Date
 B.L.M. - I.D. 26232425 D.N.R. USE ONLY

SEND TO:

Department of Natural Resources
Bureau of Survey and Mapping
3900 Commonwealth Boulevard
Mail Station 105
Tallahassee, Florida 32399

DNR 53-001(16)
REV. 7/16/92
PAGE 2 OF 2