

FLORIDA DEPARTMENT OF ENVIRONMENTAL PROTECTION CERTIFIED CORNER RECORD

DOC. # 089342

CORNER DESCRIPTION: MONUMENTATION DESCRIPTION (EVIDENCE FOUND OR METHOD TO SET)

Depict corner with ● E-1

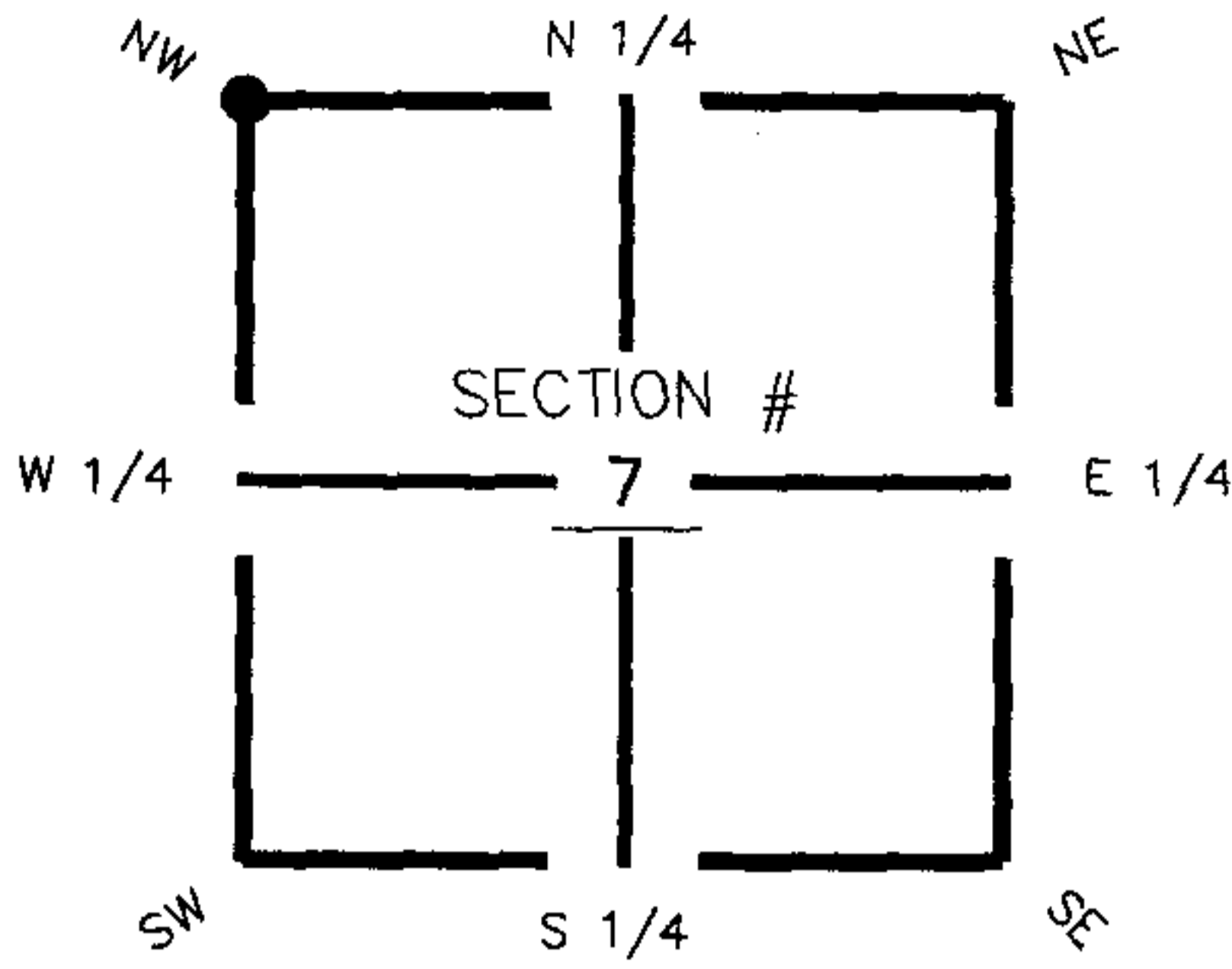

Found PK Nail and Disc, stamped
(C.C.S.D. Sec. Cor.)

HORIZONTAL POSITION INFORMATION (if determined):

Latitude 26° 55' 50.65424" N Longitude 81° 45' 38.29563" W
 Y(NORTHING-Ft.) 944067.92 X(EASTING-Ft.) 734155.56 Zone FL83-WF
 Convergence 0° 06' 30.27900" Scale factor 0.999948150

Coordinate determination (circle one): Field traverse (GPS)
 Horizontal datum (circle one): NAD27 NAD83(1986) (NAD83(1999)) other (explain)
 Accuracy (circle one): 1st (2nd) 3rd other _____

NW corner of Section 7
Twp 41 South , Rge 26 East
 Tallahassee Base Meridian,
Charlotte County(s), Florida

1. 45° 22.07'. Set PK Nail and Disc (LB 642).
2. 90° 14.44'. Set PK Nail and Disc (LB 642).
3. 140° 21.40'. Set PK Nail and Disc (LB 642).

N.W. Cor. Sec.7, Twp.41S., Rge.26E.
 Found PK Nail and Disc, stamped
 (C.C.S.D. Sec. Cor.).

Field Book: LB-30, Page 24

The map shows a grid of sections. Section 1 is top-left, Section 6 is top-right, Section 7 is bottom-right, and Section 12 is bottom-left. A vertical road labeled 'SR-31' runs through the center. Below the road, two vertical lines are labeled 'Range 25 East' and 'Range 26 East'. Three points are marked on the SR-31 road: point 1 is at the intersection with the top boundary of Section 6, point 2 is at the intersection with the horizontal boundary between Section 1 and Section 7, and point 3 is at the intersection with the bottom boundary of Section 6. A north arrow is on the right, labeled 'NOT TO SCALE'.

SURVEYORS CERTIFICATE:

I certify the monument and accessories indicated above were field located on August 19, 2005

[Signature] 4912
SIGNATURE PSM NO.
Johnson Engineering, Inc. 642
FIRM OR AGENCY LB NO.
251 West Hickpochee (SR80)
ADDRESS
La Belle, 4912 Florida 33935
CITY STATE ZIP
(863) 612-0594 November 4, 2005
PHONE NUMBER DATE

EMBOSSSED SEAL OVER SIGNATURE

SEND ORIGINAL TO:
 Department of Environmental Protection
 Bureau of Surveying and Mapping
 3900 Commonwealth Boulevard
 Mail Station 105
 Tallahassee, Florida 32399

D.E.P. USE ONLY

Processed: 11-13-06 MB

B.L.M. - I.D. 100600

QUAD - I.D. 2415 BERMONT