

**FLORIDA DEPARTMENT OF ENVIRONMENTAL PROTECTION  
CERTIFIED CORNER RECORD**

DOC. # 089346

**CORNER DESCRIPTION:** MONUMENTATION DESCRIPTION (EVIDENCE FOUND OR METHOD TO SET)

Depict corner with ● J-1

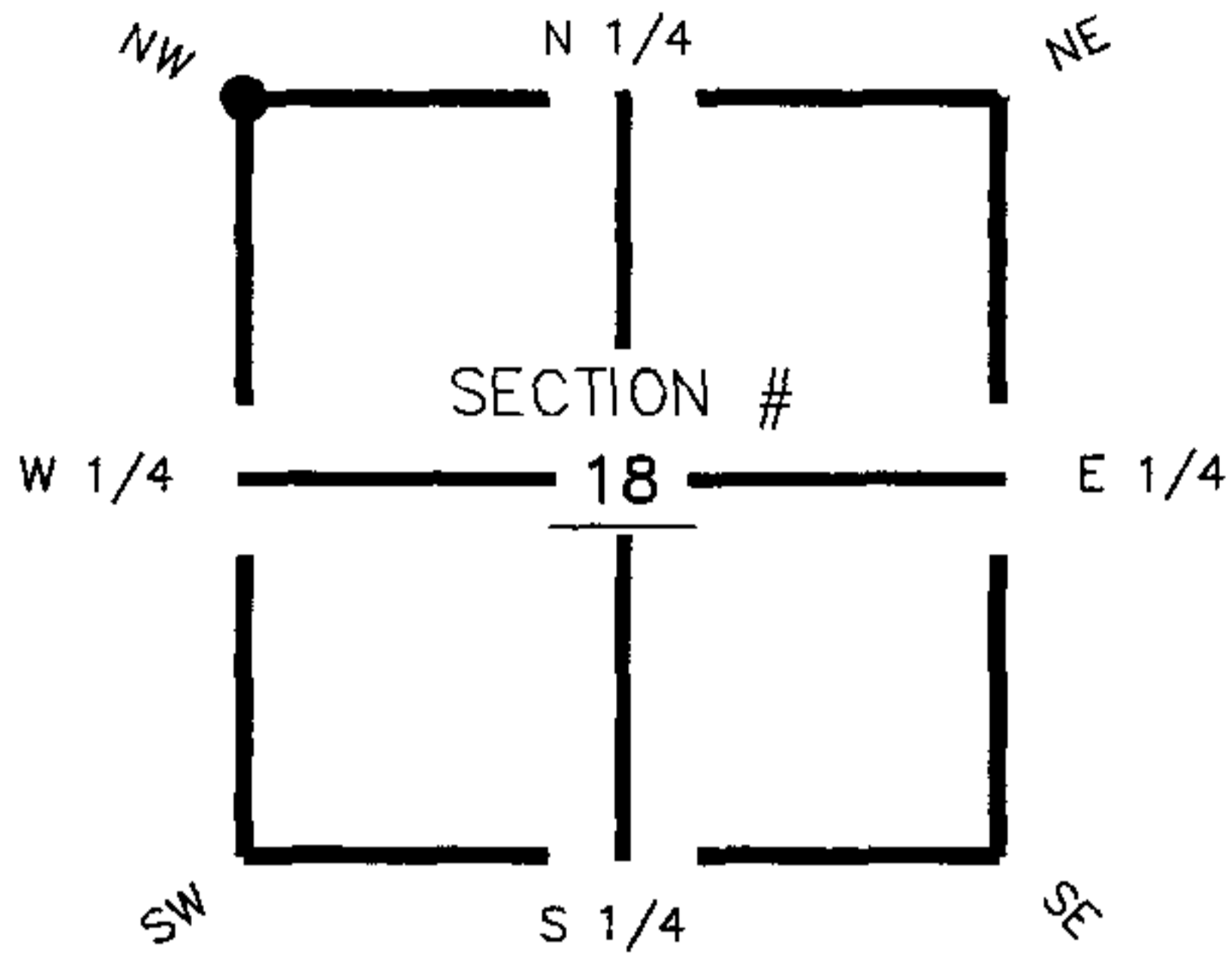

Found Nail

**HORIZONTAL POSITION INFORMATION ( if determined ):**

Latitude 26° 54' 57.35052" N Longitude 81° 45' 37.47095" W  
 Y(NORTHING-Ft.) 938685.80 X(EASTING-Ft.) 734240.39 Zone FL83-WF  
 Convergence 0° 06' 30.45378" Scale factor 0.999948165  
 Coordinate determination (circle one): Field traverse (GPS)  
 Horizontal datum (circle one): NAD27 NAD83(1986) (NAD83(1999)) other (explain)  
 Accuracy (circle one): 1st (2nd) 3rd other \_\_\_\_\_

NW corner of Section 18  
 Twp 41 South , Rge 26 East  
 Tallahassee Base Meridian,  
Charlotte County(s), Florida

1. 57° 15.22'. Set PK Nail and Disc (LB 642).
2. 150° 17.72'. Found Nail and Disc (FDOT).
3. 230° 15.13'. Found Nail and Disc (ATT 699).

N.W. Cor. Sec.18, Twp.41S., Rge.26E.  
Found Nail.

NOT TO SCALE

Field Book: LB-30, Page 23

**SURVEYORS CERTIFICATE:**

I certify the monument and accessories indicated above were field located on August 19, 2005

[Signature] 4912  
 SIGNATURE PSM NO.  
Johnson Engineering, Inc. 642  
 FIRM OR AGENCY LB NO.  
251 West Hickpochee (SR80)  
 ADDRESS  
La Belle, 4912 Florida 33935  
 CITY STATE ZIP  
(863) 612-0594 November 4, 2005  
 PHONE NUMBER DATE

**SEND ORIGINAL TO:**  
 Department of Environmental Protection  
 Bureau of Surveying and Mapping  
 3900 Commonwealth Boulevard  
 Mail Station 105  
 Tallahassee, Florida 32399

Processed:	<u>11-13-06 MB</u>
B.L.M. - I.D.	<u>100500</u>
QUAD - I.D.	<u>2415 Belmont</u>

EMBOSSSED SEAL OVER SIGNATURE