

**FLORIDA DEPARTMENT OF ENVIRONMENTAL PROTECTION  
CERTIFIED CORNER RECORD**

DOC. # 089347

**CORNER DESCRIPTION:** MONUMENTATION DESCRIPTION (EVIDENCE FOUND OR METHOD TO SET)

Depict corner with  N-1

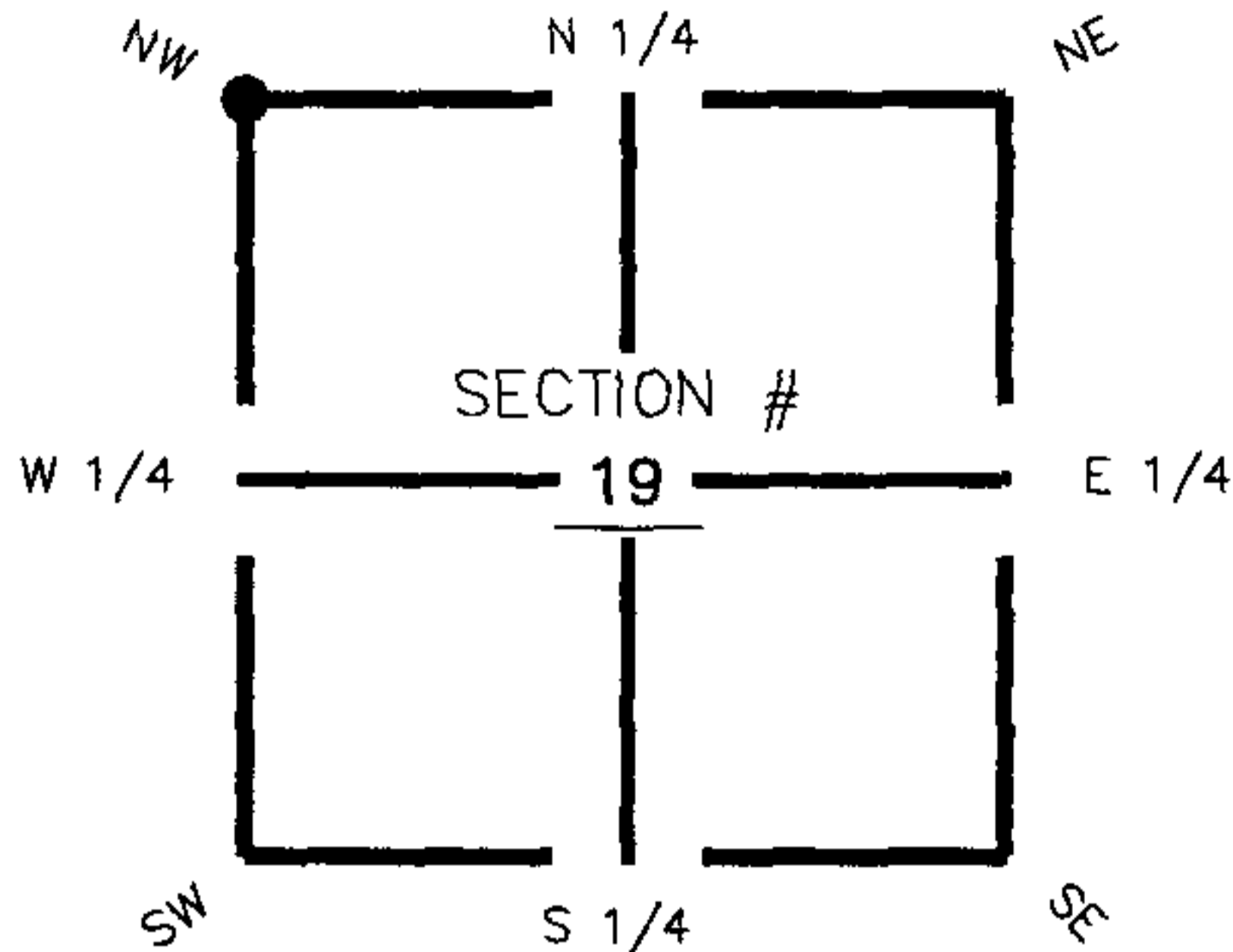

Found Nail

**HORIZONTAL POSITION INFORMATION ( if determined ):**

Latitude 26° 54' 04.92832" N Longitude 81° 45' 36.71735" W  
 Y(NORTHING-Ft.) 933392.69 X(EASTING-Ft.) 734318.63 Zone FL83-WF  
 Convergence 0° 06' 30.59927" Scale factor 0.999948179  
 Coordinate determination (circle one): Field traverse  GPS  
 Horizontal datum (circle one): NAD27 NAD83(1986)  NAD83(1999) other (explain)  
 Accuracy (circle one): 1st  2nd 3rd other \_\_\_\_\_

NW corner of Section 19  
Twp 41 South , Rge 26 East  
 Tallahassee Base Meridian,  
Charlotte County(s), Florida

1. 42' 19.08'. Set PK Nail and Disc (LB 642).
2. 120' 14.65'. Found PK Nail (center target).
3. 155' 31.92'. Set PK Nail and Disc (LB 642).

N.W. Cor. Sec.19, Twp.41S., Rge.26E.  
Found Nail.

Field Book: LB-30, Page 22

**SURVEYORS CERTIFICATE:**

I certify the monument and accessories indicated above were field located on August 19, 2005

*[Signature]*  
 SIGNATURE \_\_\_\_\_ 4912  
 JOHNSON ENGINEERING, INC. PSM NO.  
 251 West Hickpochee (SR80) ADDRESS \_\_\_\_\_ 642  
 La Belle CITY NO. 1912 STATE OF Florida ZIP 33935  
 (863) 612-0594 PHONE NUMBER DATE November 4, 2005

EMBOSSSED SEAL OVER SIGNATURE

SEND ORIGINAL TO:  
 Department of Environmental Protection  
 Bureau of Surveying and Mapping  
 3900 Commonwealth Boulevard  
 Mail Station 105  
 Tallahassee, Florida 32399

D.E.P. USE ONLY	
Processed:	<u>11-13-06 YMB</u>
B.L.M. - I.D.	<u>700400</u>
QUAD - I.D.	<u>2415 Bermont</u>