

**FLORIDA DEPARTMENT OF ENVIRONMENTAL PROTECTION
CERTIFIED CORNER RECORD**

089343

DOC. # _____

CORNER DESCRIPTION: MONUMENTATION DESCRIPTION (EVIDENCE FOUND OR METHOD TO SET)

Depict corner with N-5

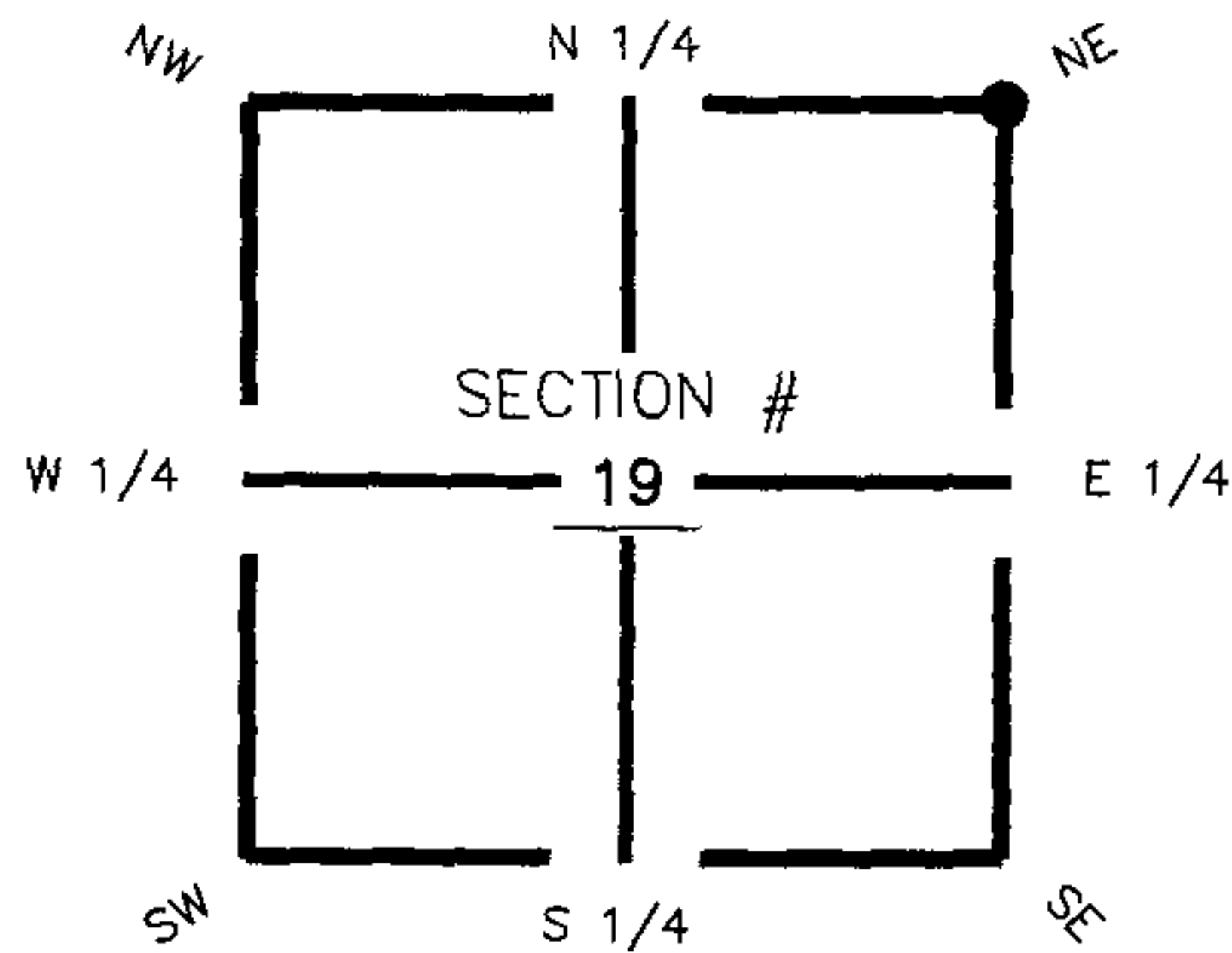

Found 4"x4" Concrete Monument with Brass Disc stamped Char. Co. Survey Dept.

18 | 17
19 | 20

HORIZONTAL POSITION INFORMATION (if determined):

Latitude 26° 54' 03.84441" N Longitude 81° 38' 41.16227" W
 Y(NORTHING-Ft.) 933371.63 X(EASTING-Ft.) 771938.89 Zone FL83-WF
 Convergence 0° 09' 38.61782" Scale factor 0.999956543

NE corner of Section 19
Twp 41 South , Rge 27 East
 Tallahassee Base Meridian,
Charlotte County(s), Florida

Coordinate determination (circle one): Field traverse GPS
 Horizontal datum (circle one): NAD27 NAD83(1986) NAD83(1999) other (explain)
 Accuracy (circle one): 1st 2nd 3rd other _____

1. 94° 20.80'. Set PK Nail and Trav. Pt. Disc (LB 642) in S. face of fence post.
2. 261° 118.39'. Found 5/8" Iron Pipe with cap Charlotte County witness.
3. 276° 125.83'. Found 4"x4" Concrete Monument with 5/8" Iron Rod with cap (PLS 2622).
4. 281° 8.58'. Set PK Nail and Trav. Pt. Disc (LB 642) in S. face of fence post.

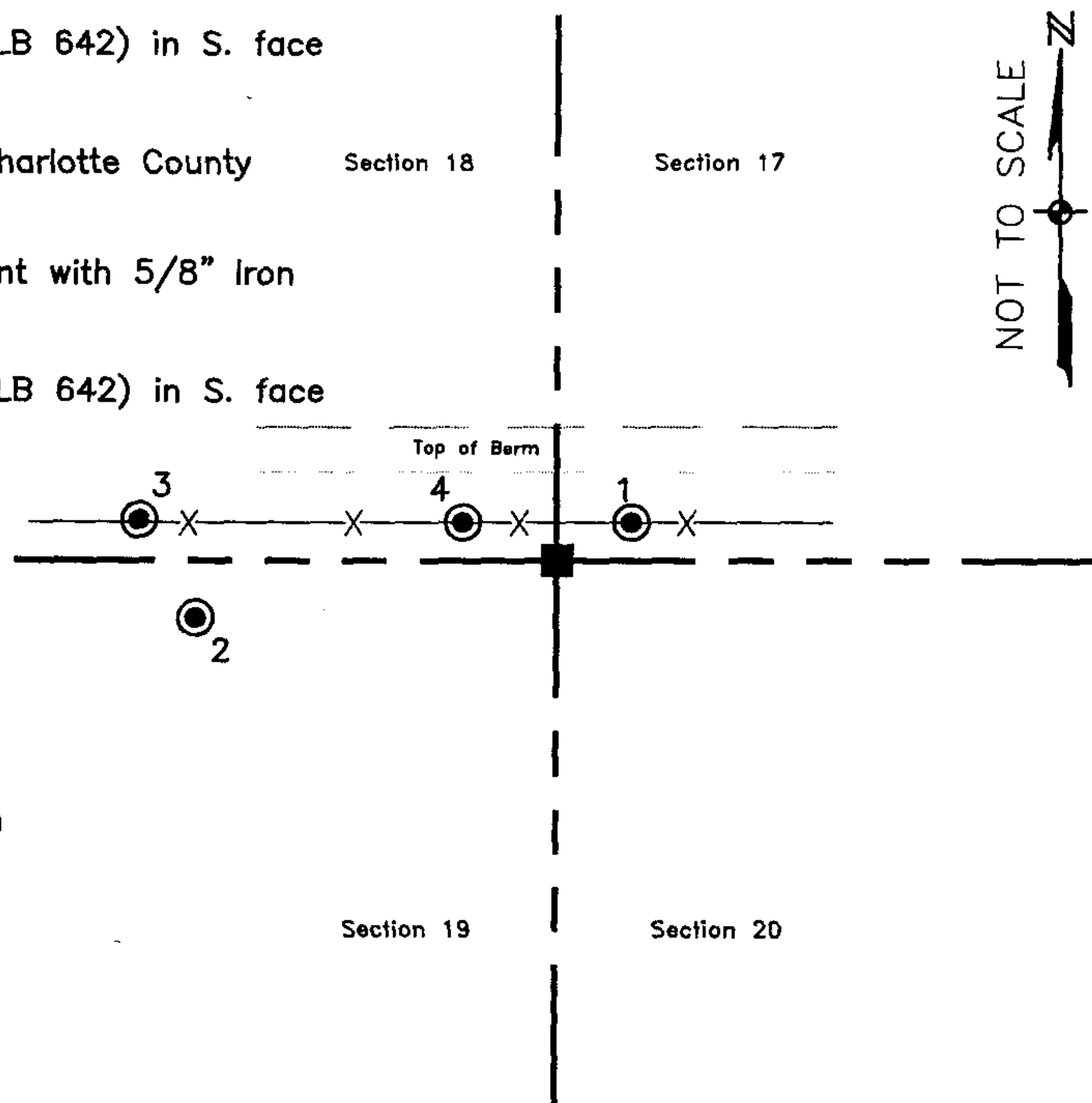

N.E. Cor. Sec.19, Twp.41S., Rge.27E.
 Found 4"x4" Concrete Monument with
 Brass Disc Char. Co. Survey Dept.
 0.5'S. of E.-W. fence.

Field Book: LB-31, Page 30

SURVEYORS CERTIFICATE:

I certify the monument and accessories indicated above were field located on August 24, 2005

[Signature]
 SIGNATURE _____ 4912
 JOHNSON ENGINEERING, INC. PSM NO.
 FIRM OR AGENCY _____ 642
 LB NO.
 251 West Hickpochee (SR80) ADDRESS
 La Belle, Florida 33935
 CITY STATE ZIP
 (863) 612-0594 October 28, 2005
 PHONE NUMBER DATE

EMBOSSED SEAL OVER SIGNATURE

SEND ORIGINAL TO:
 Department of Environmental Protection
 Bureau of Surveying and Mapping
 3900 Commonwealth Boulevard
 Mail Station 105
 Tallahassee, Florida 32399

DEP. USE ONLY
 Processed: 11-13-06 MB
 B.L.M. - I.D. 200400
 QUAD - I.D. 2414 Telegraph Swamp NW