

# FLORIDA DEPARTMENT OF ENVIRONMENTAL PROTECTION CERTIFIED CORNER RECORD

DOC. # 089352

**CORNER DESCRIPTION:** MONUMENTATION DESCRIPTION (EVIDENCE FOUND OR METHOD TO SET)

Depict corner with  N-21

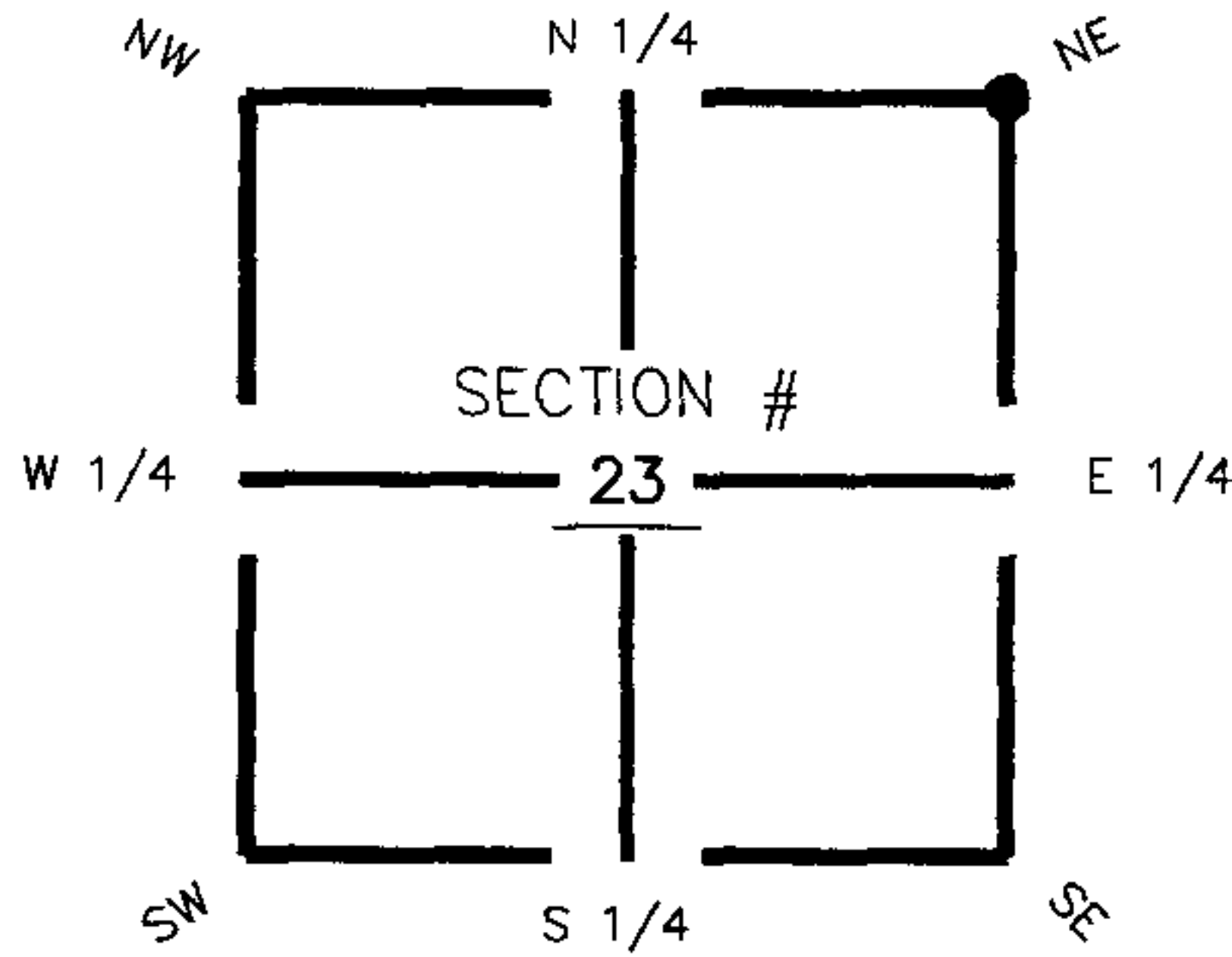

Found 4"x4" Shaped Lt. Wood Post set in 6" Round Concrete Monument with 60d Nail & Disc, stamped (C.C.S.D.).

**HORIZONTAL POSITION INFORMATION ( if determined ):**

Latitude 26° 54' 03.06509" N Longitude 81° 34' 47.03396" W  
 Y(NORTHING-Ft.) 933357.84 X(EASTING-Ft.) 793134.82 Zone FL83-WF  
 Convergence 0° 11' 24.54832" Scale factor 0.999962685  
 Coordinate determination (circle one): Field traverse  GPS  
 Horizontal datum (circle one): NAD27 NAD83(1986)  NAD83(1999) other (explain)  
 Accuracy (circle one): 1st  2nd 3rd other \_\_\_\_\_

NE corner of Section 23  
Twp 41 South , Rge 27 East  
 Tallahassee Base Meridian,  
Charlotte County(s), Florida

1. 66° 25.39'. Set PK Nail and Trav. Pt. Disc (LB 642) in S. face of 14" Oak tree.
2. 176° 35.28'. Set PK Nail and Trav. Pt. Disc (LB 642) in W. face of 36" Oak tree.
3. 7° 23.47'. Set PK Nail and Trav. Pt. Disc (LB 642) in E. face of 4" Pine tree.

N.E. Cor. Sec.23, Twp.41S., Rge.27E.  
 Found 4"x4" Shaped Lt. Wood Post set in 6" Round Concrete Monument with 60d Nail & Disc, stamped (C.C.S.D.), ±1'N. of fence and 23'W. of P.I.

NOT TO SCALE

Field Book: LB-31, Page 28

**SURVEYORS CERTIFICATE:**

I certify the monument and accessories indicated above were field located on August 22, 2005

*[Signature]*  
 SIGNATURE \_\_\_\_\_ 4912  
 JOHNSON ENGINEERING, INC. PSM NO.  
 251 West Hickpochee (SR80) ADDRESS \_\_\_\_\_ 642  
 La Belle, FL 33935 LB NO.  
 (863) 612-0694 PHONE NUMBER  
 October 28, 2005 DATE

SEND ORIGINAL TO:  
 Department of Environmental Protection  
 Bureau of Surveying and Mapping  
 3900 Commonwealth Boulevard  
 Mail Station 105  
 Tallahassee, Florida 32399

Processed:	D.E.P. USE ONLY <u>11-13-06 TMB</u>
B.L.M. - I.D.	<u>600400</u>
QUAD - I.D.	<u>2413 Telegraph Swamp NE</u>

EMBOSSSED SEAL OVER SIGNATURE