

# FLORIDA DEPARTMENT OF ENVIRONMENTAL PROTECTION CERTIFIED CORNER RECORD

089355

DOC. # \_\_\_\_\_

**CORNER DESCRIPTION: MONUMENTATION DESCRIPTION (EVIDENCE FOUND OR METHOD TO SET)**

Depict corner with  R-25

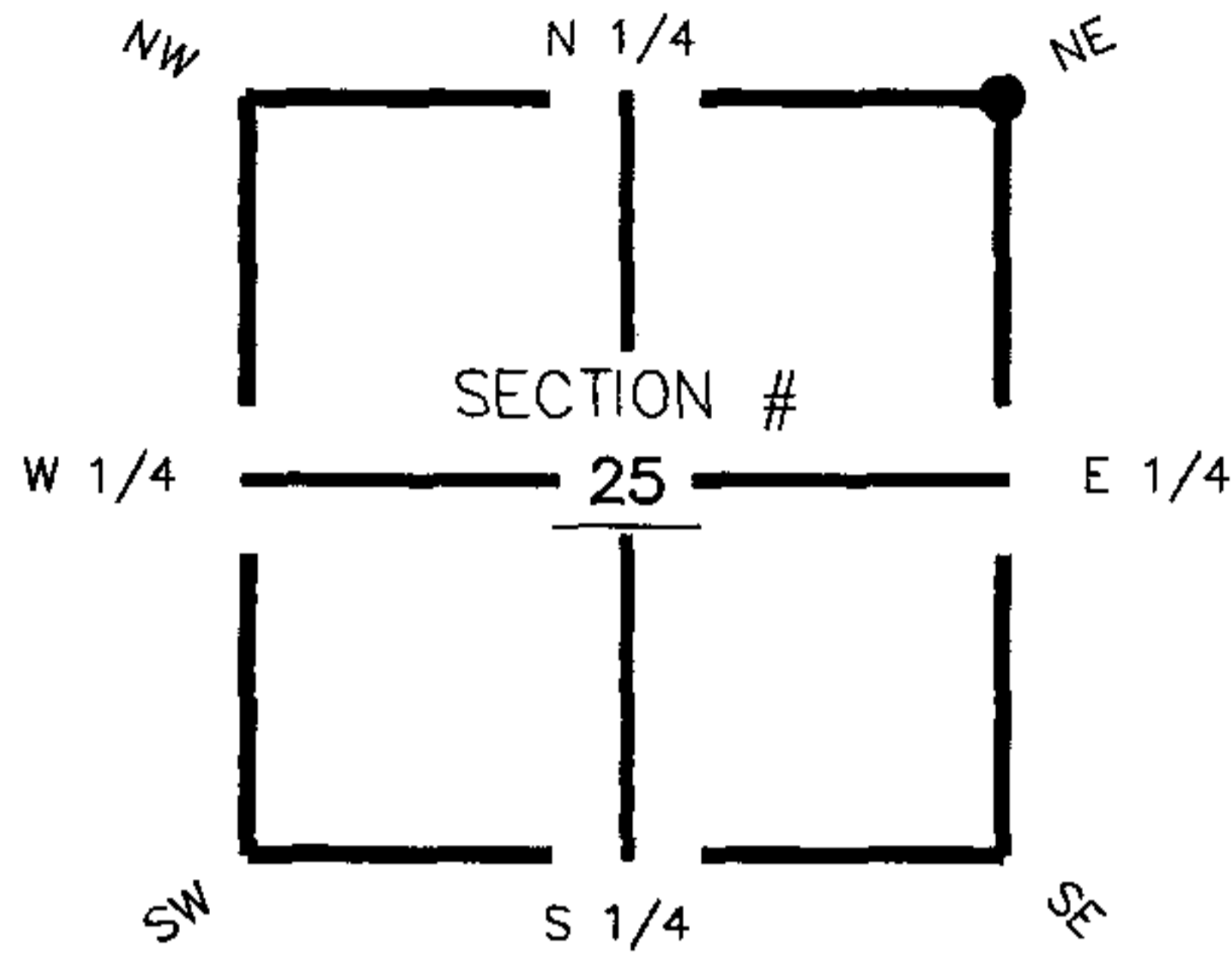

Found 4" Round Concrete Monument  
with Disc, stamped (N.E. Cor.  
25-41-27)

NE corner of Section 25  
Twp 41 South, Rge 27 East  
Tallahassee Base Meridian,  
Charlotte County(s), Florida

**HORIZONTAL POSITION INFORMATION ( if determined ):**

Latitude 26° 53' 09.67138" N Longitude 81° 33' 48.55726" W  
Y(NORTHING-Ft.) 927984.36 X(EASTING-Ft.) 798447.33 Zone FL83-WF  
Convergence 0° 11' 50.64439" Scale factor 0.999964386  
Coordinate determination (circle one): Field traverse  GPS  
Horizontal datum (circle one): NAD27 NAD83(1986)  NAD83(1999) other (explain)  
Accuracy (circle one): 1st  2nd 3rd other \_\_\_\_\_

1. 188' 18.35'. Set PK Nail and Trav. Pt. Disc (LB 642) in W. face of 3" Pine tree.
2. 242' 76.70'. Set PK Nail and Trav. Pt. Disc (LB 642) in N. face of 7" Pine tree.
3. 322' 60.98'. Set PK Nail and Trav. Pt. Disc (LB 642) in S.W. face of 2" Pine tree.

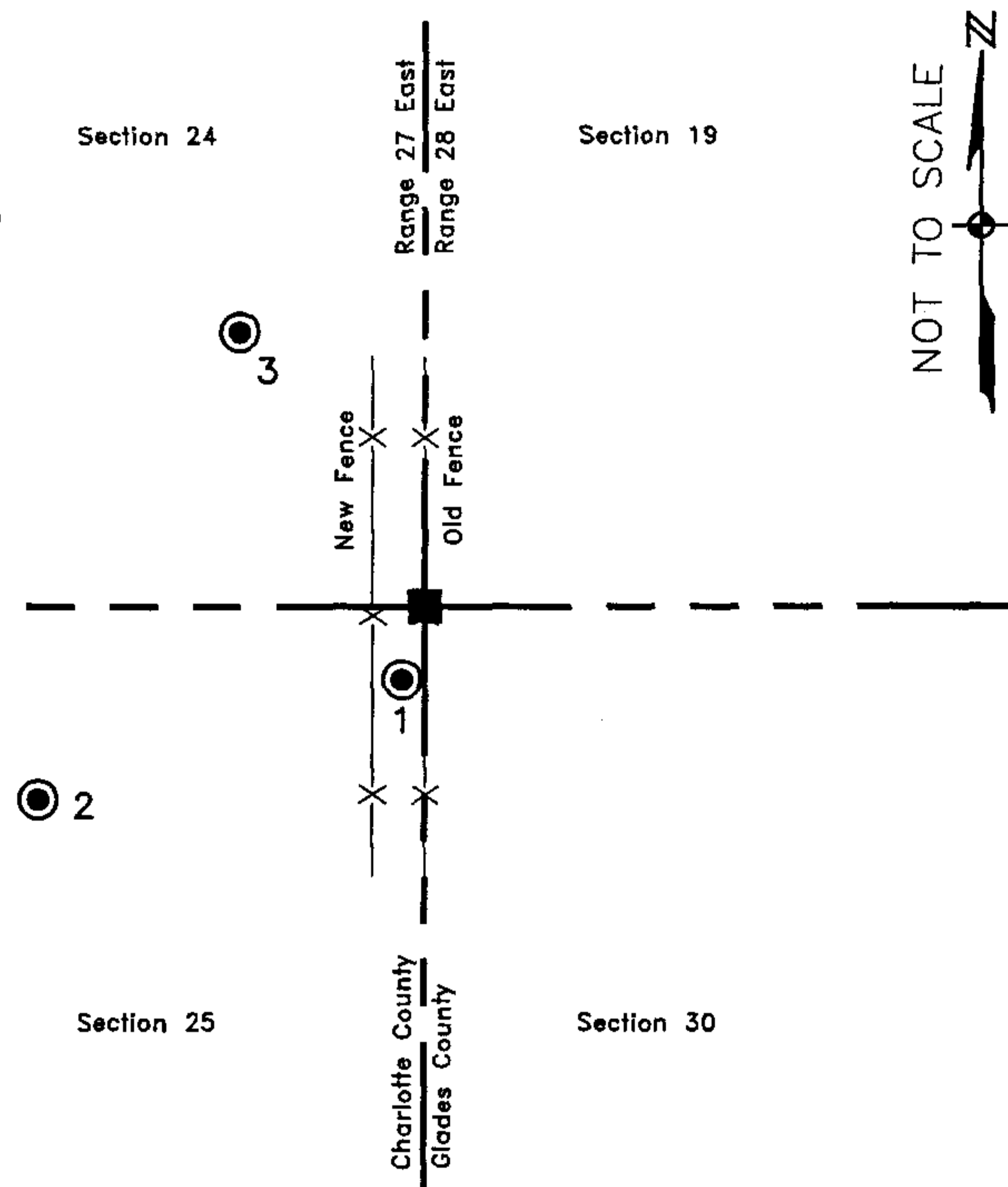

N.E. Cor. Sec.25, Twp.41S., Rge.27E.  
Found 4" Round Concrete Monument  
with Disc, stamped (N.E. Cor. 25-41-27).

Field Book: LB-31, Page 25

**SURVEYORS CERTIFICATE:**

I certify the monument and accessories indicated above were field located on August 22, 2005

*[Signature]*  
\_\_\_\_\_  
SIGNATURE  
4912  
PSM NO.  
Johnson Engineering, Inc.  
\_\_\_\_\_  
FIRM OR AGENCY  
642  
LB NO.  
251 West Hickpochee (SR8D)  
\_\_\_\_\_  
ADDRESS  
La Belle  
\_\_\_\_\_  
CITY  
Florida 33935  
\_\_\_\_\_  
STATE ZIP  
(863) 612-0594  
\_\_\_\_\_  
PHONE NUMBER  
October 28, 2005  
\_\_\_\_\_  
DATE

EMBOSSSED SEAL OVER SIGNATURE

SEND ORIGINAL TO:  
Department of Environmental Protection  
Bureau of Surveying and Mapping  
3900 Commonwealth Boulevard  
Mail Station 105  
Tallahassee, Florida 32399

D.E.P. USE ONLY

Processed: 11-13-06 mb  
B.L.M. - I.D. 700300  
QUAD - I.D. 2413 Telegraph Swamp NE