

FLORIDA DEPARTMENT OF ENVIRONMENTAL PROTECTION CERTIFIED CORNER RECORD

DOC. # 089356

CORNER DESCRIPTION: MONUMENTATION DESCRIPTION (EVIDENCE FOUND OR METHOD TO SET)

Depict corner with T-25

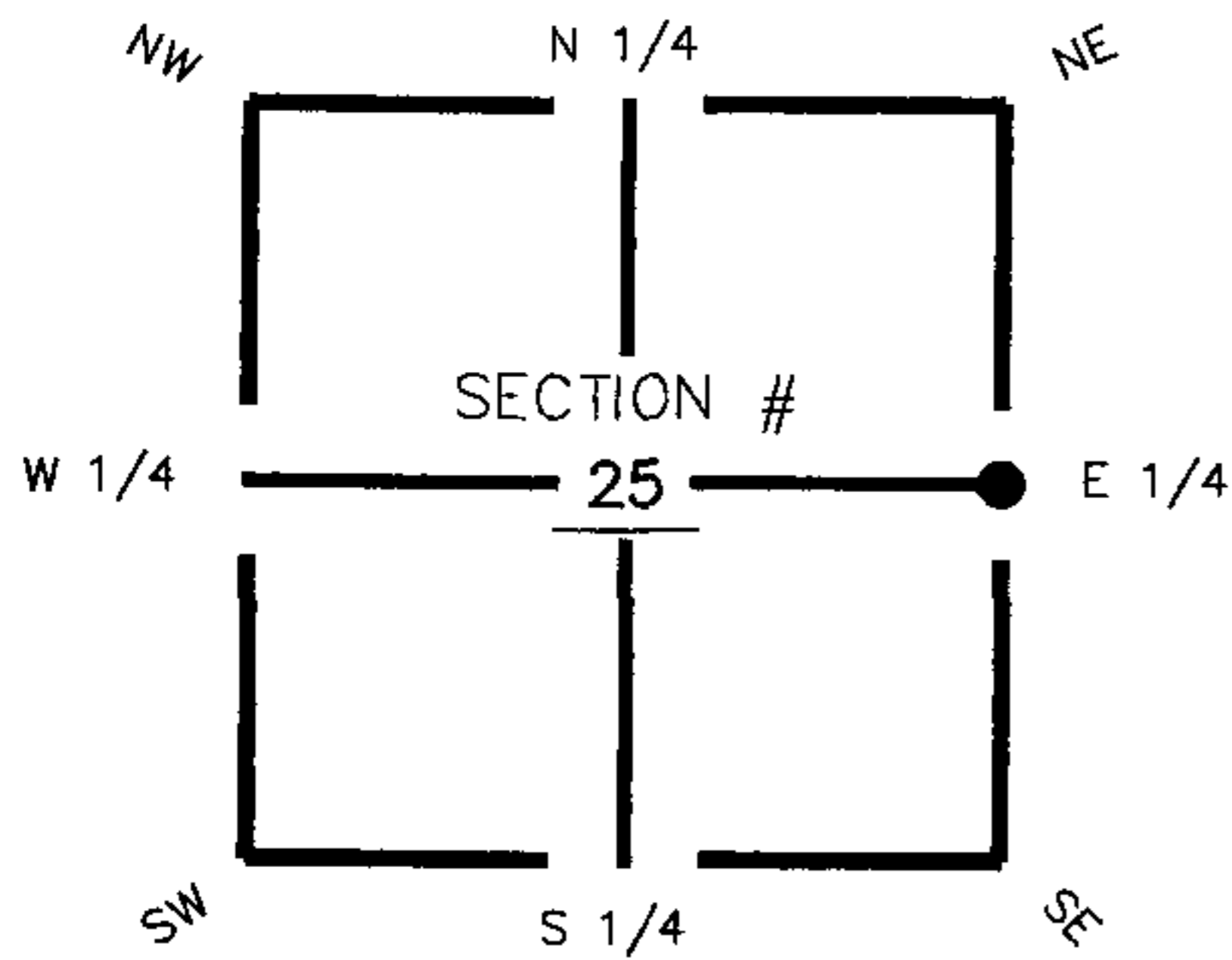

Found 4" Round Concrete Monument
with Disc, stamped (E. 1/4 25-41-27)

HORIZONTAL POSITION INFORMATION (if determined):

Latitude 26° 52' 43.31509" N Longitude 81° 33' 48.86923" W
 Y(NORTHING-Ft.) 925322.96 X(EASTING-Ft.) 798428.25 Zone FL83-WF
 Convergence 0° 11' 50.32424" Scale factor 0.999964379
 Coordinate determination (circle one): Field traverse GPS
 Horizontal datum (circle one): NAD27 NAD83(1986) NAD83(1999) other (explain)
 Accuracy (circle one): 1st 2nd 3rd other _____

E 1/4 corner of Section 25
 Twp 41 South , Rge 27 East
 Tallahassee Base Meridian,
Charlotte County(s), Florida

1. 5' 42.05'. Set PK Nail and Trav. Pt. Disc (LB 642) in E. face of 10" Pine tree.
2. 168' 5.34'. Set PK Nail and Trav. Pt. Disc (LB 642) in W. face of 5" Pine tree.
3. 298' 60.90'. Set PK Nail and Trav. Pt. Disc (LB 642) in S. face of 13" Pine tree.

E. 1/4 Cor. Sec.25, Twp.41S., Rge.27E.
 Found 4" Round Concrete Monument
 with Disc, stamped (E. 1/4 25-41-27).

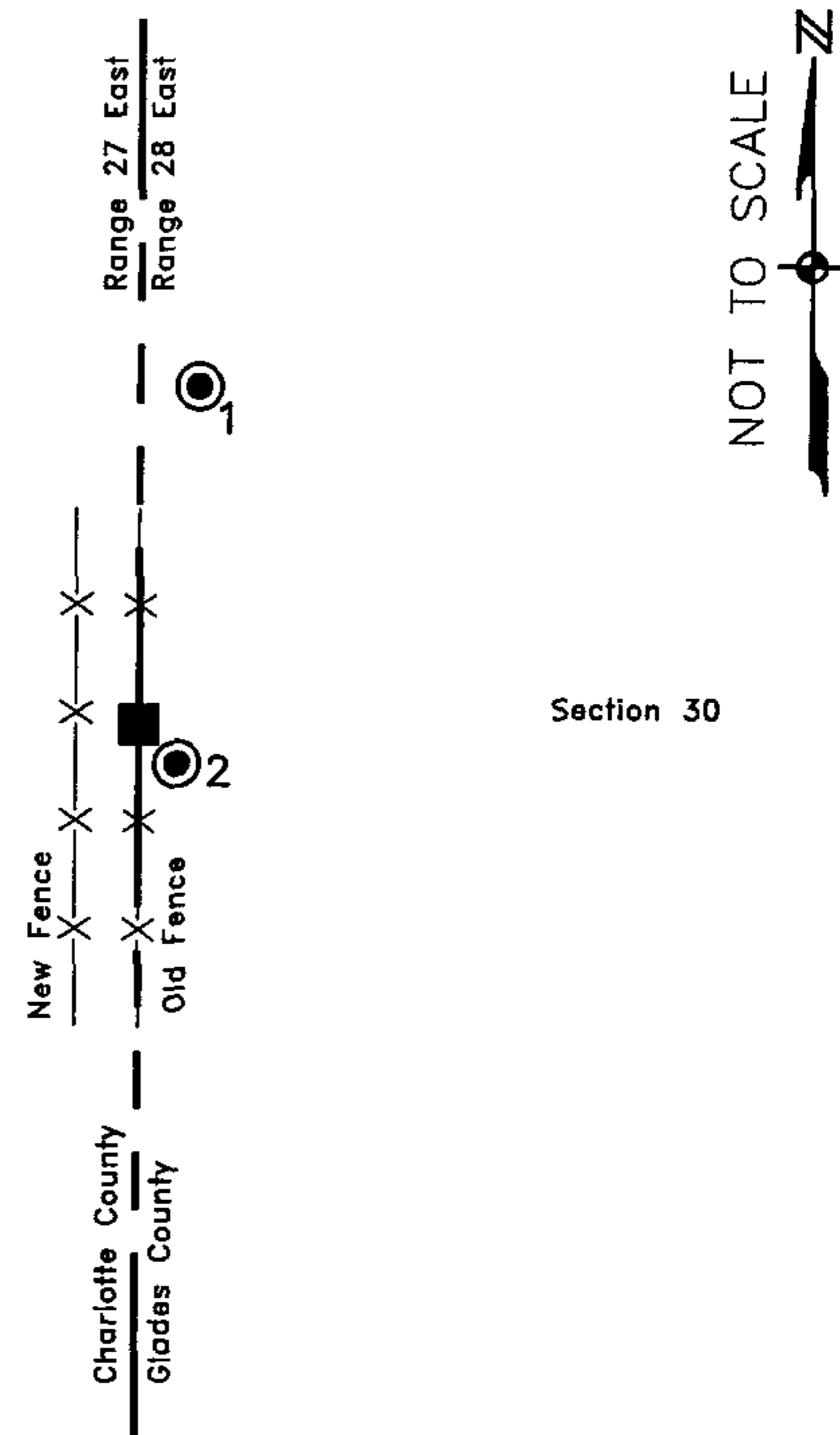

Field Book: LB-31, Page 24

SURVEYORS CERTIFICATE:

I certify the monument and accessories indicated above were field located on August 22, 2005

[Signature]
 SIGNATURE _____ 4912
 JOHNSON ENGINEERING, INC. PSM NO. _____
 FIRM OR AGENCY _____ 642
 251 West Hickpochee (SR80) LB NO. _____
 ADDRESS _____
 La Belle Florida 33935
 CITY STATE ZIP
 (863) 612-0594 October 31, 2005
 PHONE NUMBER DATE

EMBOSSSED-SEAL OVER SIGNATURE

SEND ORIGINAL TO:
 Department of Environmental Protection
 Bureau of Surveying and Mapping
 3900 Commonwealth Boulevard
 Mail Station 105
 Tallahassee, Florida 32399

D.E.P. USE ONLY

Processed: 11-13-06 MD
 B.L.M. - I.D. 700240
 QUAD - I.D. 2413 Telegraph Swamp NE