

**FLORIDA DEPARTMENT OF ENVIRONMENTAL PROTECTION
CERTIFIED CORNER RECORD**

089358

DOC. # _____

CORNER DESCRIPTION: MONUMENTATION DESCRIPTION (EVIDENCE FOUND OR METHOD TO SET)

Depict corner with **●** X-25

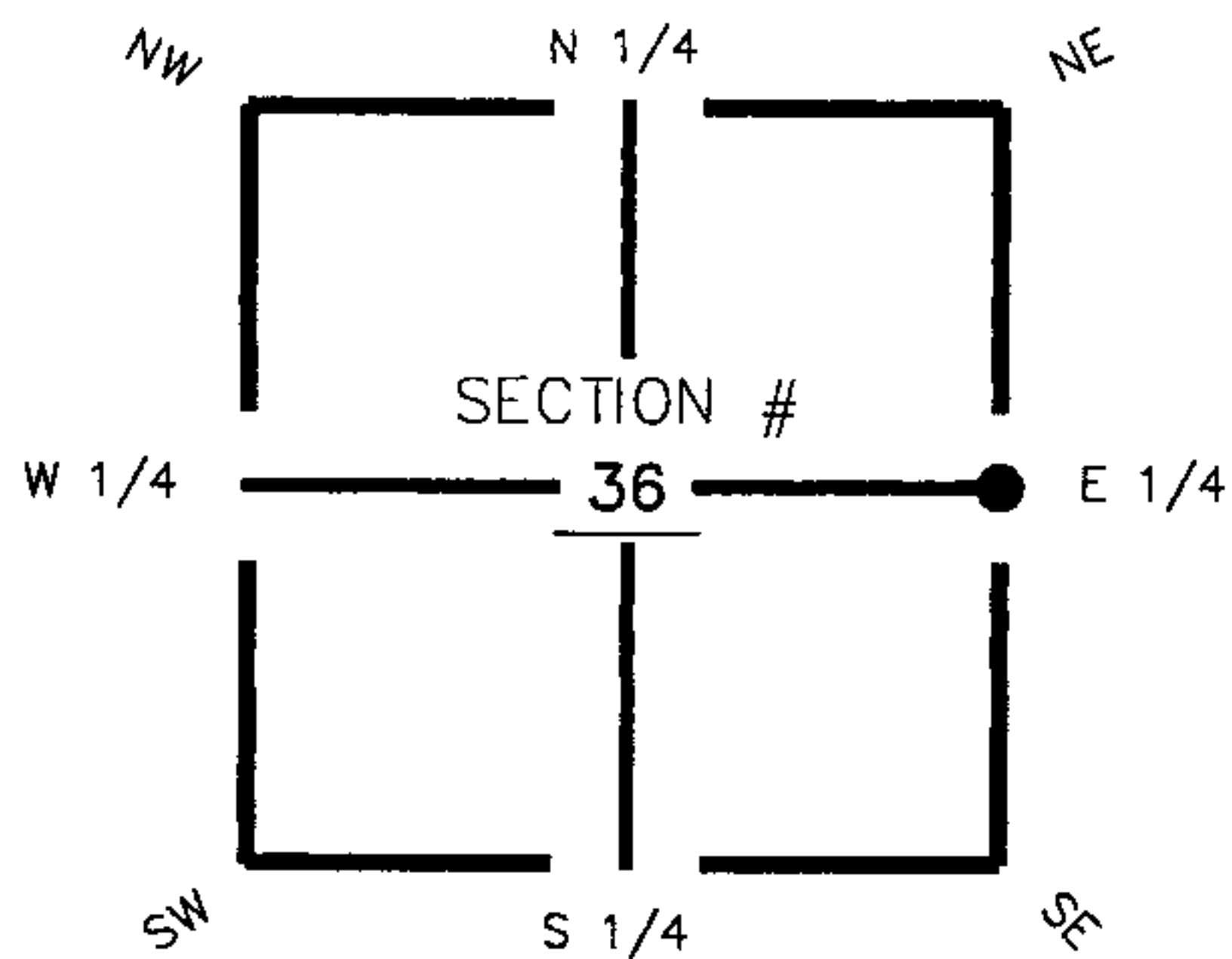

Found 4" Round Concrete Monument with Disc, stamped (E. 1/4 36-41-27)

HORIZONTAL POSITION INFORMATION (if determined):

Latitude 26° 51' 50.61171" N Longitude 81° 33' 49.58281" W
 Y(NORTHING-Ft.) 920001.07 X(EASTING-Ft.) 798381.95 Zone FL83-WF
 Convergence 0° 11' 49.64368" Scale factor 0.999964364

E 1/4 corner of Section 36
 Twp 41 South, Rge 27 East
 Tallahassee Base Meridian,
Charlotte County(s), Florida

Coordinate determination (circle one): Field traverse (GPS)
 Horizontal datum (circle one): NAD27 NAD83(1986) (NAD83(1999)) other (explain)
 Accuracy (circle one): 1st (2nd) 3rd other _____

1. 18° 11.69'. Set PK Nail and Trav. Pt. Disc (LB 642) in S.E. face of 6" Pine tree.
2. 181° 13.68'. Set PK Nail and Trav. Pt. Disc (LB 642) in W. face of 5" Pine tree.
3. 290° 5.37'. Set PK Nail and Trav. Pt. Disc (LB 642) in N. face of fence post.

Section 36

Section 31

E. 1/4 Cor. Sec.36, Twp.41S., Rge.27E.
 Found 4" Round Concrete Monument with Disc, stamped (E. 1/4 36-41-27).

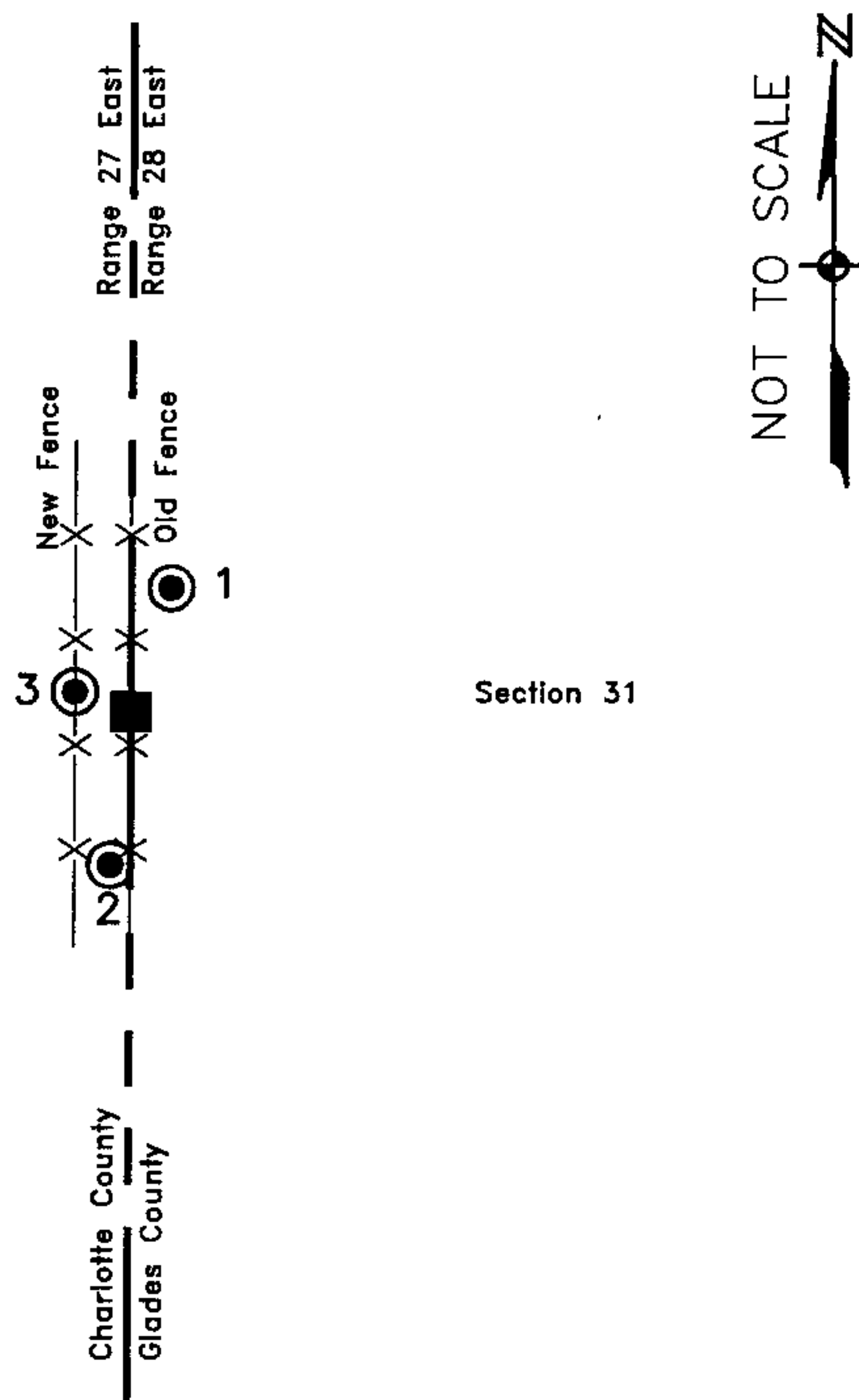

Field Book: LB-31, Page 21

SURVEYORS CERTIFICATE:

I certify the monument and accessories indicated above were field located on August 19, 2005

[Signature]
 SIGNATURE
Johnson Engineering, Inc.
 FIRM OR AGENCY
251 West Hickorychee (SR80)
 ADDRESS
La Belle Florida 33935
 CITY STATE ZIP
(863) 612-0597 October 31, 2005
 PHONE NUMBER DATE

SEND ORIGINAL TO:
 Department of Environmental Protection
 Bureau of Surveying and Mapping
 3900 Commonwealth Boulevard
 Mail Station 105
 Tallahassee, Florida 32399

DEP. USE ONLY
 Processed: 11-13-06 MIB
 B.L.M. - I.D. 700140
 QUAD - I.D. 2313 Telegraph Swamp SE

EMBOSSSED SEAL OVER SIGNATURE