

# FLORIDA DEPARTMENT OF ENVIRONMENTAL PROTECTION CERTIFIED CORNER RECORD

DOC. # 089354

**CORNER DESCRIPTION:** MONUMENTATION DESCRIPTION (EVIDENCE FOUND OR METHOD TO SET)

Depict corner with  P-25

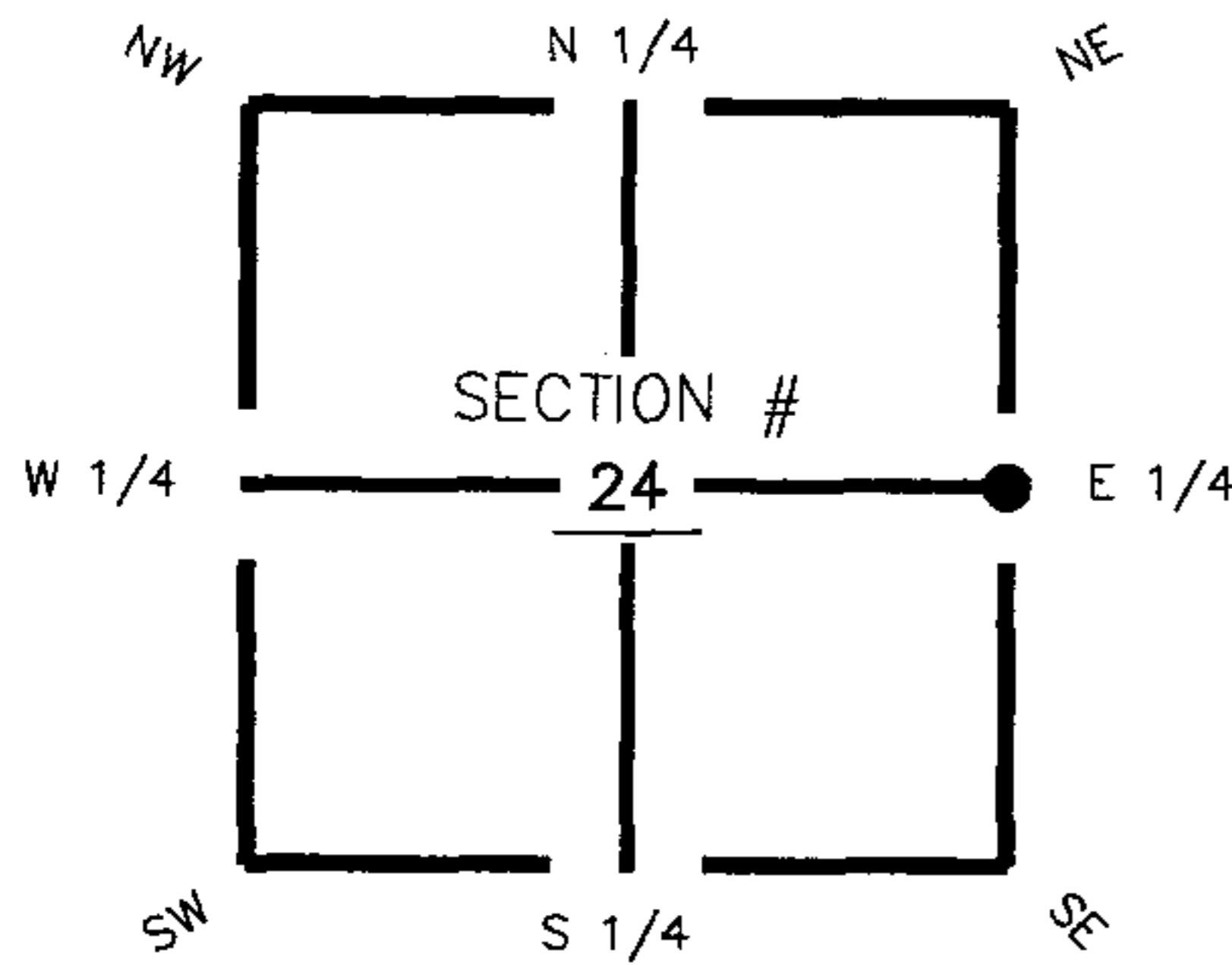

Found 4" Round Concrete Monument with Disc, stamped (E. 1/4 24-41-27)

**HORIZONTAL POSITION INFORMATION ( if determined ):**

Latitude 26° 53' 36.14561" N Longitude 81° 33' 48.21705" W  
 Y(NORTHING-Ft.) 930657.68 X(EASTING-Ft.) 798468.92 Zone FL83-WF  
 Convergence 0° 11' 50.97817" Scale factor 0.999964393  
 Coordinate determination (circle one): Field traverse  GPS  
 Horizontal datum (circle one): NAD27 NAD83(1986)  NAD83(1999) other (explain)  
 Accuracy (circle one): 1st  2nd 3rd other \_\_\_\_\_

E 1/4 corner of Section 24  
 Twp. 41 South, Rge 27 East  
 Tallahassee Base Meridian,  
Charlotte County(s), Florida

1. 342° 3.83'. Set PK Nail and Trav. Pt. Disc (LB 642) in W. face of 3" Pine tree.
2. 195° 8.94'. Set PK Nail and Trav. Pt. Disc (LB 642) in E. face of 6" Pine tree.
3. 319° 52.10'. Set PK Nail and Trav. Pt. Disc (LB 642) in S. face of 15" Pine tree.

E. 1/4 Cor. Sec. 24, Twp. 41S., Rge. 27E.  
 Found 4" Round Concrete Monument with Disc, stamped (E. 1/4 24-41-27).

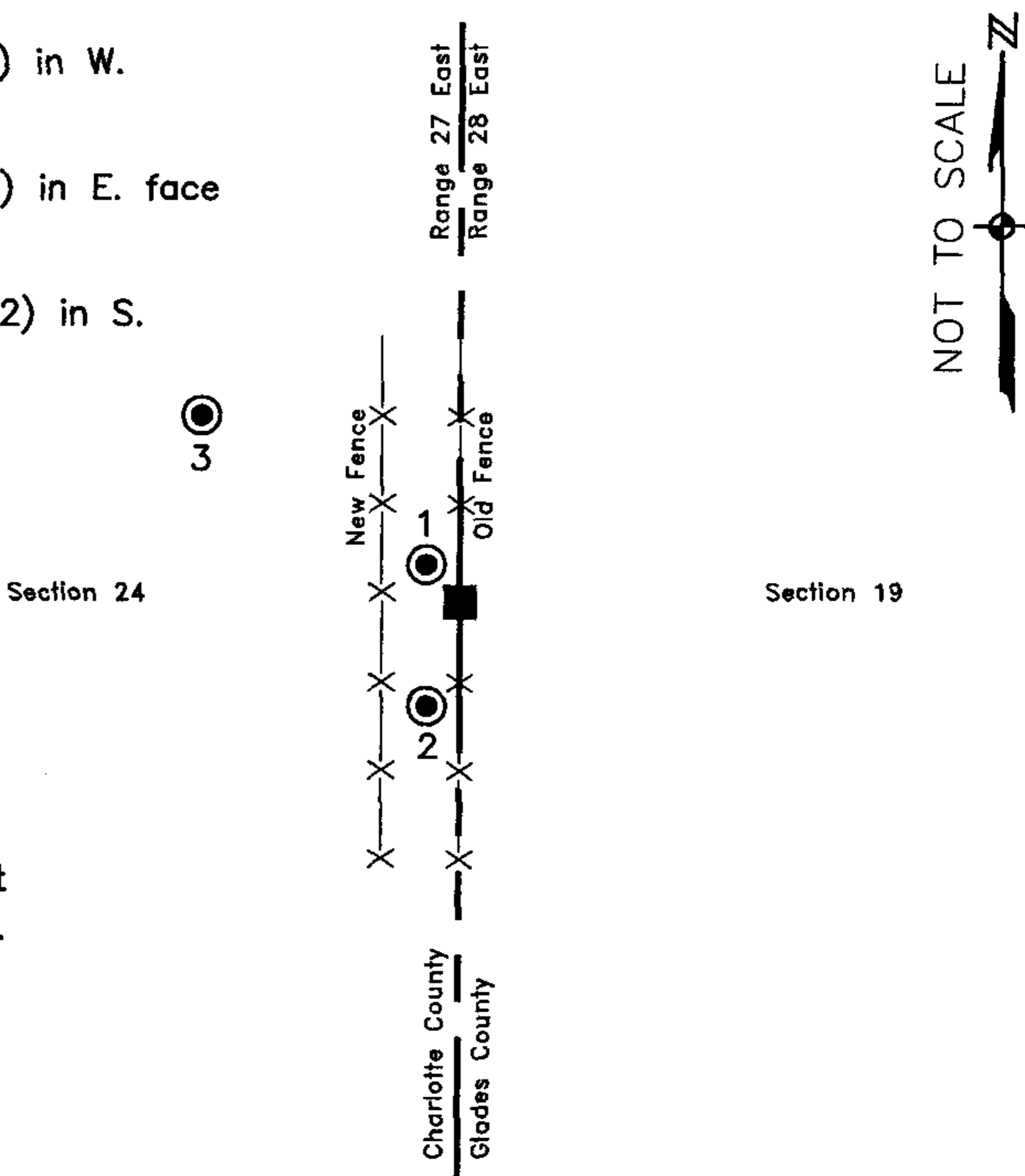

Field Book: LB-31, Page 26

**SURVEYORS CERTIFICATE:**

I certify the monument and accessories indicated above were field located on August 22, 2005

*[Signature]* 4912  
 SIGNATURE PSM NO.  
 Johnson Engineering, Inc. 642  
 FIRM OR AGENCY LB NO.  
 251 West Hickpochee (SR80) ADDRESS  
 La Belle Florida 33935  
 CITY STATE ZIP  
 (863) 612-0594 October 28, 2005  
 PHONE NUMBER DATE

EMBOSSSED SEAL OVER SIGNATURE

SEND ORIGINAL TO:  
 Department of Environmental Protection  
 Bureau of Surveying and Mapping  
 3900 Commonwealth Boulevard  
 Mail Station 105  
 Tallahassee, Florida 32399

D.E.P. USE ONLY

Processed: 11-13-06 YMB  
 B.L.M. - I.D. 100340  
 QUAD - I.D. 2413 Telegraph Swamp NE