

FLORIDA DEPARTMENT OF NATURAL RESOURCES  
CERTIFIED CORNER RECORD

J25

CORNER DESCRIPTION:

S. E. corner of Section 12 ,  
Twp 42 S , Rge 20 E ,  
Tallahassee Base Meridian,  
CHARLOTTE County(s), Florida.

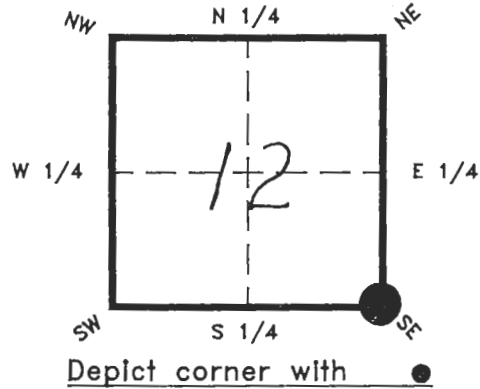

MONUMENTATION DESCRIPTION:

Describe original monument and accessories, or subsequent restoration. Give sources of information. (If no attempt was made to search for the original monument and accessories, this information is not necessary.)

Description of corner evidence found:

4" x 4" CONCRETE MONUMENT WITH 1/2" IRON PIN  
NO I. D.

State method(s) to determine corner location (lost corners only):

HORIZONTAL POSITION INFORMATION ( If determined ):

Latitude \_\_\_\_\_ Longitude \_\_\_\_\_  
Y(Northing) \_\_\_\_\_ X(Easting) \_\_\_\_\_ Zone \_\_\_\_\_  
Convergence \_\_\_\_\_ Scale factor \_\_\_\_\_

Coordinate determination (circle one):      Field traverse      GPS  
Horizontal datum (circle one):    NAD27    NAD83(1986)    NAD83(1990)    other (explain)

Order of accuracy as defined in "Standards and Specifications for Geodetic Control Networks" published by the Federal Geodetic Control Committee (circle one):  
1st, 2nd, (3rd), class II ,

or Minimum Technical Standards (Chapter 21HH-6, F.A.C.) ratio of closure for field data (example 1:10,000), \_\_\_\_\_ . This does not specify an order of accuracy.

Control point(s) used for survey:

Comments: THIS RECORD FILED TO CORRECT DOCUMENT #064917, WHICH CITED THE TOWNSHIP AS 41S, AND CORRECTED HERE AS 42S.

SKETCH:

ALL DISKS ARE STAMPED

"S.M.T. L.B. 6627"

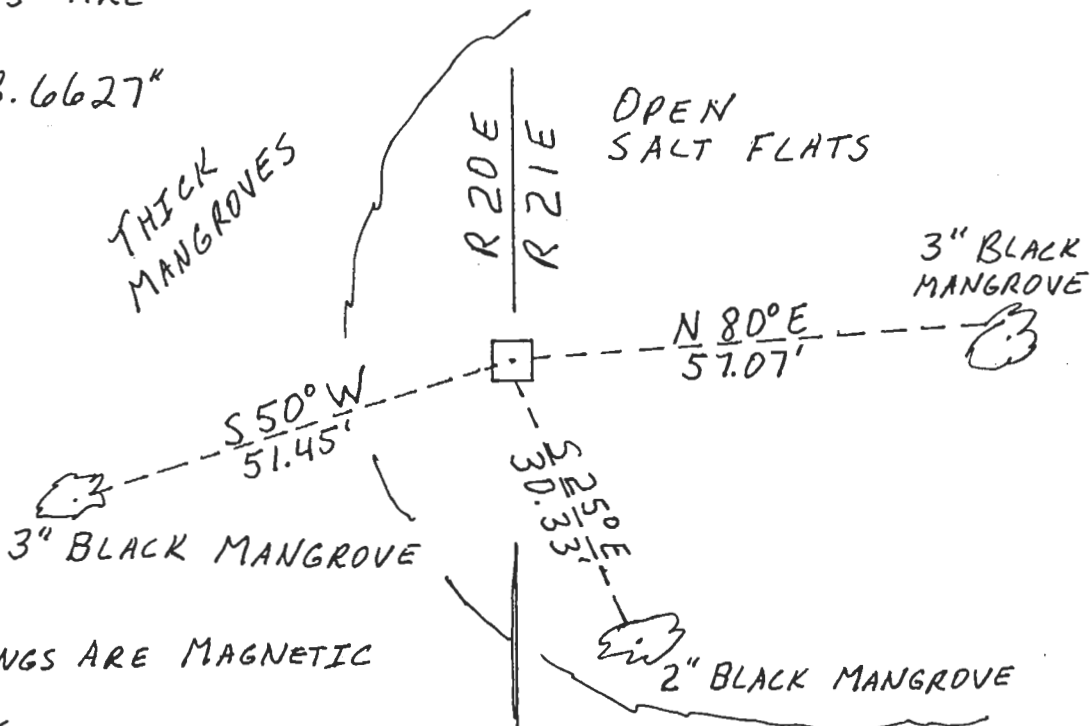

ALL BEARINGS ARE MAGNETIC

NOT TO SCALE \*\* PLEASE COMPLETE IN BLACK INK OR TYPE \*\*

All bearings and distances must be from the corner to the witness. Indicate whether corner was found, set, or replaced and show north arrow.

REFERENCE MEASUREMENTS ( at least three vicinity references must be given below even if they appear on the above sketch ):

Description	Bearing	Distance
SET P.K. & DISK 3" BLACK MANGROVE	N 80° E	57.07'
SET P.K. & DISK 2" BLACK MANGROVE	S 25° E	30.33'
SET P.K. & DISK 3" BLACK MANGROVE	S 50° W	51.45'

SURVEYORS CERTIFICATE: I certify the monument and accessories indicated above were field located on June 26, 19 1999.

James S. Richmond 4118  
SIGNATURE 9-28-99 PLS NO.

DATE  
9-28-99

Southern Mapping Technology inc. LB 6627  
FIRM OR AGENCY L.B. NO.

4376 Corporate Square - No 1  
ADDRESS

Naples FL. 34104 - Ph. 941 6432911  
CITY STATE

475  
PLACIDA



SEND TO:

Department of Natural Resources  
Bureau of Survey and Mapping  
3900 Commonwealth Boulevard  
Mall Station 105  
Tallahassee, Florida 32399

DNR 53-001(16)  
REV. 7/16/92  
PAGE 2 OF 2

Completeness checked by: Mr  
Accepted and filed: 11-1-99  
B.L.M. - I.D. 700500 Date  
D.N.R. USE ONLY