

FLORIDA DEPARTMENT OF NATURAL RESOURCES
CERTIFIED CORNER RECORD

CORNER DESCRIPTION:

N.W. corner of Section 6,
Twp 42 S, Rge 21 E,
Tallahassee Base Meridian,
CHARLOTTE County(s), Florida.

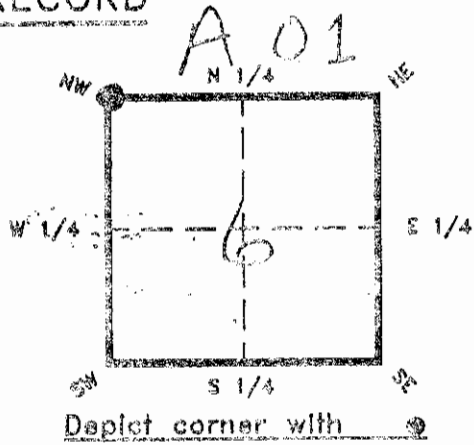

MONUMENTATION DESCRIPTION:

Describe original monument and accessories, or subsequent restoration. Give sources of information. (If no attempt was made to search for the original monument and accessories, this information is not necessary.)

A 1/4 L.W.P. FOUND & REPLACED WITH CHARLOTTE COUNTY SURVEY MONUMENT BY CHARLOTTE COUNTY SURVEY DEPT.

Description of corner evidence found:

CHARLOTTE COUNTY SURVEY MONUMENT

RECEIVED

JAN 27 1994

State method(s) to determine corner location (lost corners only):

HORIZONTAL POSITION INFORMATION (If determined):

SURVEY & MAPPING

Latitude 26° 51' 26.187" Longitude 082° 15' 21.426"

Y(Northing) 217374.445 X(Easting) 572718.687 Zone 0902

Convergence (-)00'06"56.27 Scale factor 0.99974916

Coordinate determination (circle one): Field traverse GPS

Horizontal datum (circle one): NAD27 NAD83(1986) NAD83(1990) other (explain)

Order of accuracy as defined in "Standards and Specifications for Geodetic Control Networks" published by the Federal Geodetic Control Committee (circle one):
1st, 2nd, 3rd, class _____

or Minimum Technical Standards (Chapter 21HH-8, F.A.C.) ratio of closure for field data (example 1:10,000), _____ . This does not specify an order of accuracy.

Control point(s) used for survey:

Comments: HORIZONTAL POSITION INFORMATION FURNISHED BY CHARLOTTE COUNTY SURVEY DEPT. FILE # 4120 B

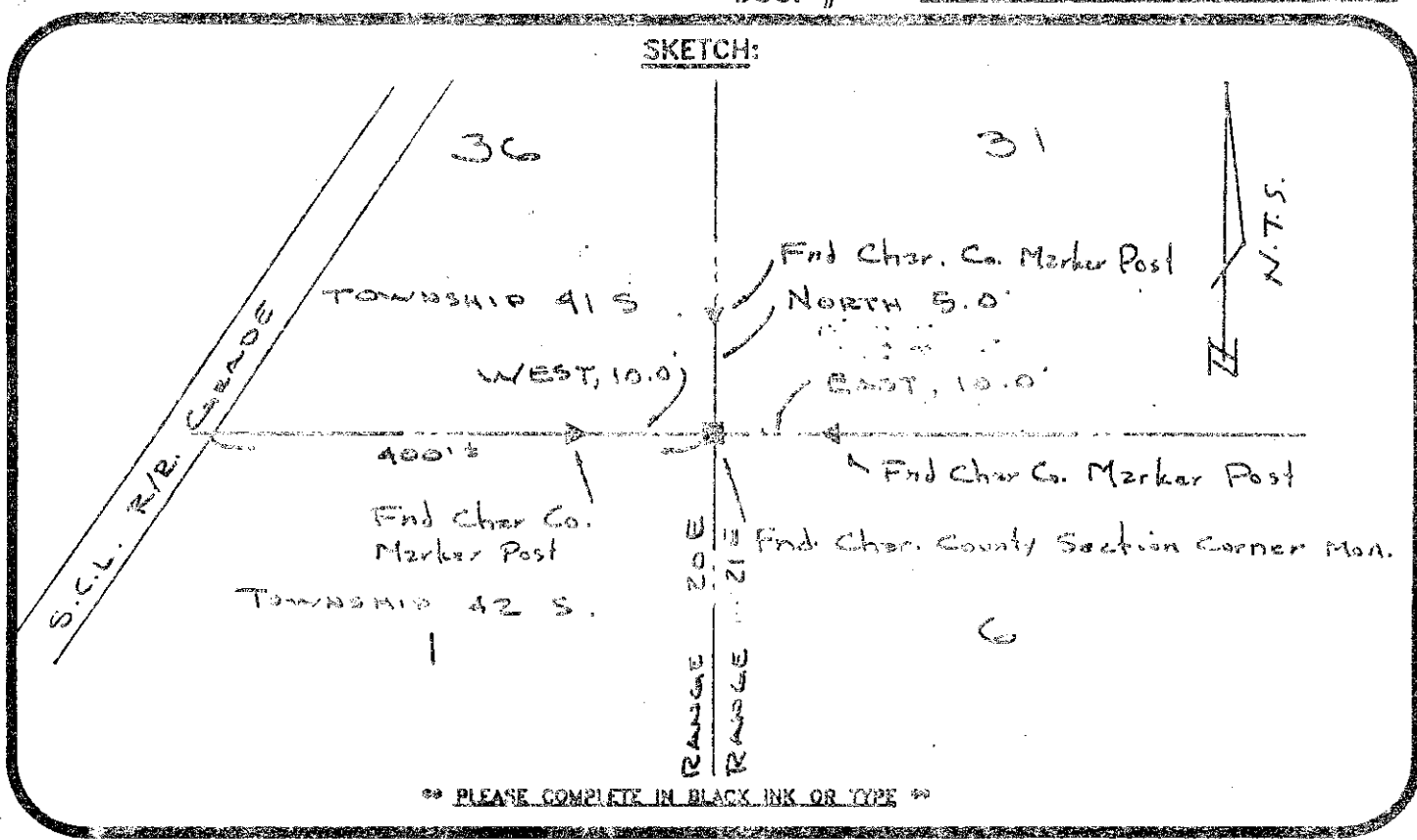

All bearings and distances must be from the corner to the witness. Indicate whether corner was found, set, or replaced and show north arrow.

REFERENCE MEASUREMENTS (at least three vicinity references must be given below even if they appear on the above sketch): COMPASS MAGNETIC BEARINGS

Description	Bearing	Distance
CHAR. CO. MARKER POST	NORTH	5.0'
CHAR. CO. MARKER POST	WEST	10.0'
CHAR. CO. MARKER POST	EAST	10.0'

SURVEYORS CERTIFICATE: I certify the monument and accessories indicated above were field located on JUNE 7, 1993.

G. J. [Signature] 3361
EXPIRES PLS NO.
December 15, 1993
DATE
LANDMARK LAND Consultants 4689
FIRM OR AGENCY LA. NO.
4326 N. Access Rd
ADDRESS
Englewood FL 34223
CITY STATE

475



SEND TO:

Department of Natural Resources
 Bureau of Survey and Mapping
 3900 Commonwealth Boulevard
 Mail Station 105
 Tallahassee, Florida 32399

DNR 53-001(18)
 REV. 7/15/92
 PAGE 2 OF 2

Completeness checked by: B. Hunter
 Accepted and filed: 2-1-94
 B.L.M. - I.D. 01363106 Date 2-1-94
D.N.R. USE ONLY