

FLORIDA DEPARTMENT OF NATURAL RESOURCES
CERTIFIED CORNER RECORD

CORNER DESCRIPTION:

N.E. corner of Section 2,
Twp 42S, Rge 21E,
Tallahassee Base Meridian,
CHARLOTTE County(s), Florida.

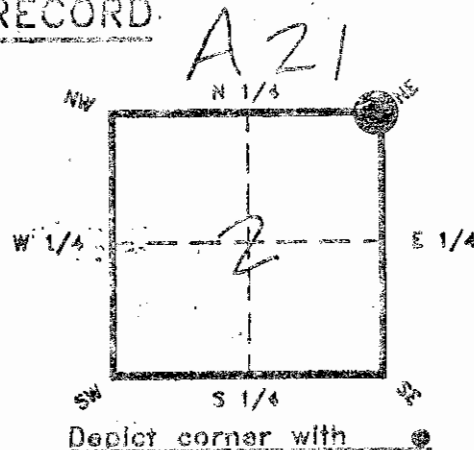

MONUMENTATION DESCRIPTION:

Describe original monument and accessories, or subsequent restoration. Give sources of information. (If no attempt was made to search for the original monument and accessories, this information is not necessary.)

FND. 4"x4" C.M.

RECEIVED

JAN 27 1994

Description of corner evidence found:

SURVEY & MAPPING

State method(s) to determine corner location (lost corners only):

HORIZONTAL POSITION INFORMATION (if determined):

Latitude 26° 51' 27.320" Longitude 82° 10' 29.544"
Y(Northing) 279636.909 X(Easting) 500192.903 Zone 0202
Convergence (-)00° 04' 44.412 Scale factor 0.99994490

Coordinate determination (circle one): Field traverse GPS

Horizontal datum (circle one): NAD27 NAD33(1986) NAD83(1990) other (explain)

Order of accuracy as defined in "Standards and Specifications for Geodetic Control Networks" published by the Federal Geodetic Control Committee (circle one):
1st, 2nd, 3rd, class _____

or Minimum Technical Standards (Chapter 21HH-6, F.A.C.) ratio of closure for field data (example 1:10,000), _____ . This does not specify an order of accuracy.

Control point(s) used for survey:

Comments:

GPS - Control furnished by Charlotte Co. Survey Dept

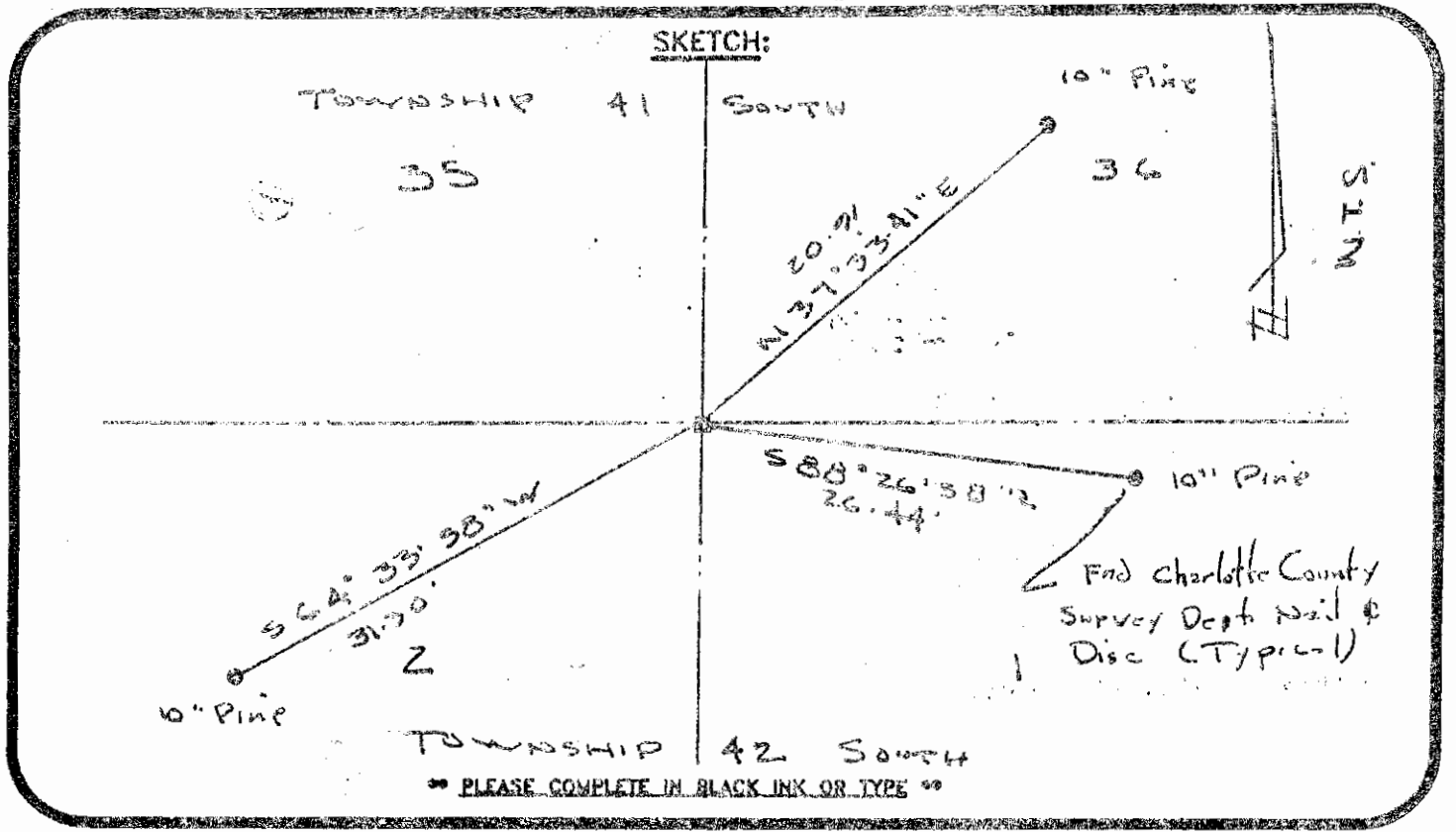

All bearings and distances must be from the corner to the witness. Indicate whether corner was found, set, or replaced and show north arrow.

REFERENCE MEASUREMENTS (at least three vicinity references must be given below even if they appear on the above sketch): **MAGNETIC BEARINGS**

Description	Bearing	Distance
Find Charlotte County Survey Dept Nail & Disc in 10" Pine	S. 88° 26' 58" E	26.44'
in 10" Pine	N. 37° 33' 41" E	20.91'
in 10" Pine	S. 64° 33' 58" W	31.30'

SURVEYORS CERTIFICATE: I certify the monument and accessories indicated above were field located on June 11, 1993.

[Signature] 3361
SIGNATURE PLS NO.

1-11-93
DATE

Landmark Land Consultants L.R. 4689
FIRM OR AGENCY L.R. NO.

4526 N. Access Road
ADDRESS

Englewood, Florida 34224
CITY STATE ZIP

474



Completeness checked by: [Signature]
 Accepted and filed: [Signature]
 B.L.M. - I.D. 07-353601 Date 2-2-94
D.N.R. USE ONLY

SEND TO:
 Department of Natural Resources
 Bureau of Survey and Mapping
 3900 Commonwealth Boulevard
 Mail Station 103
 Tallahassee, Florida 32399

DNR 53-001(16)
 REV. 7/16/92
 PAGE 2 OF 2