

FLORIDA DEPARTMENT OF NATURAL RESOURCES
CERTIFIED CORNER RECORD

CORNER DESCRIPTION:

S.E. corner of Section 9,
Twp 42 S, Rge 21 E,
Tallahassee Base Meridian,
CHARLOTTE County(s), Florida.

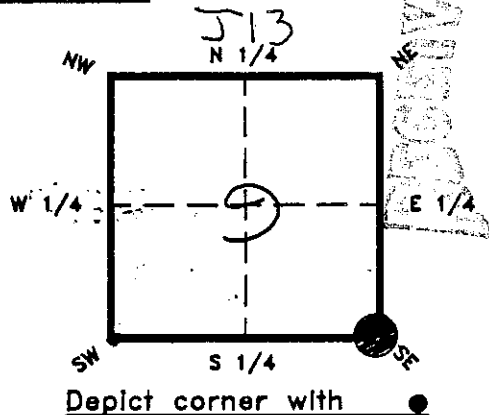

MONUMENTATION DESCRIPTION:

Describe original monument and accessories, or subsequent restoration. Give sources of information. (If no attempt was made to search for the original monument and accessories, this information is not necessary.)

Description of corner evidence found:

Find 3/4" I.P. driven into 4"X4" L.W.P. in open water in Creek

State method(s) to determine corner location (lost corners only):

RECEIVED
JAN 10 1994
SURVEY & MAPPING

HORIZONTAL POSITION INFORMATION (if determined):

Latitude 26° 47' 41.617 Longitude 82° 12' 25.515
276388.586 179415.220
Y(Northing) 906786.70 X(Easting) 588632.61 Zone 0902
Convergence (-)00° 05' 36.46 Scale factor 0.99994641

Coordinate determination (circle one):

Field traverse GPS

Horizontal datum (circle one):

NAD27 NAD83(1986) NAD83(1990) other (explain)

Order of accuracy as defined in "Standards and Specifications for Geodetic Control Networks" published by the Federal Geodetic Control Committee (circle one):

1st, 2nd, 3rd, class _____

or Minimum Technical Standards (Chapter 21HH-6, F.A.C.) ratio of closure for field data (example 1:10,000), 1:28,100. This does not specify an order of accuracy.

Control point(s) used for survey:

G.P.S. BASE LINE CONTROL BASED ON NORTH LINE SECTION 9
N.E. & N.W. CORNER COORD. FURNISHED BY CHARLOTTE COUNTY SURVEY DEPT
Comments:

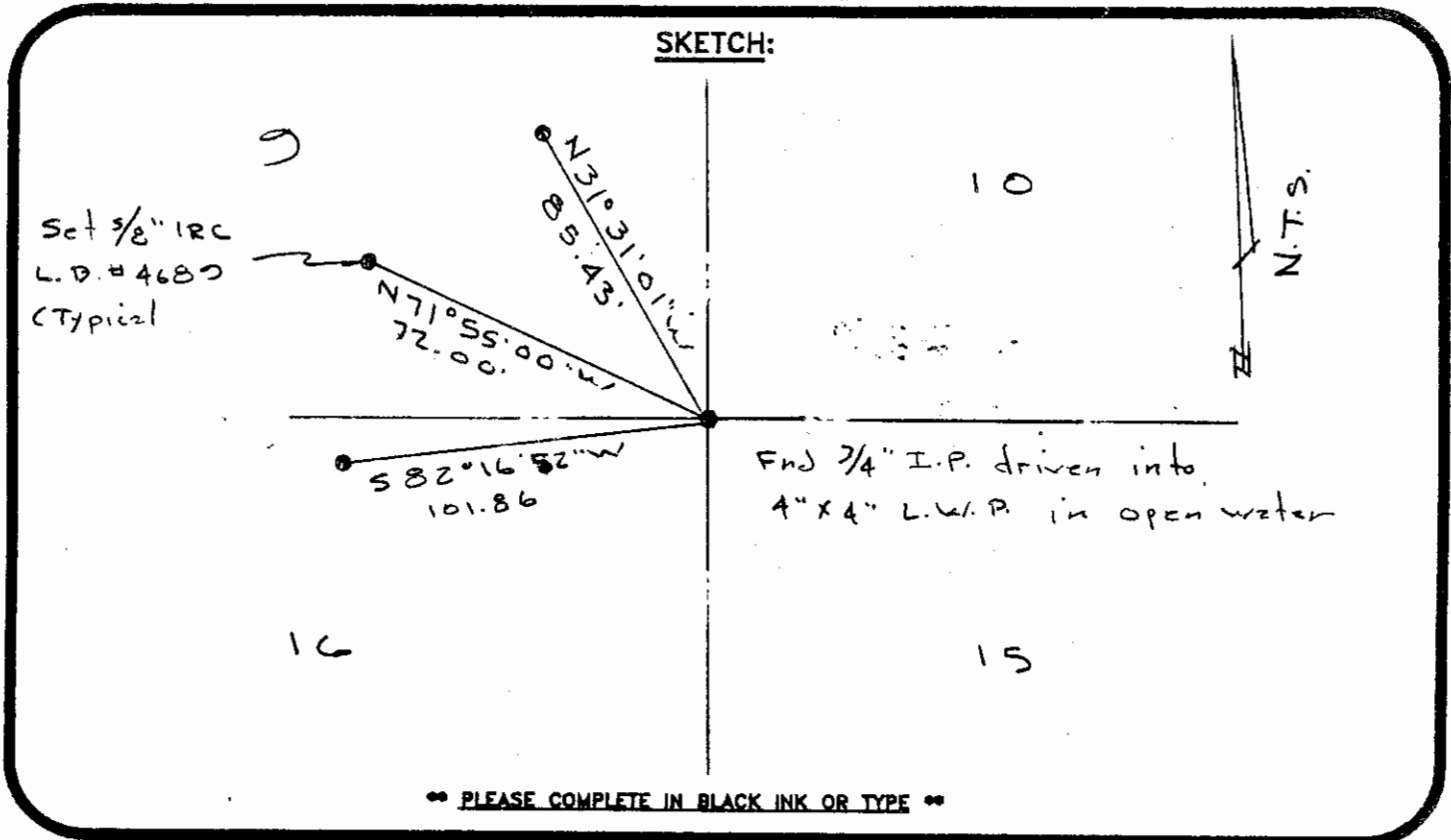

** PLEASE COMPLETE IN BLACK INK OR TYPE **

All bearings and distances must be from the corner to the witness. Indicate whether corner was found, set, or replaced and show north arrow.

REFERENCE MEASUREMENTS (at least three vicinity references must be given below even if they appear on the above sketch):

Description	Bearing	Distance
Set 5/8" I.R.C. L.B. # 4689	S 82° 16' 52" W	101.86
"	N 31° 31' 01" W	85.43
"	N 71° 55' 00" W	72.00

SURVEYORS CERTIFICATE: I certify the monument and accessories indicated above were field located on June 8, 1993.

SIGNATURE: [Signature] PLS. NO. 3361
 DATE: 1-4-94
 FIRM OR AGENCY: Landmark Land Consultants L.B. 4689
 ADDRESS: 4526 N. Access Road
Englewood, Florida 34224
 CITY STATE

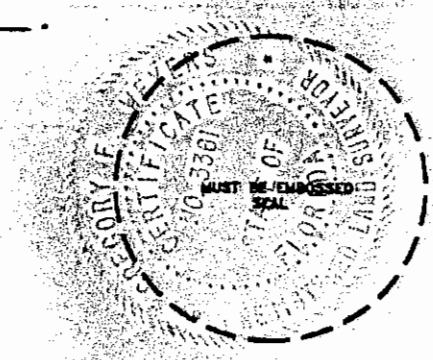

474

Completeness checked by: GJC
 Accepted and filed: 2-1-94 Date
 B.L.M. - I.D. 16091615 D.N.R. USE ONLY

SEND TO:

Department of Natural Resources
 Bureau of Survey and Mapping
 3900 Commonwealth Boulevard
 Mail Station 105
 Tallahassee, Florida 32399

DNR 53-001(16)
 REV. 7/16/92
 PAGE 2 OF 2