

FLORIDA DEPARTMENT OF NATURAL RESOURCES  
CERTIFIED CORNER RECORD

RECEIVED

JAN 18 1994

SURVEY & MAPPING

CORNER DESCRIPTION:

S.W. corner of Section 11,  
Twp 42 S, Rge 21 E,  
Tallahassee Base Meridian,  
CHARLOTTE County(s), Florida.

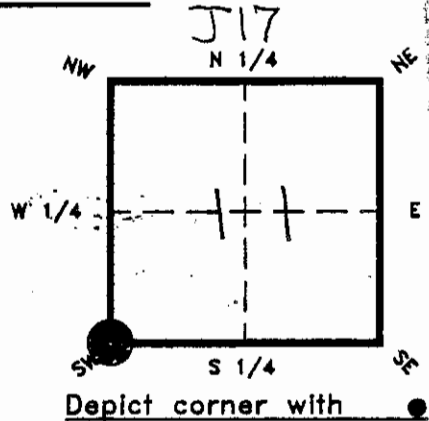

MONUMENTATION DESCRIPTION:

Describe original monument and accessories, or subsequent restoration. Give sources of information. (If no attempt was made to search for the original monument and accessories, this information is not necessary.)

Find 3" x 3" c.m. 0.3' below ground  
(L.W.P. 0.23' ± S. & 0.10' ± W. of c.m.)

Description of corner evidence found:

RECEIVED

JAN 10 1994

SURVEY & MAPPING

State method(s) to determine corner location (lost corners only):

HORIZONTAL POSITION INFORMATION (If determined):

Latitude 26° 49' 42.023 Longitude 82° 11' 26.734"  
276398.534 181038.263  
Y(Northing) 906817.337 X(Easting) 573257.556 Zone 0902  
Convergence -100° 05' 09.94 Scale factor 0.99994561

Coordinate determination (circle one): Field traverse GPS

Horizontal datum (circle one): NAD27 NAD83(1986) NAD83(1990) other (explain)

Order of accuracy as defined in "Standards and Specifications for Geodetic Control Networks" published by the Federal Geodetic Control Committee (circle one):  
1st, 2nd, 3rd, class \_\_\_\_\_

or Minimum Technical Standards (Chapter 21HH-6, F.A.C.) ratio of closure for field data (example 1:10,000), 1:36,000. This does not specify an order of accuracy.

Control point(s) used for survey:

N.W. Corner Sec. 10 & S.E. Corner Sec. 11  
Corner Coord. furnished by Charlotte County Survey Dept.

Comments:

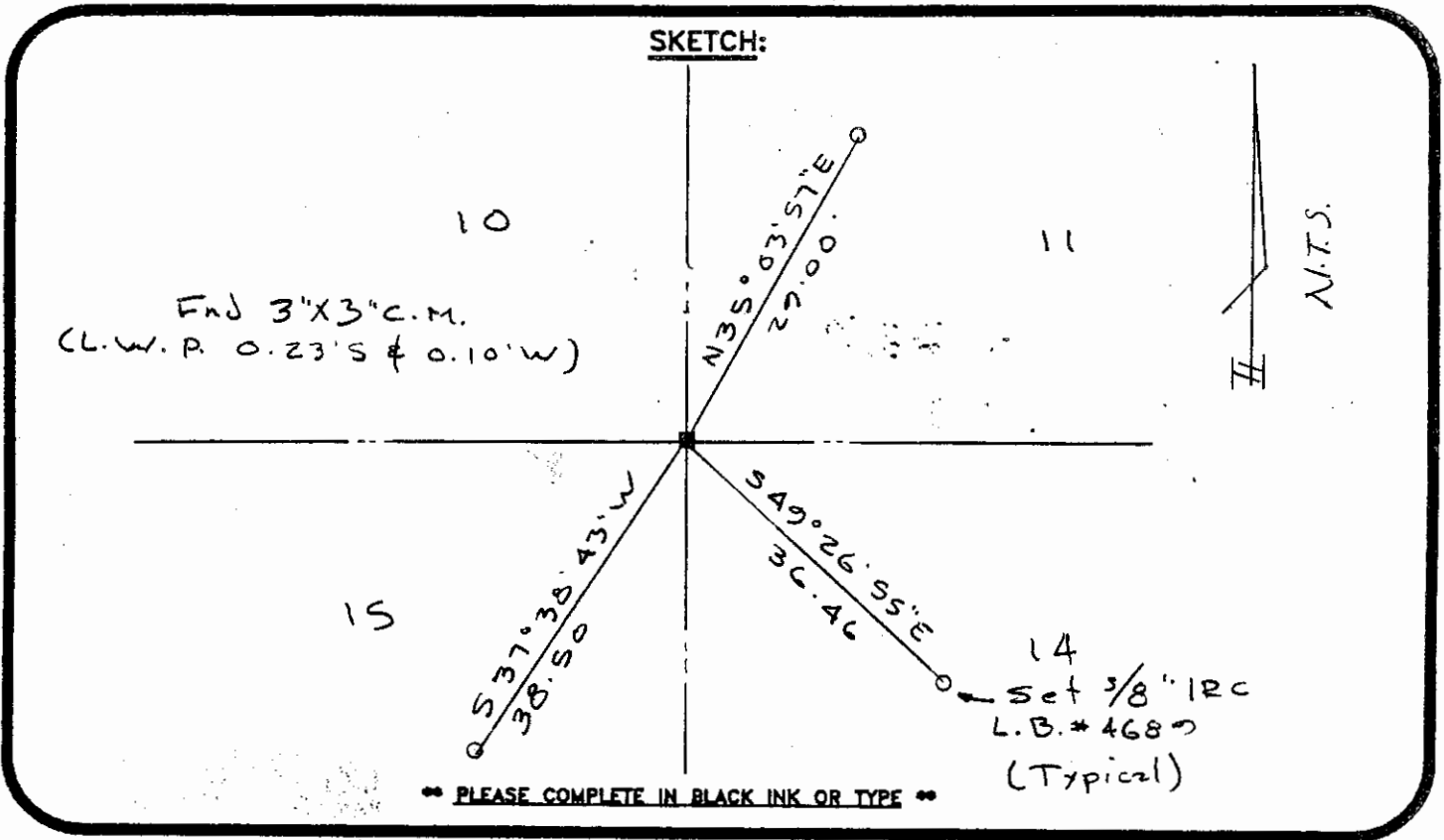

All bearings and distances must be from the corner to the witness. Indicate whether corner was found, set, or replaced and show north arrow.

**REFERENCE MEASUREMENTS** ( at least three vicinity references must be given below even if they appear on the above sketch ):

Description	Bearing	Distance
Set 5/8" IRC L.B. # 4689	N. 35° 03' 57" E	29.00'
"	S. 49° 26' 55" E	36.46'
"	S. 37° 38' 43" W	38.50'

**SURVEYORS CERTIFICATE:** I certify the monument and accessories indicated above were field located on June 10, 1993.

SIGNATURE: [Signature] PLS NO. 3361  
 DATE: 1-4-94  
 FIRM OR AGENCY: Landmark Land Consultants L.B. 4689  
 ADDRESS: 4526 N. Access Road  
 CITY: Englewood, Florida STATE: 34224

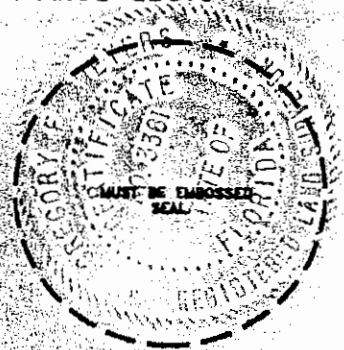

474

**SEND TO:**  
 Department of Natural Resources  
 Bureau of Survey and Mapping  
 3900 Commonwealth Boulevard  
 Mall Station 105  
 Tallahassee, Florida 32399

DNR 53-001(15)  
 REV. 7/16/92  
 PAGE 2 OF 2

Completeness checked by: CJC  
 Accepted and filed: 2-1-94  
 B.L.M. - I.D. 15101114 Date: \_\_\_\_\_  
 D.N.R. USE ONLY